

# Barley Mead

Maidenhead • Berkshire • SL6 3TE

Guide Price: £845,000



coopers  
est 1986

# Barley Mead

Maidenhead • Berkshire • SL6 3TE

\*NO CHAIN\*

A stunning detached family home in a desirable cul-de-sac boasting over 2000sq ft of living accommodation.

NO CHAIN

Detached

Immaculate condition

Two en-suites

Over 2000 sq ft

16ft integral garage

South facing garden

Driveway parking

Cul-de-sac location

Well regarded schools nearby

These particulars are intended as a guide and must not be relied upon as statements of fact. Your attention is drawn to the Important Notice on the last page.







### Property

This immaculate family home offers versatile accommodation with the ground floor benefitting from a generously sized living room, a modern kitchen with integrated appliances, separate dining room and a fully glazed conservatory. The first floor hosts the master bedroom which features an en-suite and built-in wardrobes. The three additional bedrooms share a contemporary family bathroom. The fifth bedroom is situated on the second floor with an en-suite bathroom and a home office.

### Outside

The home benefits from driveway parking to the front, a 16ft integral garage and a south facing garden to the rear with side access.

### Location

Barley Mead is a desirable quiet cul-de-sac with excellent schools nearby. There are local amenities a short walk away and lots of green areas for local walks. The location is perfect for access to the M40/M4/A404.





### Schools:

Cox Green School 0.4 miles  
Manor Green School 0.5 miles



### Train:

Maidenhead Station 1.7 miles  
Furze Platt Station 2.0 miles  
Cookham Station 3.4 miles



### Car:

M4, A40, M25, M40



### Council Tax Band:

G

(Distances are straight line measurements from centre of postcode)

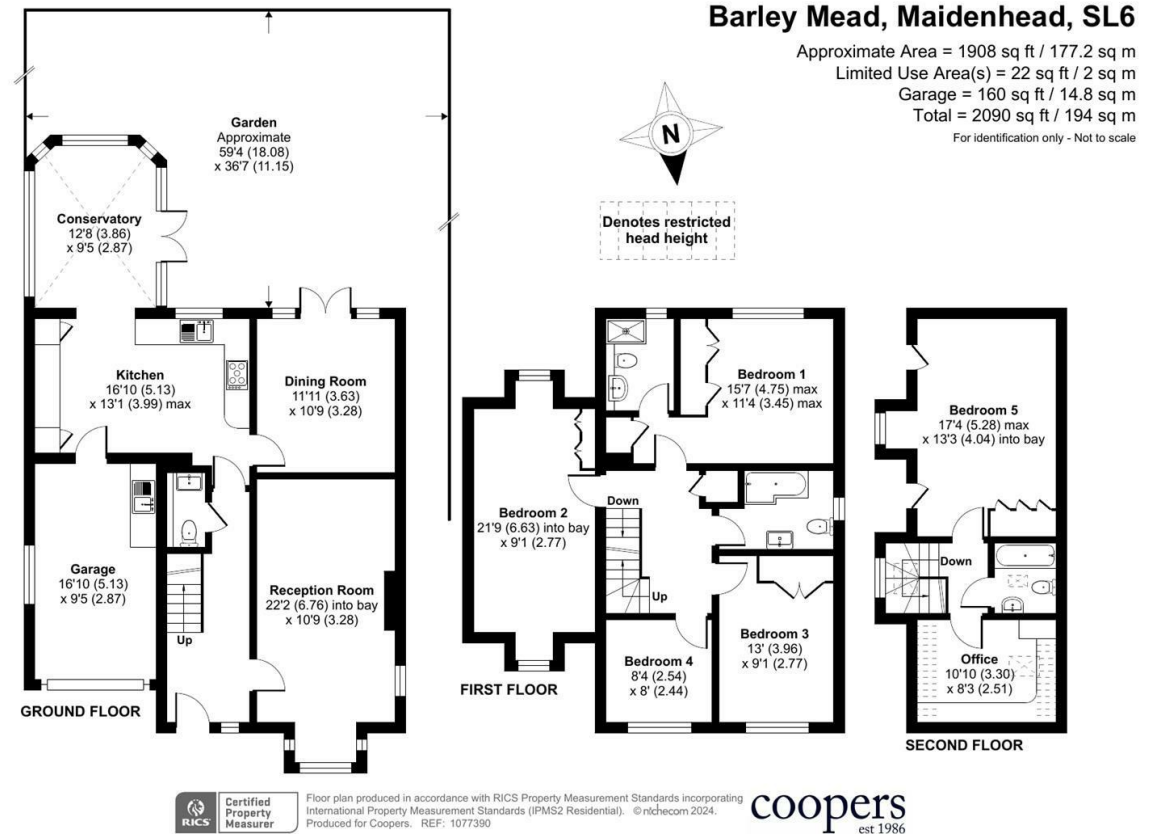

**coopers**  
est 1986

01628 232 550

42 Queen Street, Maidenhead,  
, SL6 1HZ

maidenhead@coopersresidential.co.uk

CoopersResidential.co.uk

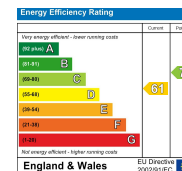

Important Notice: These particulars, whilst believed to be accurate are set out as a general outline only for guidance and do not constitute any part of an offer or contract. Intending purchasers should not rely on them as statements or representation of fact, but must satisfy themselves by inspection or otherwise has the authority to make or give any representation or warranty in respect of the property.