



## Woodside Lane, N12

£1,875 Per calendar month

Set within a popular building is this two double bedroom, first floor apartment. The property offers two bathrooms (one en-suite) and private parking behind security gates.

Located Close to Woodside Park Station (Northern Line) and all amenities on Whetstone High Road

### Features

- Two Bedrooms
- Two Bathrooms
- One Reception
- First Floor
- Gated parking
- Communal Gardens

# Woodside Lane, London, N12

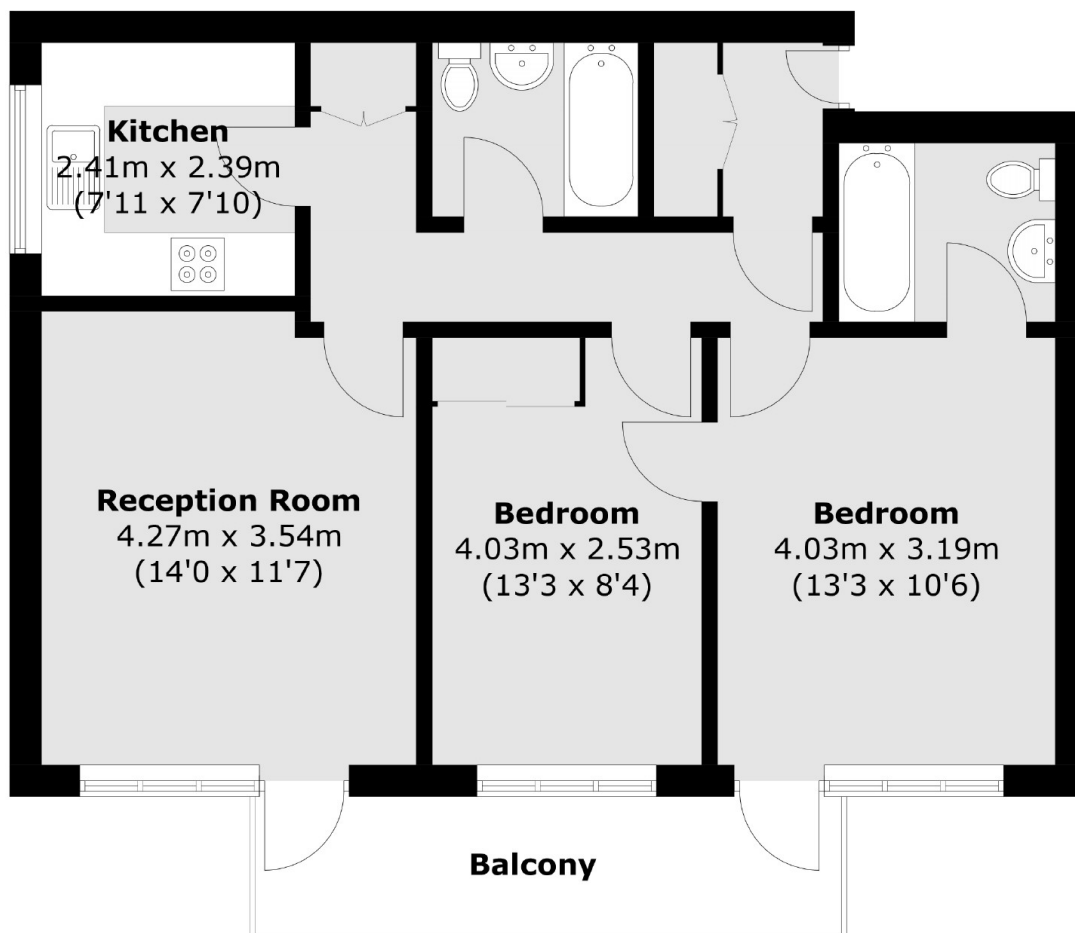

Total area (approx.): 64.0 sq. m (688.9 sq. ft)  
Balcony area (approx.): 7.2 sq. m (77.5 sq. ft)

## Dexters

Finchley  
126 Ballards Lane  
Finchley  
London  
Lettings  
020 8742 4181

Energy Rating: Barnet Council. We aim to make our particulars both accurate and reliable. However they are not guaranteed; nor do they form part of an offer or contract. If you require clarification on any points then please contact us, especially if you're traveling some distance to view. Please note that appliances and heating systems have not been tested and therefore no warranties can be given as to their good working order.

 **RICS** | Regulated  
Estate Agent  
and Letting Agent

[dexters.co.uk](https://www.dexters.co.uk)