



Regents Park Road, N3

£575,000

A spacious two bedroom apartment located near Finchley Central, featuring two bathrooms, a generous living and dining area, a private terrace, ample storage space, a lockable private garage and residents parking.

Embassy Lodge is conveniently located off Regents Park Road, offering easy access to the North Circular, local bus routes, and the Northern Line. It is also within the catchment area of highly regarded schools and within walking distance of places of worship.

Features

- Two Bedrooms
- Two Bathrooms
- Large Living Room
- Terrace
- Lockable Garage
- No Onward Chain

Regents Park Road, London, N3

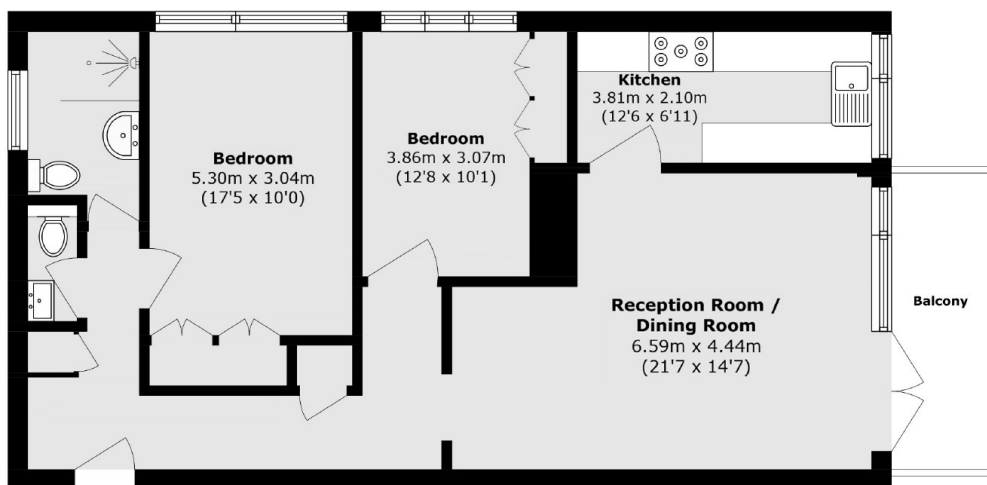

Total area (approx.): 82.9 sq. m (892.3 sq. ft)

Balcony area (approx.): 6.7 sq. m (72.1 sq. ft)