



## Courthouse Road, N12

£2,650 Per calendar month

This spacious three bedroom semi detached house offered unfurnished and in good decorative order. The property comprises two reception rooms with wood flooring, modern fitted kitchen, bathroom with separate wc, garage via shared drive and a well maintained garden.

Close to both Woodside Park and West Finchley Tube Stations and shopping facilities.

### Features

- Three Bedrooms
- Two Receptions
- Fitted kitchens
- Garage
- Garden
- Unfurnished

# Courthouse Road, London, N12

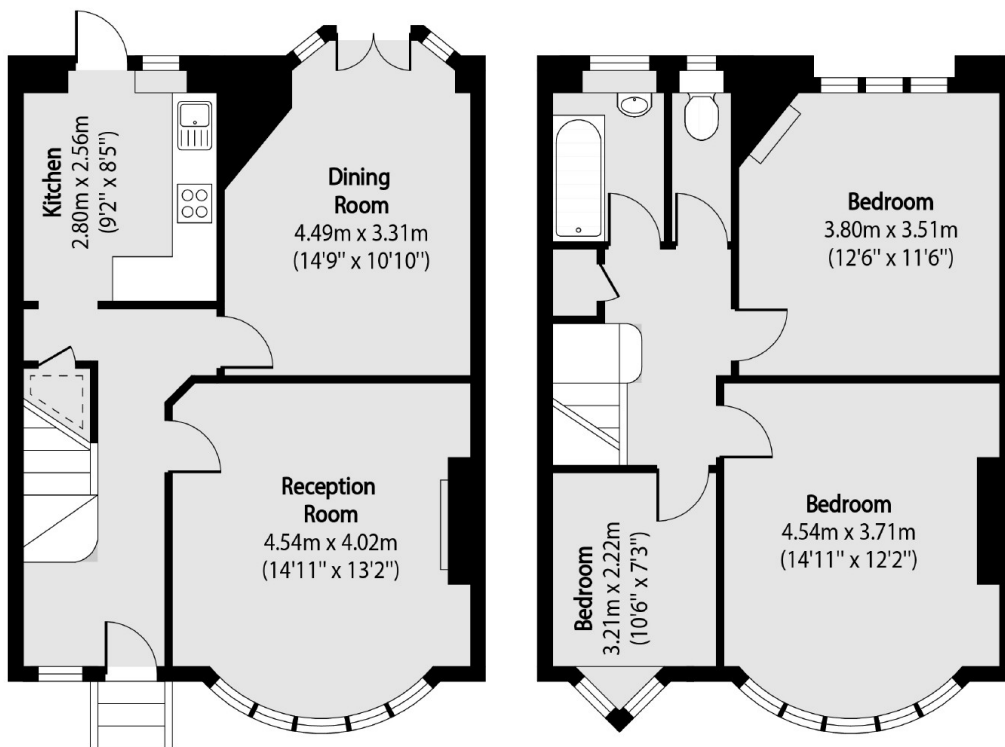

Ground Floor

First Floor

Total area (approx): 97.92 sq m (1054 sq. ft)