



Royal Drive, N11

£425,000

A lovely three bedroom, apartment in the ever-popular Princess Park development. The property comes complete with a bright and airy double bedroom with large sash windows and high-ceilings, a fully fitted kitchen, a family bathroom and residents parking.

Princess Park Manor has expansive shared green spaces, tennis courts, and a Nuffield Health gymnasium. It is conveniently located within a short walk of New Southgate overground and Arnos Grove underground stations.

Features

- Three Bedrooms
- Two Bathrooms
- Residential Parking
- High Ceilings
- Near Public Transport
- Large Communal Grounds

Royal Drive, London, N11

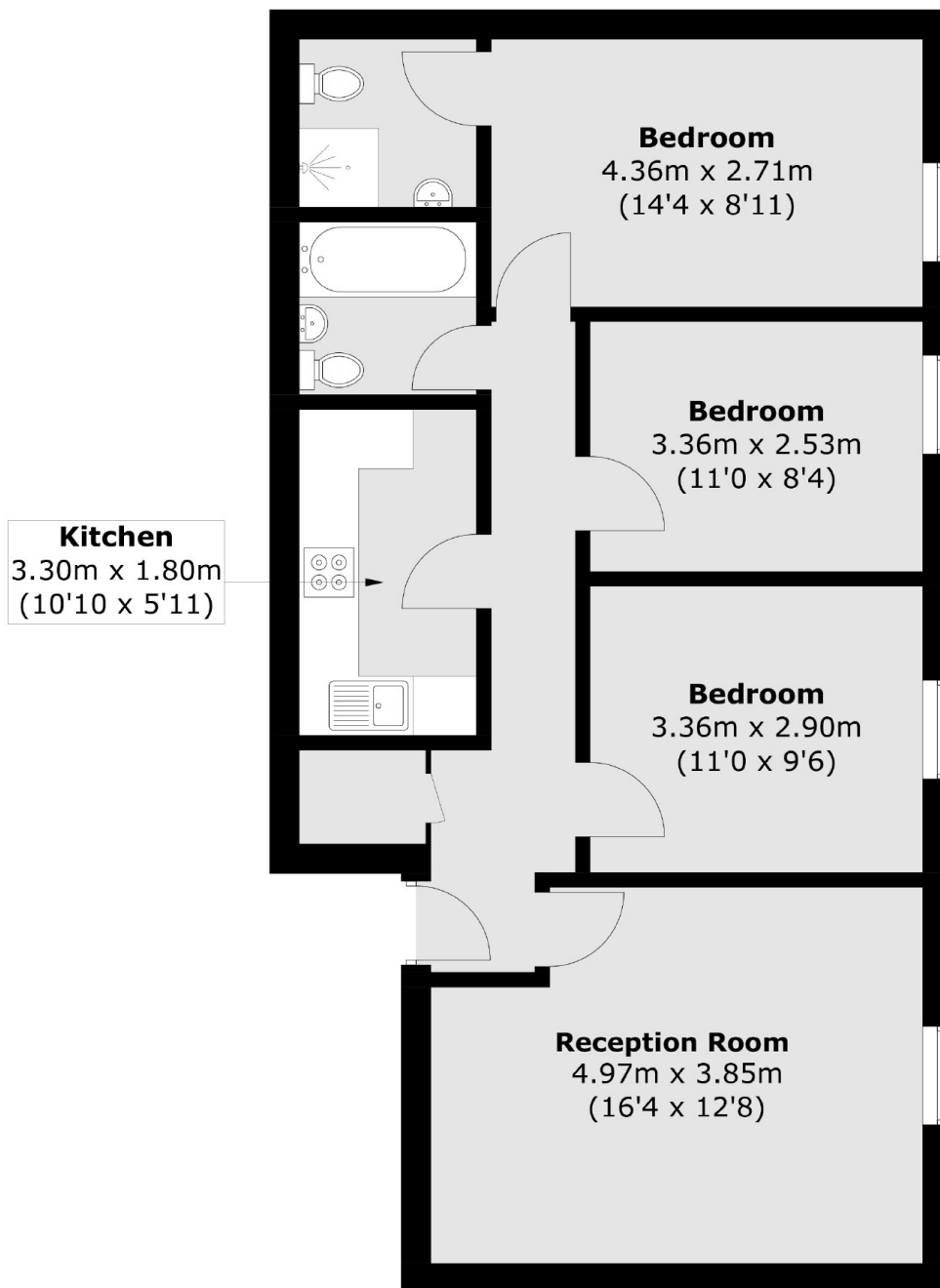

Total area (approx.): 72.6 sq. m (781.5 sq. ft)

Dexters

Finchley
126 Ballards Lane
Finchley
London
Sales
020 8742 4180

Energy Rating: C. We aim to make our particulars both accurate and reliable. However they are not guaranteed; nor do they form part of an offer or contract. If you require clarification on any points then please contact us, especially if you're traveling some distance to view. Please note that appliances and heating systems have not been tested and therefore no warranties can be given as to their good working order.

 **RICS** | Regulated
Estate Agent
and Letting Agent

[dexters.co.uk](https://www.dexters.co.uk)