



Gruneisen Road, N3

£400,000

Located within a modern apartment block, this spacious one-bedroom apartment offers an open-plan living room with a fully equipped kitchen, a private covered terrace accessible from both the reception room and bedroom, a family bathroom, storage cupboard, lift access, and a secure entry system.

Gruneisen Road is conveniently located just off Ballards Lane, providing easy access to a variety of restaurants, coffee shops, and retail outlets. Directly across from the apartment block is Victoria Park, and Finchley Central Tube station on the Northern Line is only a few minutes' walk away, making public transport highly accessible.

Features

- One Double Bedroom
- Private Terrace
- Family Bathroom
- Gated Entry
- Close to Public Transport
- Open Plan Living

Gruneisen Road,
London, N3

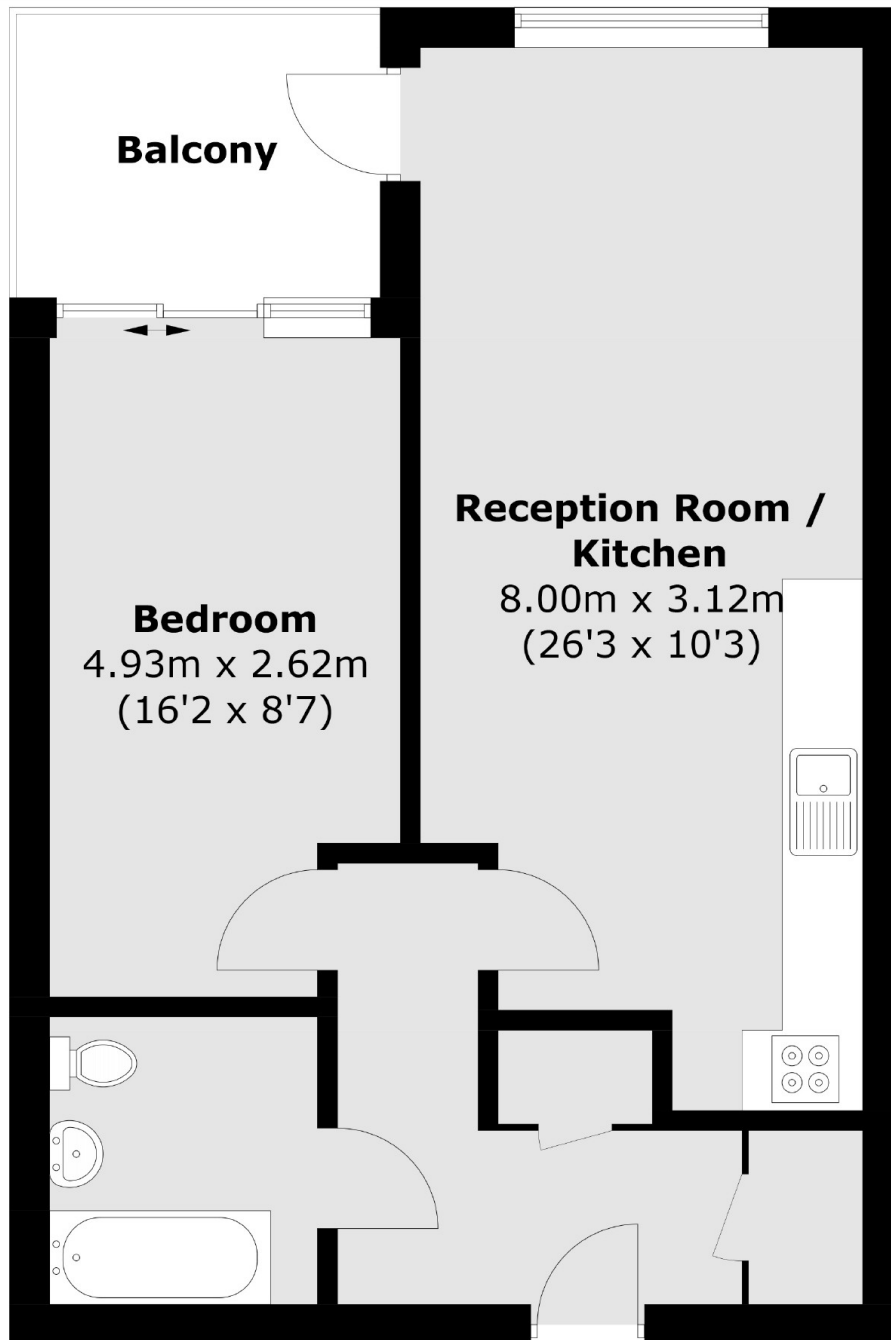

Total area (approx.): 51.5 sq. m (554.3 sq. ft)
Balcony (approx.): 5.9 sq. m (63.5 sq. ft)

Dexters

Finchley
126 Ballards Lane
Finchley
London
Sales
020 8742 4180

Energy Rating: B. We aim to make our particulars both accurate and reliable. However they are not guaranteed; nor do they form part of an offer or contract. If you require clarification on any points then please contact us, especially if you're traveling some distance to view. Please note that appliances and heating systems have not been tested and therefore no warranties can be given as to their good working order.

 **RICS** | Regulated
Estate Agent
and Letting Agent

dexters.co.uk