



## High Road, N20

£1,750 Per calendar month

Once a bank, now converted into secure luxury flats, this well-presented two bedroom flat can be found within this modern, lift assisted development. Comprised of open plan living, and an intercom system, this is a great opportunity to acquire a stylishly finished apartment.

Rivia House is situated a short distance from popular restaurants and cafés along with high end supermarkets such as Marks and Spencer and Waitrose. The property is a short walk away from Totteridge & Whetstone station, with easy access across London via the Northern Line.

### Features

- Two double bedrooms
- One Bathroom
- One Reception
- Allocated parking
- Video entry system
- Unfurnished

# High Road, London, N20

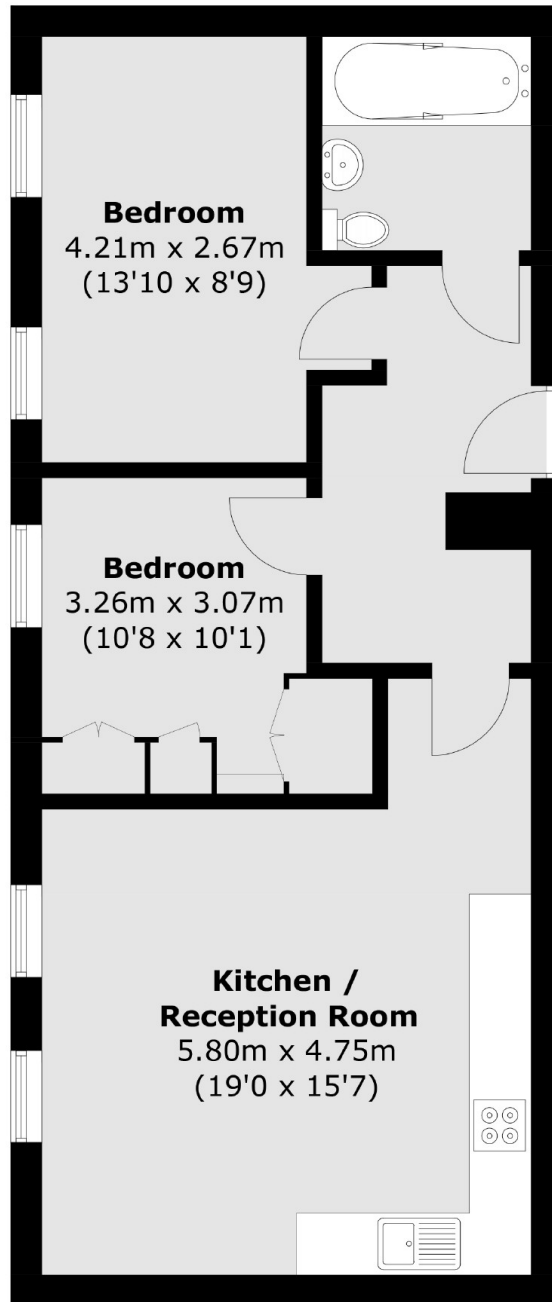

Total area (approx.): 57.3 sq. m (616.8 sq. ft)