



Nether Street, N3

£800,000

A three bedroom semi detached family home offering two reception rooms, kitchen with access to the large rear garden, small conservatory, bathroom with separate WC and potential to extend subject to planning permission.

Nether Street is ideally located within close proximity of Ballards Lane and Finchley Central, proving fantastic travel links across the capital and an abundance of amenities.

Features

- Three Bedrooms
- Two Receptions
- Kitchen
- On Street Parking
- No Chain
- Large Rear Garden

Nether Street, London, N3

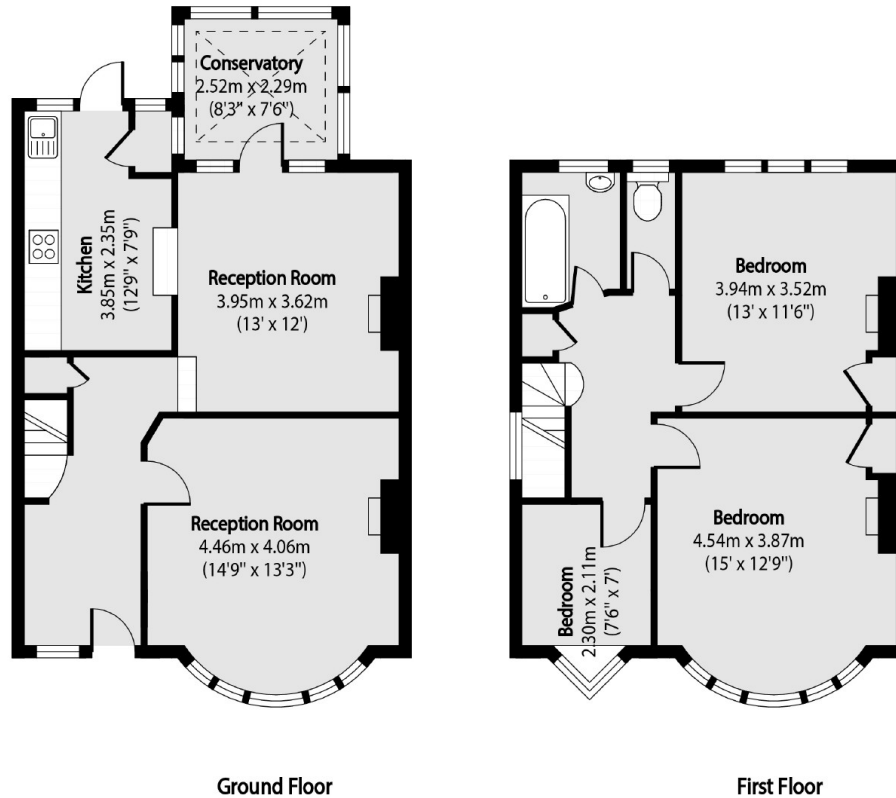

Total area (approx): 106.17 sq m (1143 sq. ft)