



Marsh Lane, NW7

£3,150 Per week

A large four bedroom semi-detached house situated on one of Mill Hill's premier roads. This property comprises of four bedrooms, family bathroom, spacious reception room, separate dining room with glass doors leading to the garden and a driveway with parking for three vehicles

The property is within walking distance to Mill Hill Broadway and conveniently located close to amenities in Mill Hill and Totteridge, with a selection of great schools nearby.

Features

- Four Bedrooms
- Utility Room
- Wooden Floors Throughout
- Ample Storage
- Private Garden
- Off Street Parking

Marsh Lane,
London, NW7

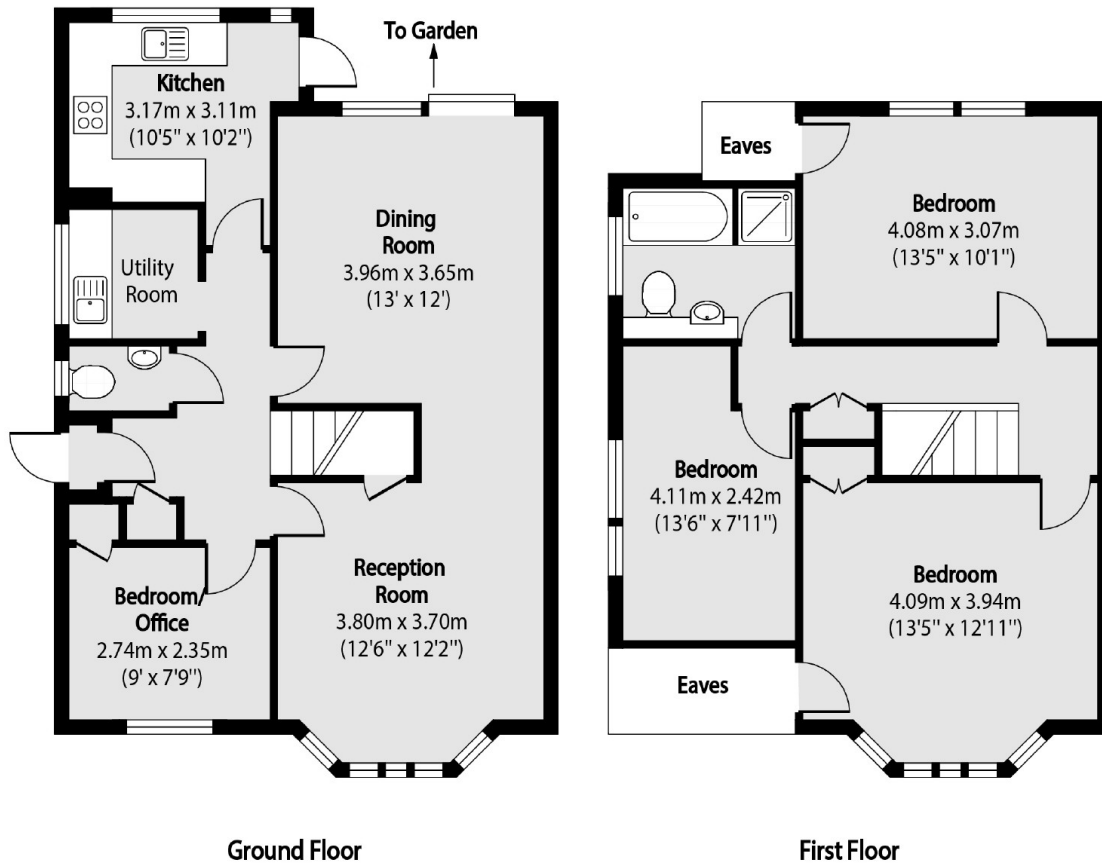

Total area (approx): 112.33 sq m (1209 sq. ft)
(Excluding Eaves)