



## Moss Hall Grove, N12

£675,000

A modern three bedroom end of terrace house ideally situated within close proximity of Finchley Central. This property comes complete with an open plan living and dining room, kitchen, downstairs WC, family bathroom and rear garden.

Moss Hall Grove is within walking distance of West Finchley station and is within the catchment of Moss Hall School. Local amenities can be found along both High Road and Ballards Lane, as well as further public transport.

### Features

- Three Bedrooms
- No Chain
- Open Plan Living
- Family Bathroom
- Downstairs WC
- Rear Garden

# Moss Hall Grove, London, N12

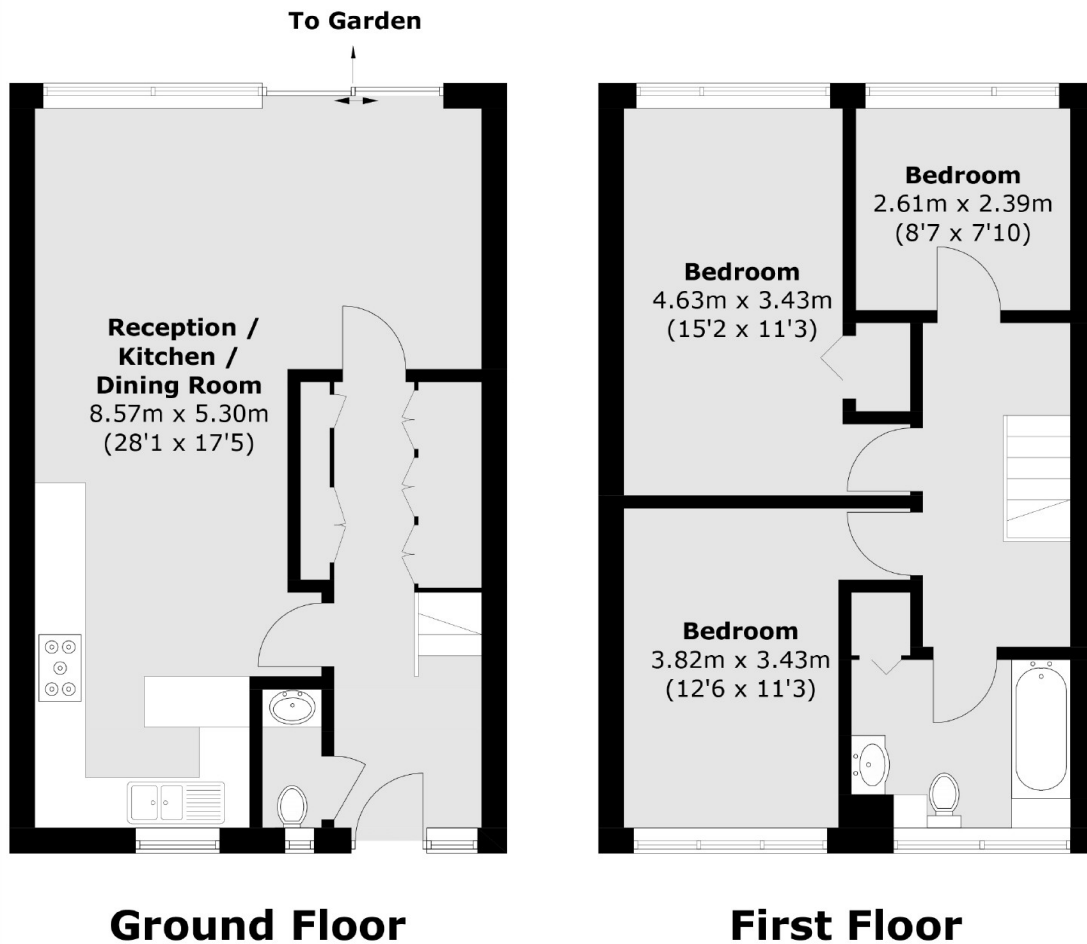

Total area (approx.): 91.1 sq. m (980.6 sq. ft)