

## Gruneisen Road, N3

£375,000

A newly refurbished lower ground apartment offering two bedrooms, an open plan living room and kitchen, family bathroom, a secluded garden, no onward chain and a share of freehold.

The property is located just off of Ballards Lane, positioned near Finchley's best local amenities and popular Victoria Park. Being a no-through road, Gruneisen Road is not used by the local public making it a peaceful location while also being situated near both West Finchley station and Finchley Central station.

### Features

- No Chain
- Newly Renovated
- Two Bedrooms
- Family Bathroom
- Secluded Garden
- Open Plan Living Room

# Gruneisen Road, London, N3

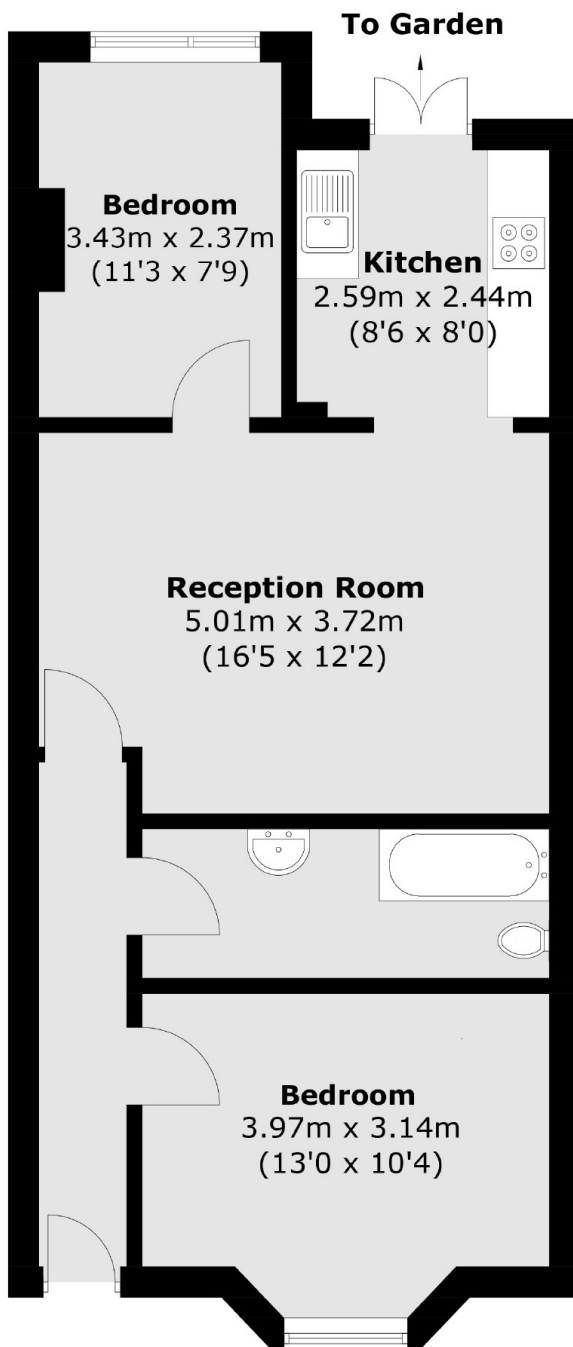

## Lower Ground Floor

Total area (approx.): 56.8 sq. m (611.4 sq. ft)