



3 Bed
House - Detached

located in
Bellerby Road,
Doncaster

Guide Price £325,000



Moss
PROPERTIES

DIRECTIONS

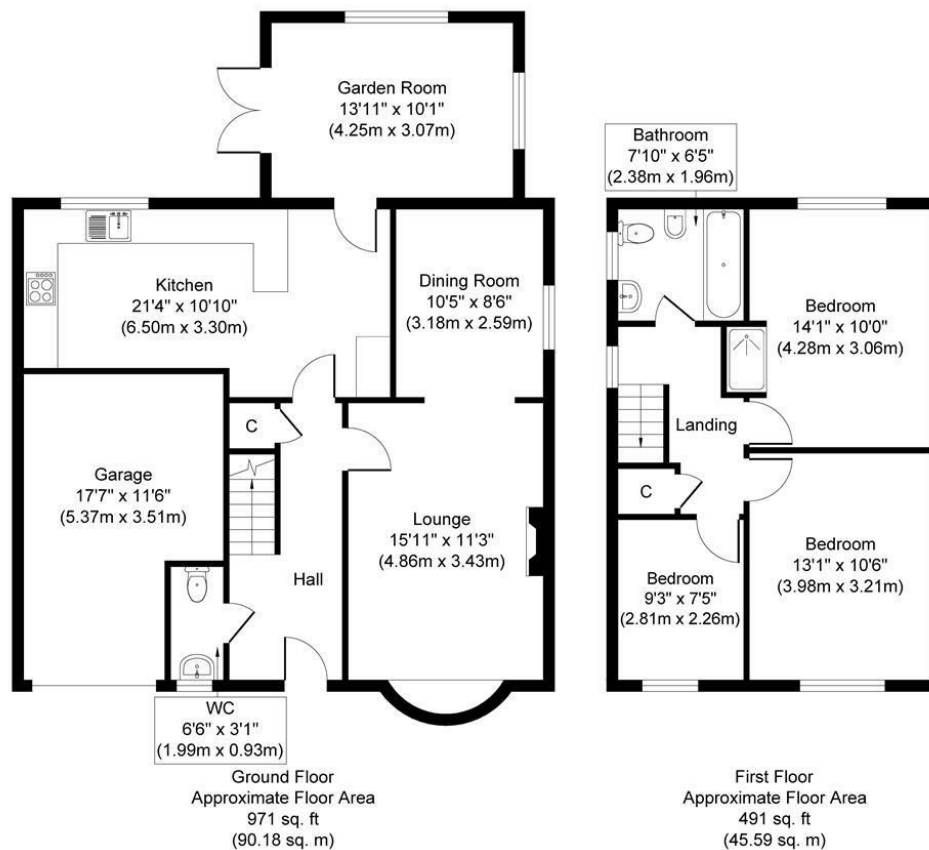

CONTACT

White Rose Way
Doncaster
South Yorkshire

E: info@mossspm.co.uk
T: 01302 730077
www.mossspm.co.uk

Whilst every attempt has been made to ensure the accuracy of the floor plan contained here, measurements of doors, windows, rooms and any other items are approximate and no responsibility is taken for any error, omission, or mis-statement. The measurements should not be relied upon for valuation, transaction and/or funding purposes. This plan is for illustrative purposes only and should be used as such by any prospective purchaser or tenant. The services, systems and appliances shown have not been tested and no guarantee as to their operability or efficiency can be given.

Copyright V360 Ltd 2026 | www.houseviz.com

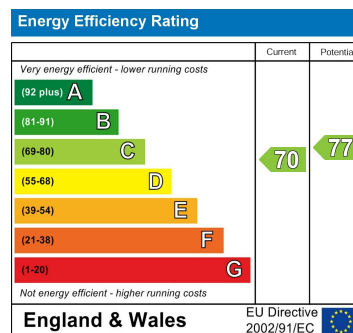

Moss
PROPERTIES