



2 Bed
House - Mid
Terrace

located in
St. Johns Road,
Doncaster

£90,000



Moss
PROPERTIES

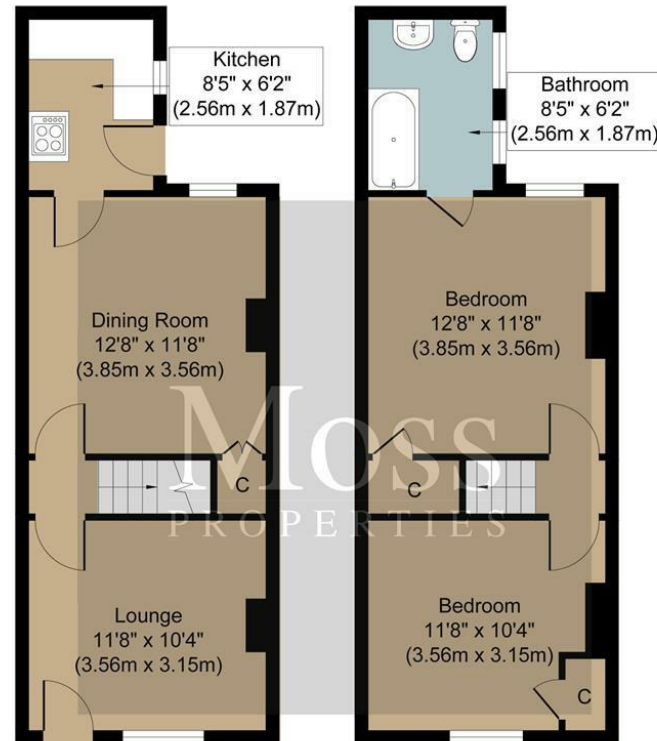

Ground Floor
 Approximate Floor Area
 360 sq. ft
 (33.45 sq. m)

First Floor
 Approximate Floor Area
 360 sq. ft
 (33.45 sq. m)

Whilst every attempt has been made to ensure the accuracy of the floor plan contained here, measurements of doors, windows, rooms and any other items are approximate and no responsibility is taken for any error, omission or misstatement. This plan is for illustrative purposes only and should be used as such by any prospective purchaser. The services, systems and appliances shown have not been tested and no guarantee as to their operability or efficiency can be given.

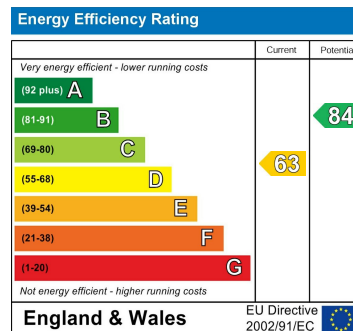

DIRECTIONS

CONTACT

White Rose Way
 Doncaster
 South Yorkshire

E: info@mossspm.co.uk
 T: 01302 730077
 www.mossspm.co.uk

Moss
 PROPERTIES