



1 Bed  
Apartment  
located in White  
Rose Way

£750 PCM



**Moss**  
PROPERTIES

FIRST FLOOR APARTMENT  
393 sq.ft. (36.5 sq.m.) approx.

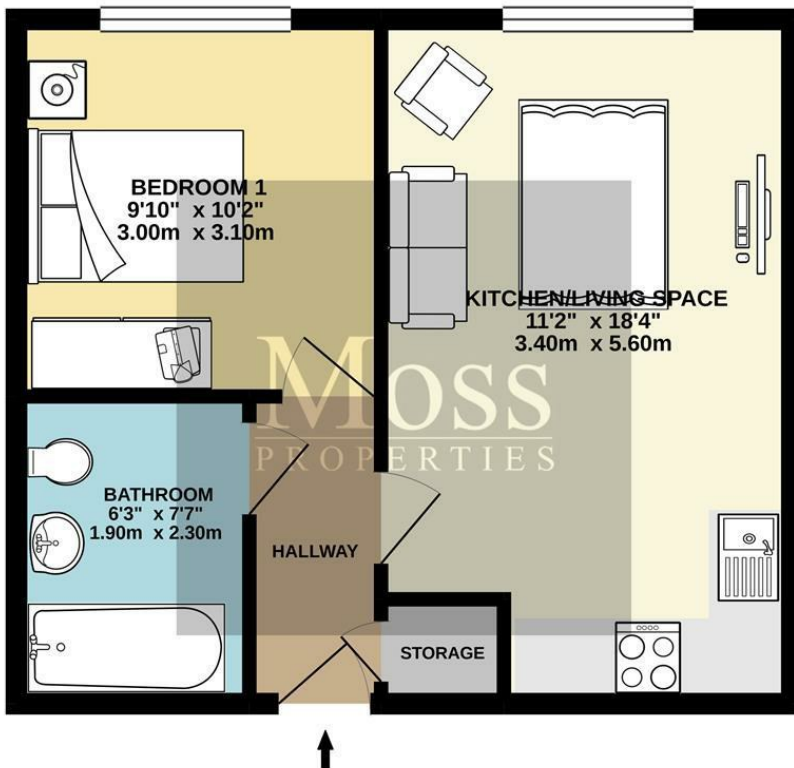

DIRECTIONS

CONTACT

White Rose Way  
Doncaster  
South Yorkshire

E: [info@mosspm.co.uk](mailto:info@mosspm.co.uk)  
T: 01302 730077  
[www.mosspm.co.uk](http://www.mosspm.co.uk)

TOTAL FLOOR AREA : 393 sq.ft. (36.5 sq.m.) approx.

Whilst every attempt has been made to ensure the accuracy of the floorplan contained here, measurements of doors, windows, rooms and any other items are approximate and no responsibility is taken for any error, omission or mis-statement. This plan is for illustrative purposes only and should be used as such by any prospective purchaser. The services, systems and appliances shown have not been tested and no guarantee as to their operability or efficiency can be given.  
Made with Metriplex ©2020

| Energy Efficiency Rating                    |                            |           |
|---|----------------------------|-----------|
|   | Current                    | Potential |
| Very energy efficient - lower running costs |                            |           |
| (92 plus) <b>A</b>                          |                            |           |
| (81-91) <b>B</b>                            | 83                         | 83        |
| (69-80) <b>C</b>                            |                            |           |
| (55-68) <b>D</b>                            |                            |           |
| (39-54) <b>E</b>                            |                            |           |
| (21-38) <b>F</b>                            |                            |           |
| (1-20) <b>G</b>                             |                            |           |
| Not energy efficient - higher running costs |                            |           |
| England & Wales                             | EU Directive<br>2002/91/EC |           |

**Moss**  
PROPERTIES