



1 Bed
Flat

located in
Kentmere Drive,
Lakeside

Offers Over £100,000



Moss
PROPERTIES

GROUND FLOOR
618 sq.ft. (57.4 sq.m.) approx.

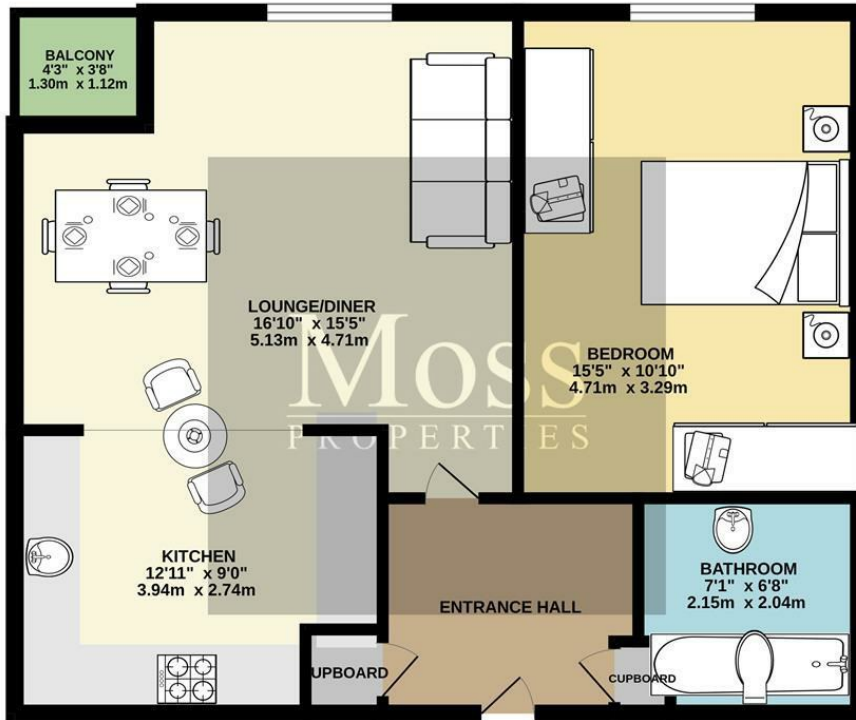

TOTAL FLOOR AREA: 618 sq.ft. (57.4 sq.m.) approx.
 Whilst every attempt has been made to ensure the accuracy of the floorplan contained here, measurements of doors, windows, rooms and any other items are approximate and no responsibility is taken for any error, omission or mis-statement. This plan is for illustrative purposes only and should be used as such by any prospective purchaser. The services, systems and appliances shown have not been tested and no guarantee as to their operability or efficiency can be given.
 Made with Metropix ©2023.

| Energy Efficiency Rating | | Current | Potential |
|---|--|-------------------------|-----------|
| Very energy efficient - lower running costs | | | |
| (92 plus) A | | | |
| (81-91) B | | 80 | 85 |
| (69-80) C | | | |
| (55-68) D | | | |
| (39-54) E | | | |
| (21-38) F | | | |
| (1-20) G | | | |
| Not energy efficient - higher running costs | | | |
| England & Wales | | EU Directive 2002/91/EC | |

DIRECTIONS

CONTACT

White Rose Way
Doncaster
South Yorkshire

E: info@mossspm.co.uk
T: 01302 730077
www.mossspm.co.uk

Moss
PROPERTIES