



30e Forrester Park
Avenue
Edinburgh
EH12 9AW



30e Forrester Park Avenue is a spacious three bedroom top floor flat within a purpose built block with access to the excellent local amenities and an easy commute to the city centre. The property would benefit from some light upgrading but offers an excellent opportunity to create a wonderful family home or as an investment property.

Accommodation:

- Entrance hall
- Spacious front facing living room
- Kitchen fitted with base and wall mounted units.
- Three bedrooms
- Family bathroom
- Excellent storage throughout
- Communal drying green
- Gas central heating and double glazing

EPC Rating-C

Council Tax Band- B



Viewing by appointment on 0131 524 3800







Forrester Park is conveniently located in the popular suburb of Corstorphine, to the west of Edinburgh city centre. A wealth of local amenities are available within easy walking distance of the property including Tesco Extra and Lidl supermarkets, and excellent public transport links by bus or tram connect quickly to the city centre and surrounding areas including the airport, Hermiston Gait and The Gyle. Well regarded schooling is available from nursery to secondary level, with Edinburgh College and Napier University's Sighthill campus also within walking distance. By car, the city bypass and central motorway network are within easy reach. A wide variety of sporting and recreational facilities are available in the area including David Lloyd Leisure Centre and The Gym Group.

Forrester Park Avenue,
Edinburgh,
Midlothian, EH12 9AW



Approx. Gross Internal Area
759 Sq Ft - 70.51 Sq M
For identification only. Not to scale.
© SquareFoot 2025

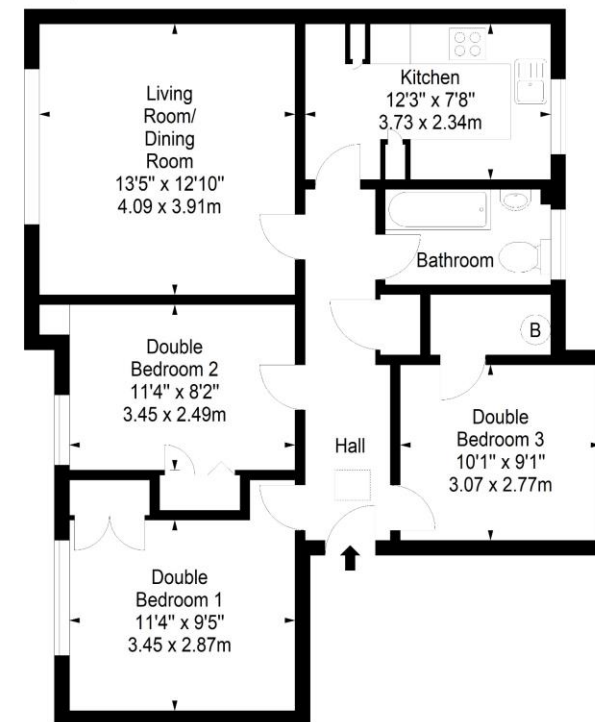

Second Floor