



17 Charnock Drive

, Sheffield, S12 3HD

£250,000

Floor Plan

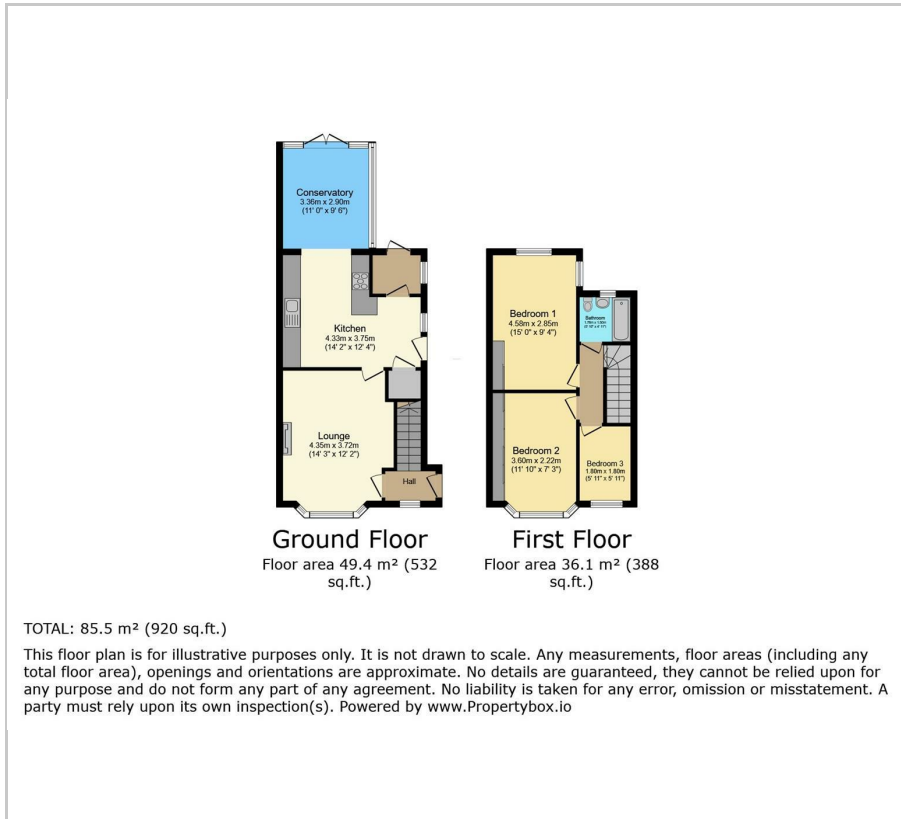

Area Map



Energy Efficiency Graph

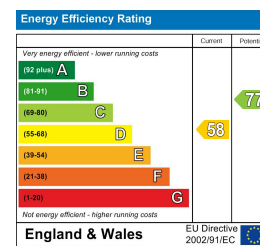

Viewing

Please contact our Ready Steady Move Sales Office on 0114 395 1722 if you wish to arrange a viewing appointment for this property or require further information.

- SEMI-DETACHED PROPERTY
- DRIVEWAY AND GARAGE
- SOUTH FACING GARDEN
- CONSERVATORY
- COUNCIL TAX BAND
- THREE BEDROOMS
- HIGHLY SOUGHT AFTER AREA
- MODERN THROUGHOUT
- EPC RATING D
- LEASEHOLD

Ready Steady MOVE are delighted to market this deceptively spacious three bedroom semi-detached property located in the highly sought after residential area of Charnock. It is well place for a good range of amenities including primary and secondary schools, shops and transport links.

The property comprises of: a main entrance, a spacious lounge with a log burner, a large modern kitchen with a range of wall and base units including integrated appliances and conservatory which is currently used as a dining room.

The first floor of the property has two double bedrooms and a single bedroom/study and a family bathroom.

To the front of the property offers a driveway with off street parking.

At the rear of the property boasts a large stunning south-facing garden with a entertaining patio area and laid to lawn grass area.



These particulars, whilst believed to be accurate are set out as a general outline only for guidance and do not constitute any part of an offer or contract. Intending purchasers should not rely on them as statements of representation of fact, but must satisfy themselves by inspection or otherwise as to their accuracy. No person in this firms employment has the authority to make or give any representation or warranty in respect of the property.

4 Walseker Lane, Harthill, S26 7YJ

Tel: 0114 395 1722 Email: enquiries@readysteadymove.net <https://www.readysteadymove.net>