



227 Manchester Road

Deepcar, Sheffield, S36 2QZ

£155,000

Floor Plan

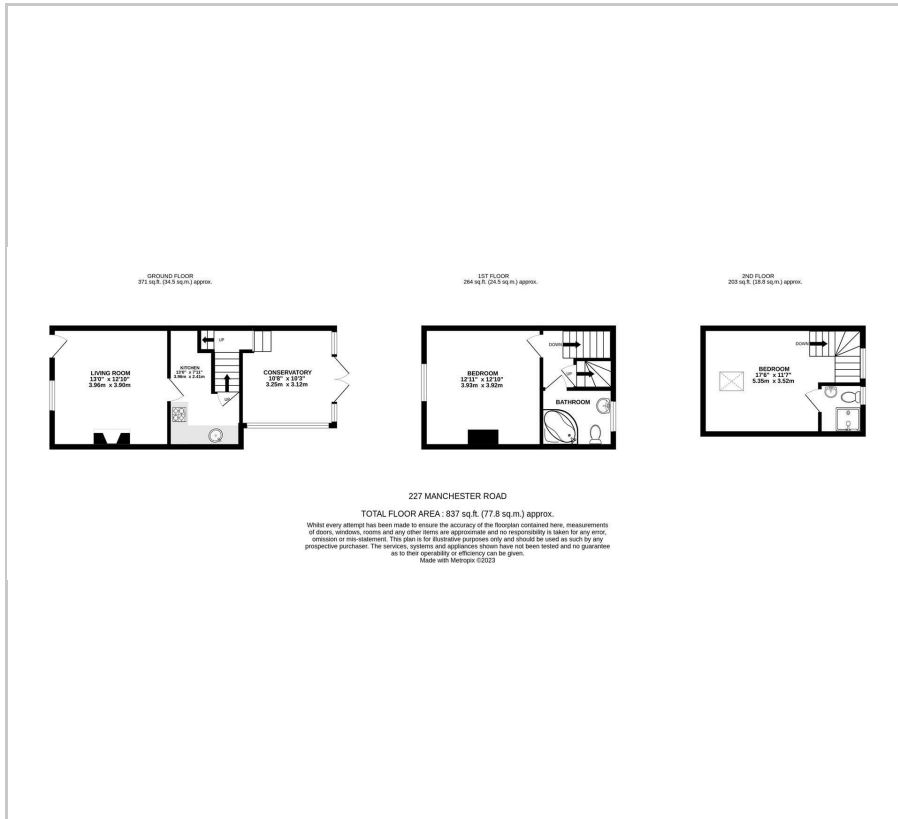

Area Map



Energy Efficiency Graph

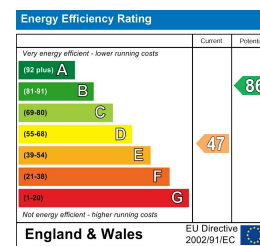

Viewing

Please contact our Ready Steady Move Sales Office on 0114 395 1722 if you wish to arrange a viewing appointment for this property or require further information.

- END OF TERRACE
- OVER 3 FLOORS
- MASTER BEDROOM WITH EN-SUITE
- PARKING AT THE REAR
- COUNCIL TAX BAND
- 2 DOUBLE BEDROOMS
- CONSERVATORY
- MODERN KITCHEN SUITE
- EPC RATING
- FREEHOLD

Ready Steady MOVE are delighted to market this two bedroomed end of terrace property located in the the sought after area of Deepcar. This property is is close to local amenities and has Fox Valley Shopping Centre on it's doorstep.

The property comprises of a bright and spacious living room, a modern kitchen with a range of wall and base units and a conservatory.

To the first floor is a large double bedroom and a family bathroom.

On the second floor is the master bedroom with a large dormer and skylight allowing lots of light and en-suite shower room with a walk in shower.



These particulars, whilst believed to be accurate are set out as a general outline only for guidance and do not constitute any part of an offer or contract. Intending purchasers should not rely on them as statements of representation of fact, but must satisfy themselves by inspection or otherwise as to their accuracy. No person in this firms employment has the authority to make or give any representation or warranty in respect of the property.

4 Walseker Lane, Harthill, S26 7YJ

Tel: 0114 395 1722 Email: enquiries@readysteadymove.net <https://www.readysteadymove.net>