



## 168 Great North Road, Woodlands , Doncaster, DN6 7HT

Three-Bedroom Semi-Detached Home with Excellent Potential

Offered to the market with no onward chain, this three-bedroom semi-detached property presents an exciting opportunity for buyers seeking a family home they can truly make their own.

The ground floor offers two generously sized reception rooms – a bright lounge and a separate dining room – providing versatile living and entertaining space. Upstairs, the property benefits from three well-proportioned bedrooms, a family bathroom, and a separate toilet area.

Externally, the home boasts a large rear garden, perfect for families and outdoor enjoyment, along with off-road parking for multiple vehicles.

Situated in a convenient location close to local amenities, schools, and transport links, this property combines practicality with great scope for modernisation and improvement.

**Offers in the region of £150,000**

# 168 Great North Road, Woodlands , Doncaster, DN6 7HT



- Three-bedroom semi-detached family home
- Two spacious reception rooms – lounge and dining room
- Off-road parking for multiple vehicles
- Council tax band: A & EPC rating C
- Offered with no onward chain
- Upstairs bathroom with separate WC
- Fantastic opportunity for families or investors
- Scope for modernisation and improvement
- Generous rear garden, ideal for families
- Excellent transport links and nearby schools

## Hallway

## W/C

## Dining room

10'8" x 12'4" (3.26 x 3.77 )

## Bathroom

7'2" x 5'10" (2.19 x 1.80)

## Lounge

14'0" x 10'11" (4.27 x 3.33)

## Kitchen

7'4" x 16'9" (2.24 x 5.13)

## Master bedroom

12'5" x 10'10" (3.79 x 3.31)

## Bedroom 2

10'10" x 8'10" (3.31 x 2.71)

## Bedroom 3

7'4" x 8'3" (2.25 x 2.54)

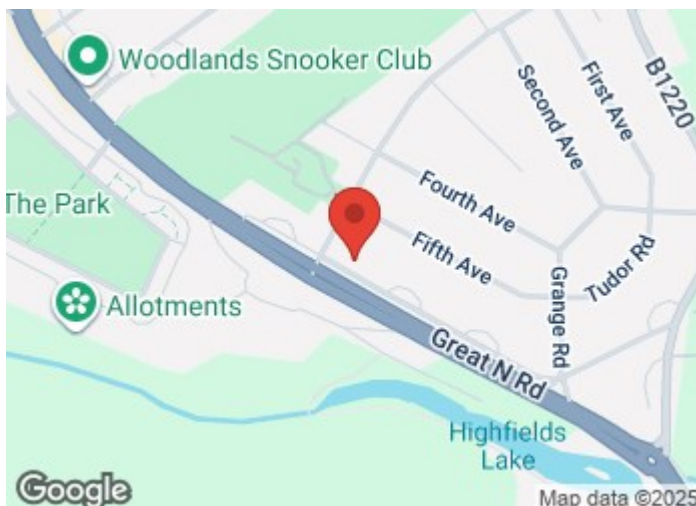

## Directions

Woodlands is a model village 4 miles (6 km) north-west of Doncaster in South Yorkshire, England. The village lies adjacent to Highfields and Adwick le Street within the City of Doncaster. Woodlands schools are Woodlands Infants School, and Woodlands Junior School, which are now known as Woodlands Primary School. There's also Adwick infant and Adwick primary school, and St Joseph & St Teresa's school which is an infant and primary catholic school. Outwood Academy Adwick is the only secondary school in the area.









Floor Plan

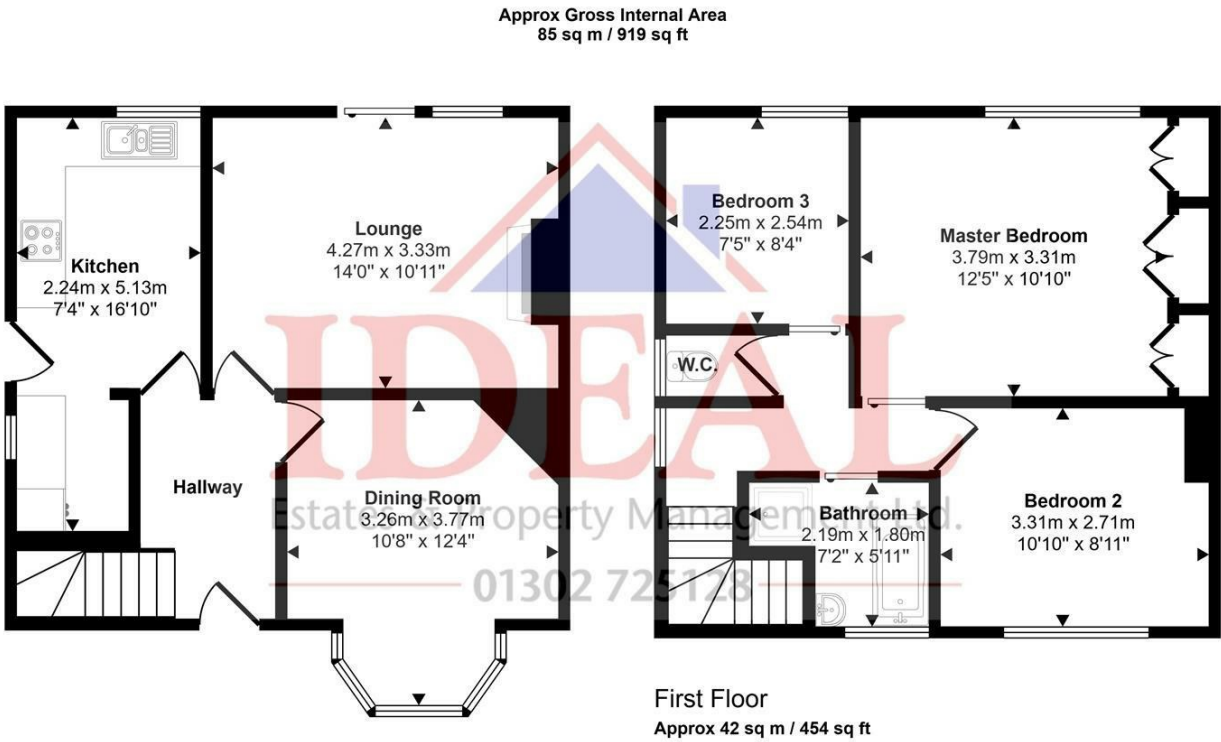

Ground Floor  
Approx 43 sq m / 465 sq ft

This floorplan is only for illustrative purposes and is not to scale. Measurements of rooms, doors, windows, and any items are approximate and no responsibility is taken for any error, omission or mis-statement. Icons of items such as bathroom suites are representations only and may not look like the real items. Made with Made Snappy 360.

These particulars, whilst believed to be accurate are set out as a general outline only for guidance and do not constitute any part of an offer or contract. Intending purchasers should not rely on them as statements of representation of fact, but must satisfy themselves by inspection or otherwise as to their accuracy. No person in this firms employment has the authority to make or give any representation or warranty in respect of the property.

