



## 34 Forresters Close

Norton, Doncaster, DN6 9HX

Nestled in the charming Forresters Close in Norton, Doncaster, this detached bungalow is a true gem waiting to be discovered. Boasting a delightful blend of modernity and comfort, this extended, 3-bedroom property is a haven for those seeking a stylish yet cosy home.

As you step inside, you'll be greeted by a beautifully appointed interior that exudes warmth and sophistication. The open-plan layout of the living space is perfect for both relaxing evenings and entertaining guests, with striking bifold doors that lead out to the meticulously maintained rear garden. Imagine enjoying a cup of tea in the summer house or hosting a barbecue on a sunny afternoon - the possibilities are endless. The master bedroom is a real highlight, offering a generous space flooded with natural light thanks to a skylight above. It's the ideal retreat after a long day, providing a peaceful sanctuary to unwind and recharge.

The modern kitchen is equipped with all the necessary amenities to whip up delicious meals for family and friends. And let's not forget the ample driveway leading to the garage, ensuring convenience and practicality for your everyday needs. In conclusion, this detached bungalow in Norton is a rare find - a harmonious blend of contemporary living and tranquil surroundings. Don't miss the opportunity to make this house your home sweet home.

**Guide price £250,000**

# 34 Forresters Close

Norton, Doncaster, DN6 9HX



- Viewing is essential on with turn key property
- Modern open plan living with feature bi-fold doors leading to the rear garden
- Ample off road parking and detached garage
- EPC RATING 71C & CTAX BAND C
- A beautifully appointed, extended detached bungalow
- Manicured gardens, enclosed rear with patio area and summer house
- Don't miss the opportunity to make this house your home sweet home.
- 3 good double bedrooms
- Fully double glazed and Gas central heating
- CCTV AND ALARM SYSTEM

FRONT ENTRANCE HALL

MASTER BEDROOM ONE

BEDROOM TWO

BEDROOM THREE

L SHAPED OPEN PLAN LOUNGE /  
DINER

KITCHEN

BATHROOM

SPACIOUS DRIVEWAY TO  
DETACHED GARAGE

SUMMER HOUSE

MANICURED FRONT AND REAR  
GARDENS

QUIET CUL-DE-SAC LOCATION



[Directions](#)



# Floor Plan

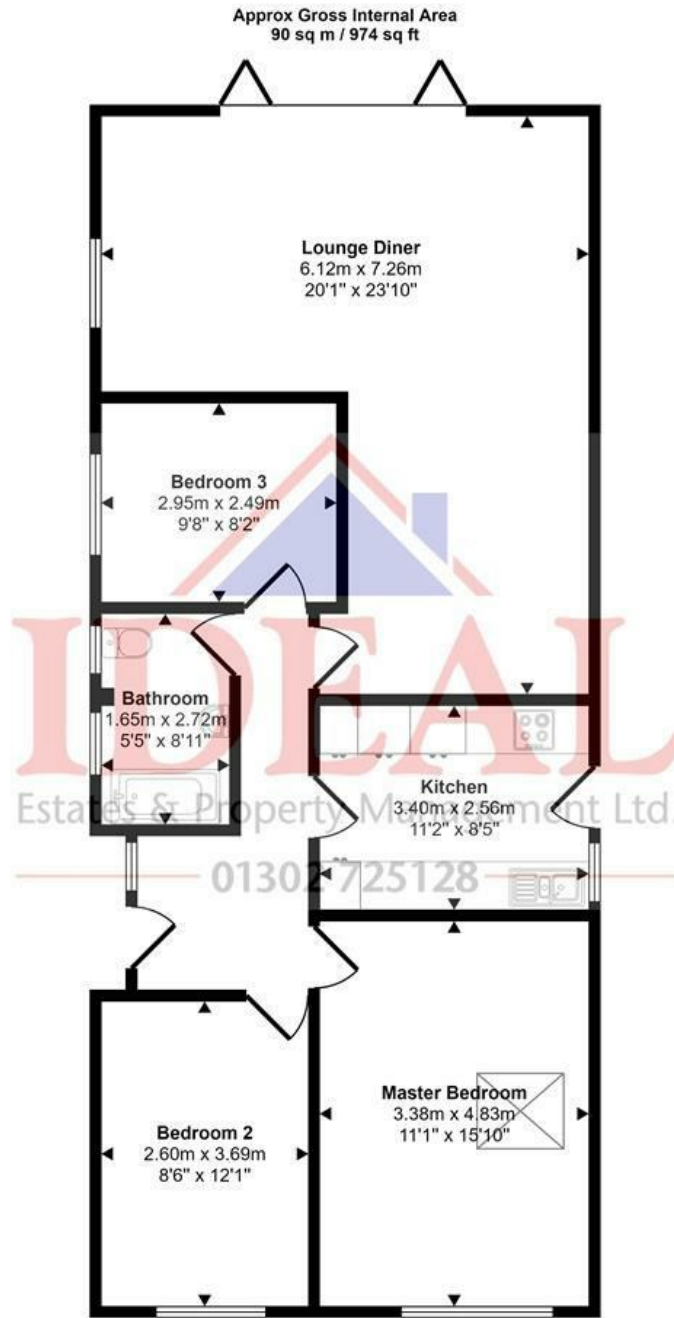

Floorplan

This floorplan is only for illustrative purposes and is not to scale. Measurements of rooms, doors, windows, and any items are approximate and no responsibility is taken for any error, omission or mis-statement. Icons of items such as bathroom suites are representations only and may not look like the real items. Made with Made Snappy 360.

These particulars, whilst believed to be accurate are set out as a general outline only for guidance and do not constitute any part of an offer or contract. Intending purchasers should not rely on them as statements of representation of fact, but must satisfy themselves by inspection or otherwise as to their accuracy. No person in this firm's employment has the authority to make or give any representation or warranty in respect of the property.

