



## 23 Sherwood Drive, Skellow, Doncaster, DN6 8NY

Nestled in the charming Sherwood Drive of Skellow, Doncaster, this detached bungalow is a true gem waiting to be discovered. As you step inside, you'll be greeted by a spacious reception room, perfect for entertaining guests or simply unwinding after a long day. Boasting four generously sized bedrooms, including two with en-suite bathrooms, this property offers ample space for a growing family or visiting guests. The newly extended and renovated interior exudes modernity and style, with a fresh, contemporary feel throughout.

The heart of this home lies in its new, modern fitted kitchen, seamlessly flowing into the dining room. Imagine hosting delightful dinner parties or enjoying a leisurely breakfast with the family, all while basking in the natural light streaming through the French doors that lead out to the private rear garden.

Speaking of the garden, the large plot provides plenty of space for outdoor activities, gardening, or simply soaking up the sun in your own peaceful oasis. With parking available for up to five vehicles, convenience is at your doorstep, making this property ideal for commuters or those with a penchant for hosting gatherings. In conclusion, this deceptively spacious family home offers a perfect blend of comfort, style, and convenience. With no chain attached, the opportunity to make this property your own is ripe for the taking. Don't miss out on the chance to view this exceptional home - book your viewing today and step into the future of luxurious living at Sherwood Drive.

**Guide price £335,000**

# 23 Sherwood Drive, Skellow, Doncaster, DN6 8NY



- Viewing is essential on the NEWLY EXTENDED detached bungalow
- Beautiful open plan kitchen/diner
- Council tax C, EPC 74C
- Well presented lounge.
- 4 double bedrooms - 2 of which come with en-suites
- Larger than average plot, ample parking, secluded rear garden
- Ideal for commuters with easy motorway access and close to Adwick train station.
- A total renovation throughout
- No forward chain
- Deceptively spacious home ideal for a growing family

Front entrance hallway

Kitchen/diner

Lounge

Family Bathroom

Bedroom 1 with En-suite

Bedroom 2

Bedroom 3 with shower room

Bedroom 4

Storage cupboard

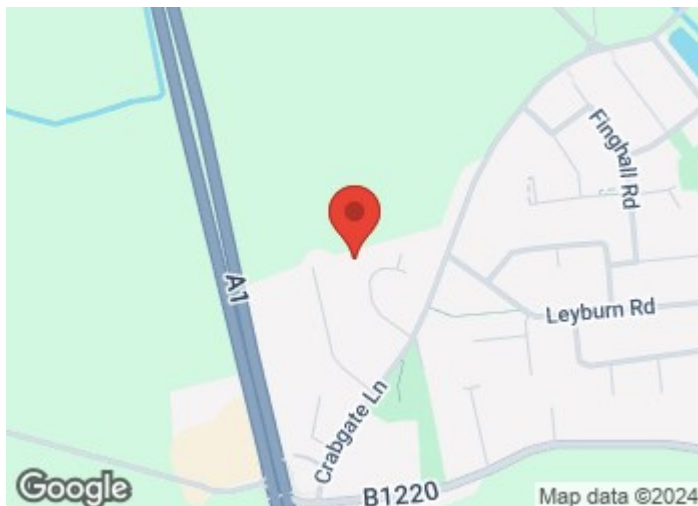

Directions

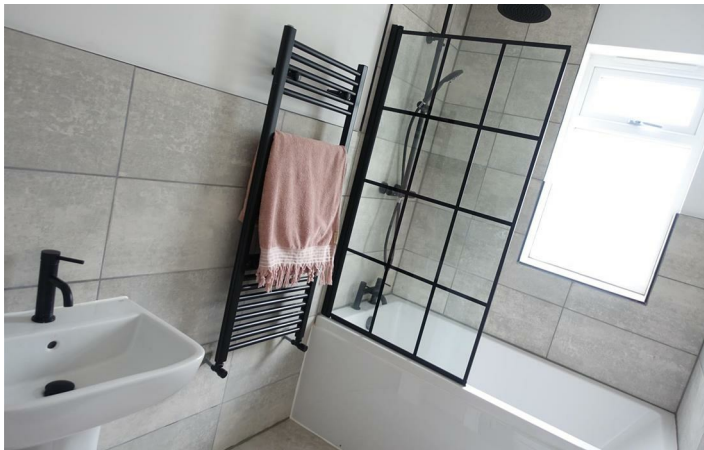

# Floor Plan

Approx Gross Internal Area  
117 sq m / 1256 sq ft

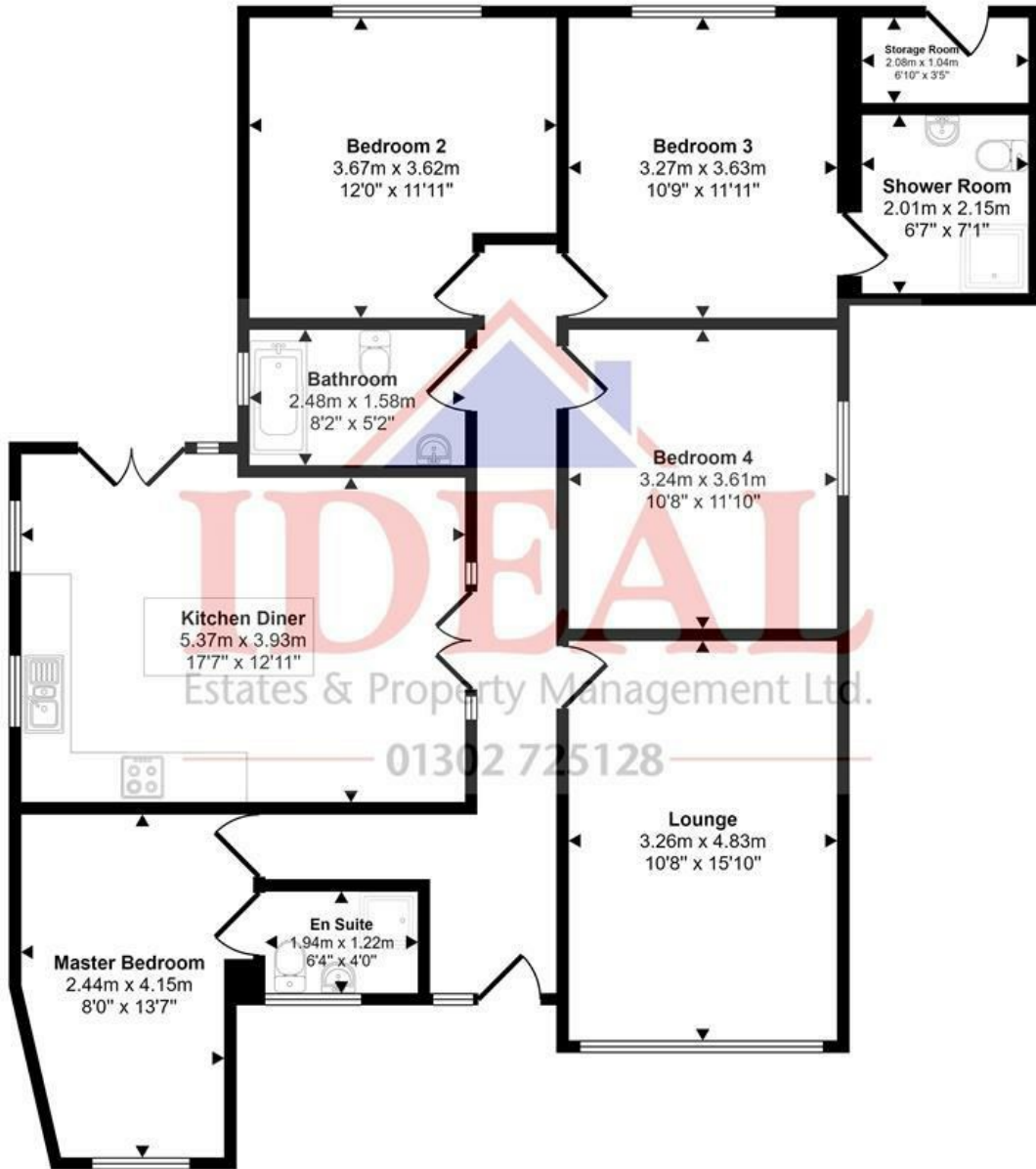

Floorplan

This floorplan is only for illustrative purposes and is not to scale. Measurements of rooms, doors, windows, and any items are approximate and no responsibility is taken for any error, omission or mis-statement. Icons of items such as bathroom suites are representations only and may not look like the real items. Made with Made Snappy 360.

These particulars, whilst believed to be accurate are set out as a general outline only for guidance and do not constitute any part of an offer or contract. Intending purchasers should not rely on them as statements of representation of fact, but must satisfy themselves by inspection or otherwise as to their accuracy. No person in this firm's employment has the authority to make or give any representation or warranty in respect of the property.

