



2 Floors



3 Bedrooms



1 En suite

## LAWRENCE THREE BEDROOM HOME

A three bedroom detached home with a substantial lounge and an impressive open plan kitchen / dining area with French doors leading to the rear garden. Upstairs boasts three generous bedrooms with the master benefitting from an en suite shower room.

# LAWRENCE THREE BEDROOM HOME

## ✦ DIMENSIONS

### First Floor:

#### Bedroom 1

3.21m x 3.50m  
10'6" x 11'6"

#### En Suite

#### Bedroom 2

3.31m x 2.45m  
10'10" x 8'0"

#### Bedroom 3

3.33m x 2.43m  
10'11" x 7'11"

#### Bathroom

### Ground Floor:

#### Lounge

3.26m x 4.95m  
10'8" x 16'3"

#### Kitchen / Dining

3.21m x 4.95m  
10'6" x 16'3"

(S) Storage

(C) Cloaks

◀ ▶ Measurement Points

△ External Access

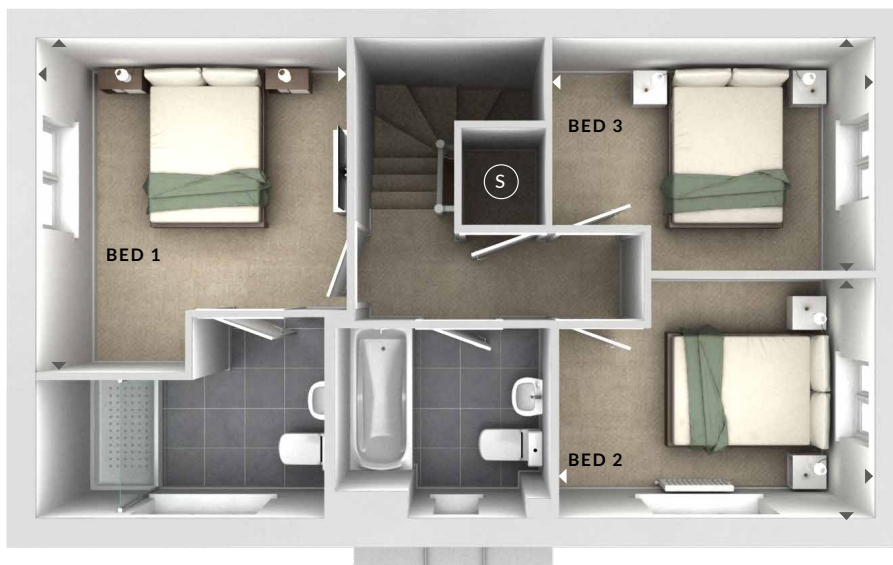

First Floor

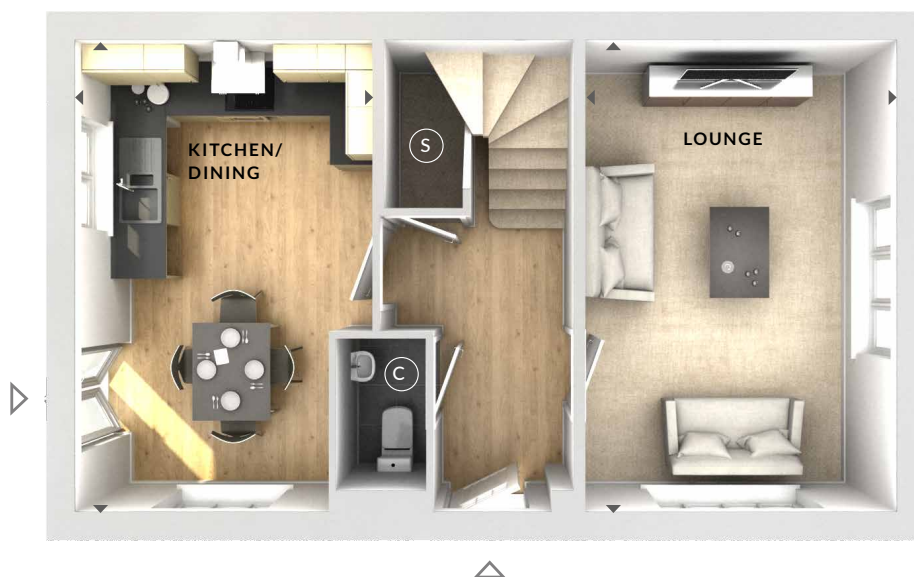

Ground Floor