

# BRUNTON

---

## RESIDENTIAL

T. 0191 236 8347  
E. [info@bruntonresidential.com](mailto:info@bruntonresidential.com)  
A. 125 St George's Terrace, NE2  
W. 2DN  
[bruntonresidential.com](http://bruntonresidential.com)



### Bramble Way

#### Brunton Rise Great Park, NE13 9EX

**\*\*360 Virtual Tour\*\*** Available 22/07/2025 - Rent £1,400PCM - Brand new build on Brunton Rise - Taylor Wimpey Colton Build - 3 Bedroom Semi-detached 3 storey house - Popular cul de sac plot - Family bathroom - En-suite from the main bedroom - Double bedrooms - Separate w/c - Double Driveway - Large-sized North facing rear garden - Available on an unfurnished basis - Extremely sought after property in Great Park- Pets not accepted at this time.

**£1,400 PCM**

# 16 Bramble Way

## Brunton Rise Great Park, NE13 9EX



**\*\*360 Virtual Tour\*\*** Available 22/07/2025 - Rent £1,400PCM - Brand new build on Brunton Rise - Taylor Wimpey Colton Build - 3 Bedroom Semi-detached 3 storey house - Popular cul de sac plot - Family bathroom - En-suite from the main bedroom - Double bedrooms - Separate w/c - Double Driveway - Large-sized North facing rear garden - Available on an unfurnished basis - Extremely sought after property in Great Park.

Briefly comprising of: To the ground floor - Hallway - Kitchen with integral oven and hob with extractor fan, fridge freezer, dishwasher and washing machine - large living room - WC - Storage cupboards.  
To the first floor - Large double bedroom - Family bathroom - second double bedroom.  
To the second floor - Open plan to the staircase - Large bedroom with en-suite.  
Externally there is a double driveway to the front and a large North-facing garden to the rear.

We anticipate a high level of interest for this brand new Taylor Wimpey home - Apply now to avoid disappointment.

### TO THE GROUND FLOOR

Hallway

Cupboard

Kitchen

11'8" x 8'8" (3.55m x 2.65m)

WC

5'3" x 7'7" (1.60m x 2.30m)

Living Room

12'8" x 16'1" (3.85m x 4.90m)

### TO THE FIRST FLOOR

Landing

### Bedroom 2

10'4" x 16'1" (3.15m x 4.90m)

### Bathroom

7'7" x 6'11" (2.30m x 2.10m)

### Cupboard

### Bedroom 3

10'0" x 8'6" (3.05m x 2.60m)

### TO THE SECOND FLOOR

### Main Bedroom

20'8" x 13'2" (6.30m x 4.02m)

### En-suite

8'6" x 4'11" (2.60m x 1.50m)

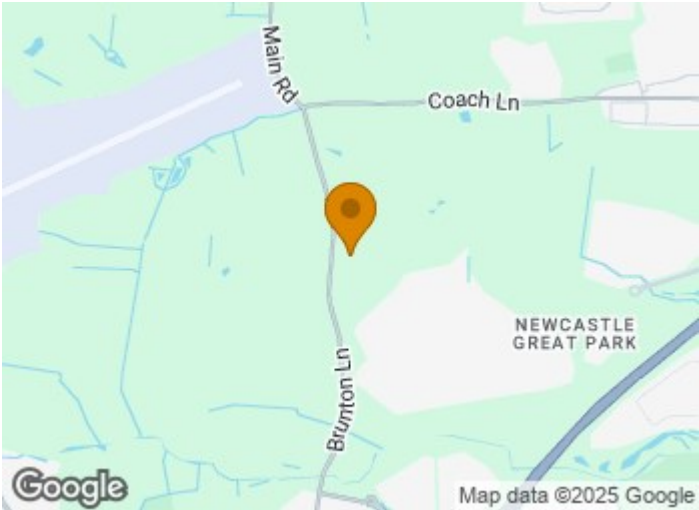

- 360 VIRTUAL TOUR
- 3 BED SEMI-DETACHED HOME
- 3 STOREY HOME
- PERFECT FOR PROFESSIONALS
- AVAILABLE 22/07/2025
- BRUNTON RISE CUL DE SAC PLOT
- INTEGRAL KITCHEN
- RENT £1,400PCM
- TAYLOR WIMPEY COLTON
- BEAUTIFUL FAMILY HOME





Floor Plan

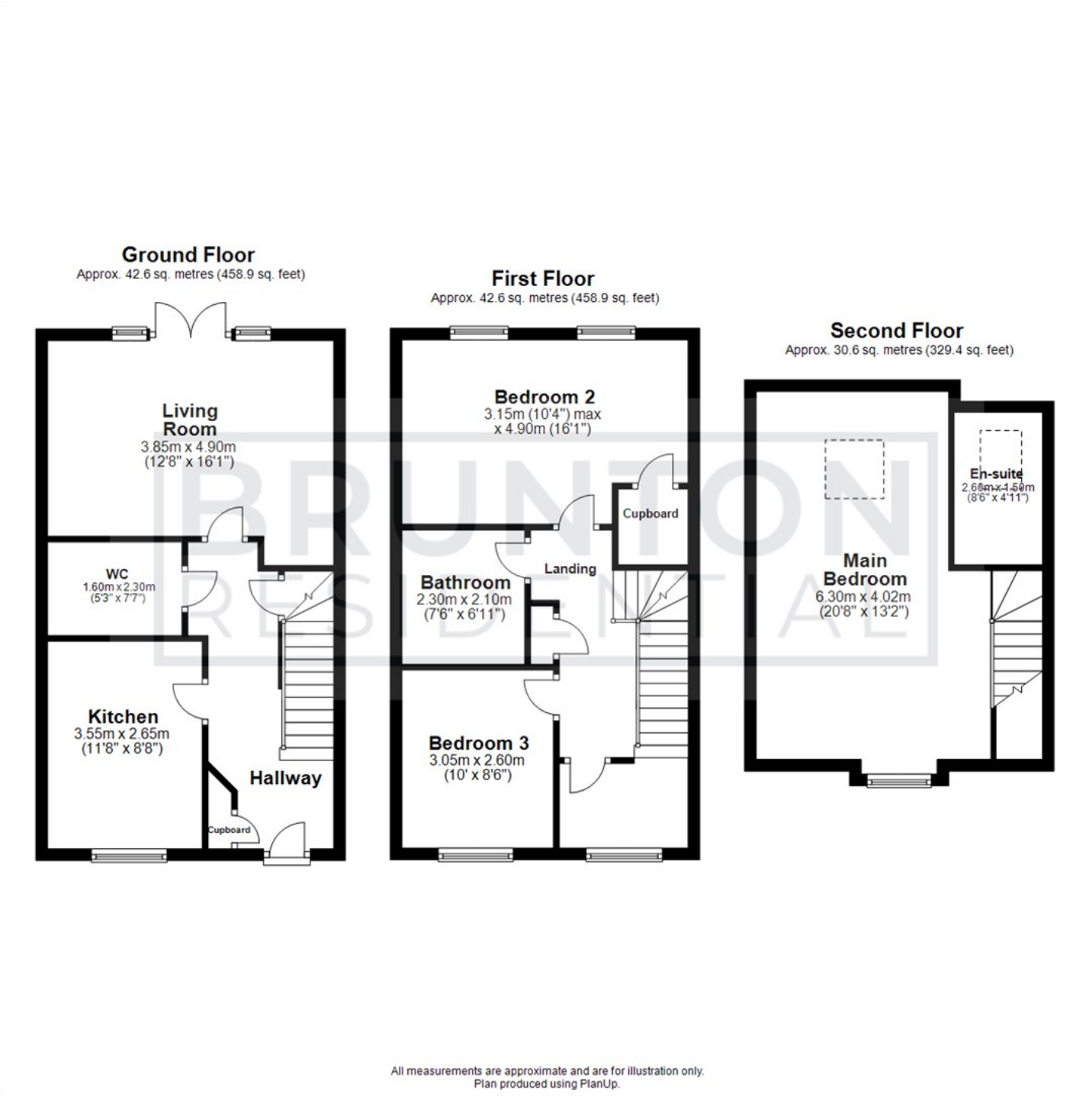

These particulars, whilst believed to be accurate are set out as a general outline only for guidance and do not constitute any part of an offer or contract. Intending purchasers should not rely on them as statements of representation of fact, but must satisfy themselves by inspection or otherwise as to their accuracy. No person in this firms employment has the authority to make or give any representation or warranty in respect of the property.

