

BRUNTON

RESIDENTIAL



POPPY PLACE, GREAT PARK, NE13

£1,450 Per Month

BRUNTON

RESIDENTIAL





BRUNTON

RESIDENTIAL



BRUNTON

RESIDENTIAL



****360 Virtual Tour**** - Available 13th June 2025- Rent £1,450pcm – Buttermere by Persimmon Homes - En-Suite Master Bedroom - Detached House - Intergraded Appliances - Upgraded Kitchen - Integral Garage - Driveway - Spacious Rear Garden - Call Today

BRUNTON

RESIDENTIAL



BRUNTON

RESIDENTIAL

A beautifully presented detached house in a sought-after location.

This home features an upgraded kitchen with integrated appliances, a spacious lounge, and a generous rear garden with artificial grass- perfect for effortless upkeep all year round.

The property boasts an en-suite master bedroom, an integral garage, and a private driveway with surrounding decorative stones, providing ample space and convenience.

Don't miss out – call today to arrange your viewing or explore via our 360° virtual tour.



BRUNTON

RESIDENTIAL

TENURE :

LOCAL AUTHORITY : Newcastle city council

COUNCIL TAX BAND : D

EPC RATING : B

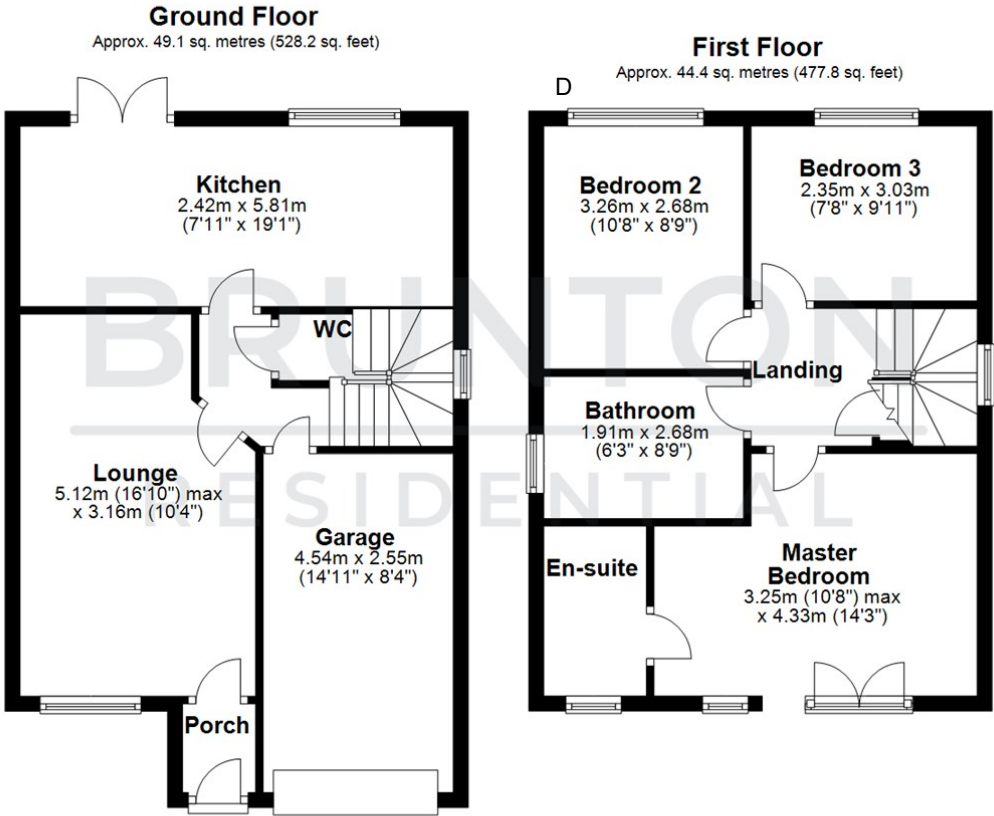

Energy Efficiency Rating		
	Current	Potential
Very energy efficient - lower running costs		
(92-plus) A		94
(81-91) B	82	
(69-80) C		
(55-68) D		
(39-54) E		
(21-38) F		
(1-20) G		
Not energy efficient - higher running costs		
England & Wales	EU Directive 2002/91/EC	

Environmental Impact (CO ₂) Rating		
	Current	Potential
Very environmentally friendly - lower CO ₂ emissions		
(92-plus) A		
(81-91) B		
(69-80) C		
(55-68) D		
(39-54) E		
(21-38) F		
(1-20) G		
Not environmentally friendly - higher CO ₂ emissions		
England & Wales	EU Directive 2002/91/EC	