

BRUNTON

RESIDENTIAL



DATALLER DRIVE, HANNANAH PARK, NE13

£1,800 Per Month

BRUNTON

RESIDENTIAL





BRUNTON

RESIDENTIAL



BRUNTON
RESIDENTIAL



****360 Virtual Tour** Available Now - Rent £1,800pcm - 4 Bedroom Detached House - Garage & Double Driveway - Low Maintenance Rear Garden - EPC Rating B - Pets Considered - Ideal Family Home - Call Today**

BRUNTON

RESIDENTIAL



BRUNTON

RESIDENTIAL

accommodation which briefly comprise of; entrance hallway with access to downstairs WC, garage & store cupboard. There is a bright, spacious lounge and a full length kitchen, dining/family room. The kitchen offers a range of wall and floor units with coordinated work surfaces and fitted appliances with an ample space for formal dining.

The first floor consists of a master suite with ensuite shower room a second ensuite bedroom with shower room and a further two double bedrooms as well as the tiled family bathroom.

Externally there is a garden to the front which is laid mainly to lawn with pathway access to the property and a driveway which provides parking for multiple cars and access to the garage. The west facing rear garden has been landscaped with a combination of lawned and patio areas and raised planted boundaries and there is a fantastic outdoor space for al fresco dining.



BRUNTON

RESIDENTIAL

TENURE :

LOCAL AUTHORITY :

COUNCIL TAX BAND : E

EPC RATING : B

SERVICES :

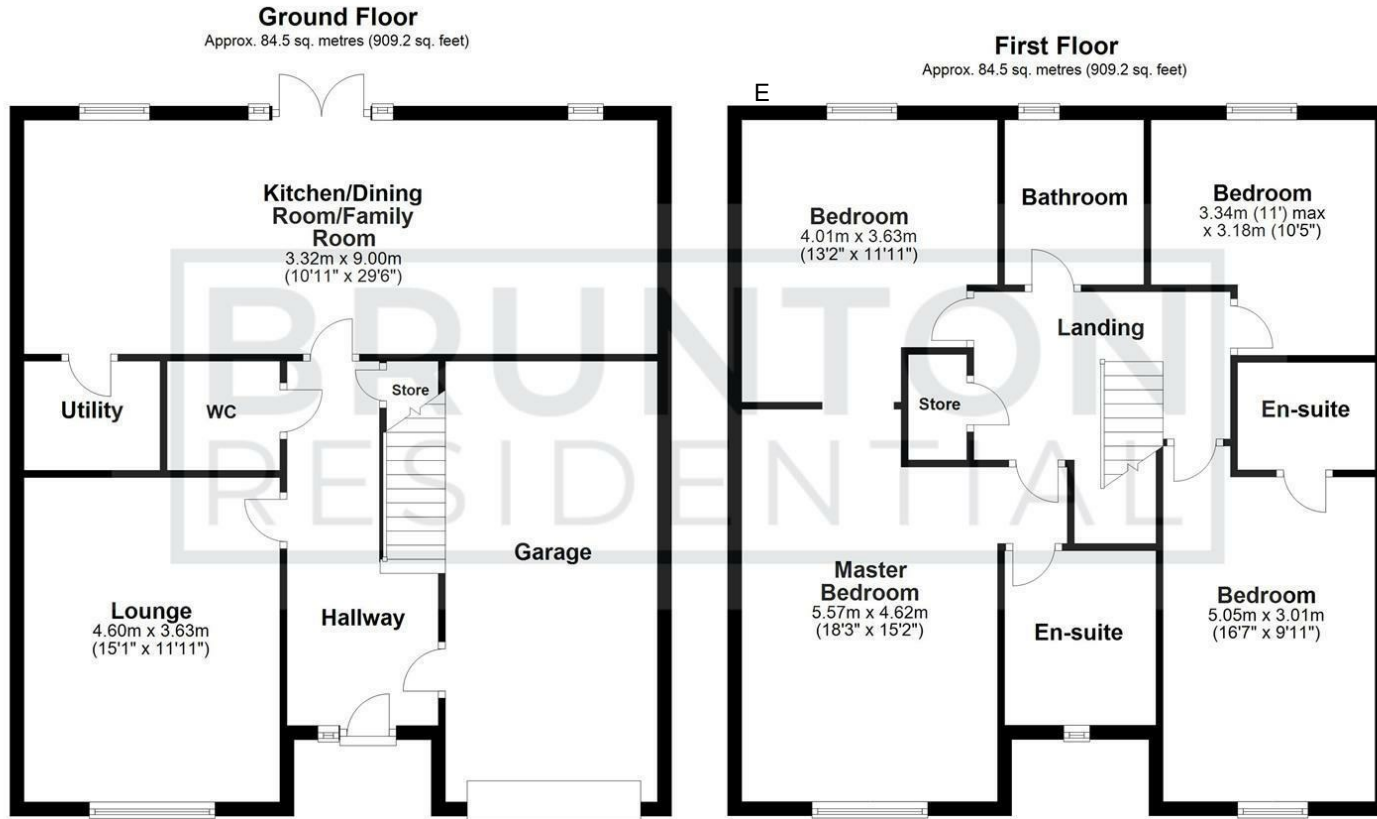

Total area: approx. 168.9 sq. metres (1818.5 sq. feet)

All measurements are approximate and are for illustration only.
Plan produced using PlanUp.

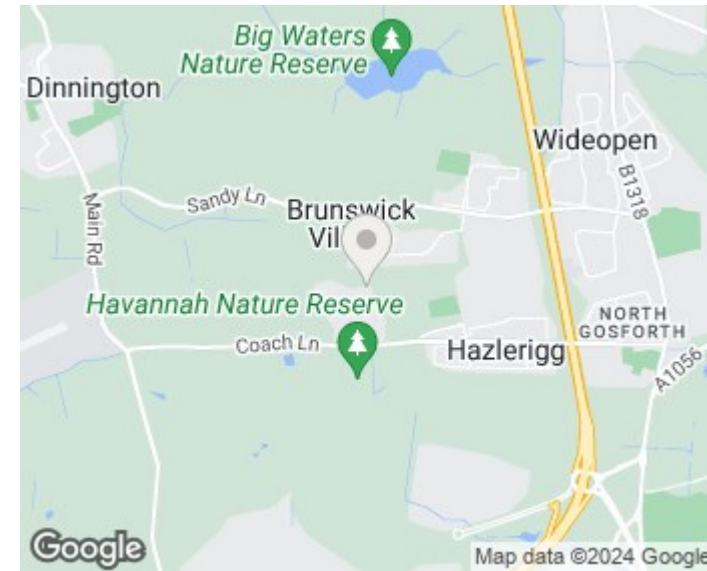

Energy Efficiency Rating	
Current	Potential
84	93
Very energy efficient - lower running costs (92 plus) A (81-91) B (69-80) C (55-68) D (39-54) E (21-38) F (1-20) G Not energy efficient - higher running costs	
EU Directive 2002/91/EC	

Environmental Impact (CO ₂) Rating	
Current	Potential
Very environmentally friendly - lower CO ₂ emissions (92 plus) A (81-91) B (69-80) C (55-68) D (39-54) E (21-38) F (1-20) G Not environmentally friendly - higher CO ₂ emissions	
EU Directive 2002/91/EC	