

6, Wheel Centre, Broad St.,
March, Cambs. PE15 8TX

MARCH

01354 652785

E-mail:

march@robert-hale-homes.co.uk

Website:

www.robert-hale-homes.co.uk

7 DAYS

WISBECH 465222

MARCH 652785

NAEA NETWORK

OVER 1000 OFFICES



**19, STATION ROAD,
MARCH,
PE15 8LE.**

THE PROPERTY

A BEAUTIFUL THREE DOUBLE BEDROOMED FAMILY HOME SITUATED ON A PROMINENT CORNER PLOT IN THE CENTRE OF TOWN!

* FABULOUS 17FT FITTED KITCHEN/GARDEN ROOM * USEFUL UTILITY/PANTRY * DOWNSTAIRS W.C. * GAS FIRED CENTRAL HEATING * DOUBLE GLAZING * LOW MAINTENANCE GARDENS TO REAR * OFF ROAD PARKING SPACE * MUST BE VIEWED TO BE FULLY APPRECIATED! * NO UPWARD CHAIN

PRICE

£270,000

FREEHOLD

EPC BAND D

COUNCIL TAX

BAND A

FENLAND DISTRICT COUNCIL

REF. NO. M4877

SELLING? FREE, FREE, VALUATIONS!



For your own peace of mind, always have an independent survey,
and always test all systems and appliances!
Items displayed in photographs may not necessarily be included.



REF. NO. M4877

19, STATION ROAD, MARCH

HOW TO GET THERE

From our March office proceed along Station Road and the property can be found on the corner of Station Road and Creek Road.

THE ACCOMMODATION

(Dimensions given are approximate only).

ENTRANCE HALL

With Karndean flooring, stairway off, fitted understairs cupboard with low level w.c. and tiled walls.

LOUNGE/DINER

14'(max) x 13'10"(max) With feature fire place, Karndean flooring.

KITCHEN/DINER/GARDEN ROOM 17'3"(max) x 22'3"(max) With underfloor heating, Karndean flooring, peninsular breakfast bar with granite worktop with inset deep sink with mixer tap and cupboard under, built-in dishwasher and wine fridge, dual fuel range cooker, preparation surfaces with drawers and cupboards under, range of wall cupboards, feature square archway into garden room with French doors to rear garden.

PANTRY/UTILITY

9'7"(max) x 4'7"(max) With space/plumbing for washing machine, space for fridge/freezer, granite worktop with cupboards under, wall cupboards, storage cupboards, wall mounted gas fired Viessman central heating boiler.

FIRST FLOOR

LONG LANDING

With access to loft.

FAMILY BATHROOM/W.C./SHOWER ROOM With quadrant shower cubicle with thermostatic shower and spray, low level w.c., inset hand washbasin with mixer tap and cupboards under, free standing roll top bath with mixer tap and shower attachment, Karndean floor.

BEDROOM NO. 1

13'11"(max) x 10'6"(max) With feature original fireplace, Karndean floor.

BEDROOM NO. 2

12'(max) x 9'(max) Laminate floor.

BEDROOM NO. 3

14'(max) x 8'3"(max) With fitted sliding wardrobes, fitted wardrobe/cupboard, Karndean flooring.

OUTSIDE

COLD WATER TAP. OUTSIDE LIGHTS.

GARDENS

Enclosed low maintenance small garden to front.
Small low maintenance gardens to rear down to a paved patio and a decked bar-b-que area, timber gate to rear opens onto the off road parking space to rear of the property.



REF. NO. M4877

19, STATION ROAD, MARCH



REF. NO. M4877

19, STATION ROAD, MARCH



REF. NO. M4877

19, STATION ROAD, MARCH



REF. NO. M4877

19, STATION ROAD, MARCH

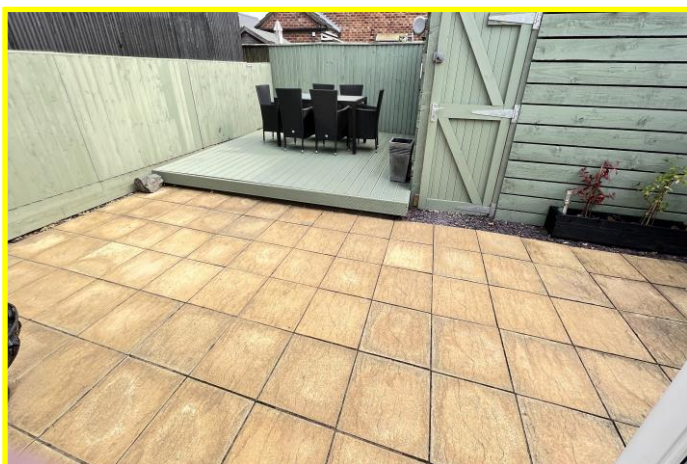

Ground Floor

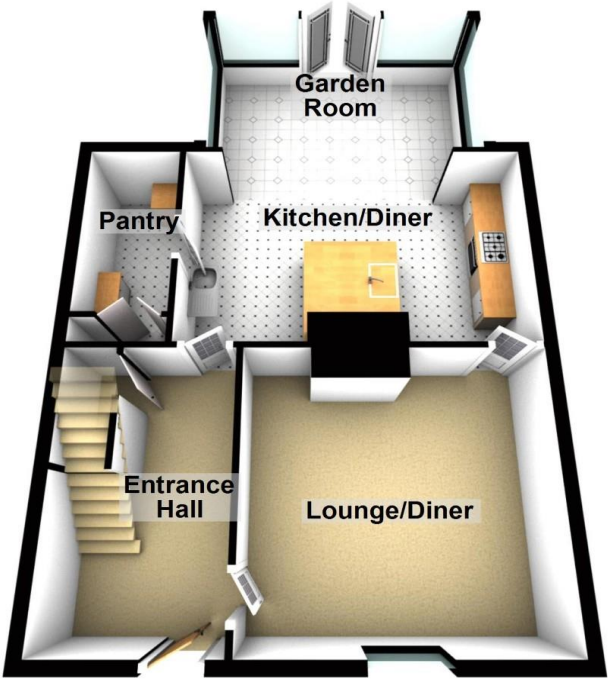

First Floor

