

**ROBERT  
HALE  
HOMES FOR  
SALE**

6, Wheel Centre, Broad St.,  
March, Cambs. PE15 8TX

**MARCH**

**01354 652785**

E-mail:

march@robert-hale-homes.co.uk

Website:

www.robert-hale-homes.co.uk

**7 DAYS**

**WISBECH 465222**

**MARCH 652785**

**NAEA NETWORK**

**OVER 1000 OFFICES**



**28 ST JOHNS ROAD  
MARCH  
PE15 8RJ**

**THE PROPERTY**

DECEPTIVE, THREE BEDROOMED SEMI-DETACHED HOUSE  
SITUATED WITH EASY ACCESS BOTH TO THE TOWN CENTRE AND  
RAILWAY STATION! \* 24 FT LOUNGE/DINER KITCHEN  
\* POTENTIAL OFF ROAD PARKING \* REAR GARDEN OVER 100FT!  
\* REFURBISHED SHOWER ROOM/W.C. \* GAS FIRED CENTRAL  
HEATING \* DOUBLE GLAZING \* VIEW NOW!

**PRICE**

**£229,950**

**FREEHOLD**

**EPC BAND D**

**COUNCIL TAX**

**BAND B**

**FENLAND DISTRICT COUNCIL**

**REF. NO. M4844**

**SELLING? FREE, FREE, VALUATIONS!**

For your own peace of mind, always have an independent survey,  
and always test all systems and appliances!  
Items displayed in photographs may not necessarily be included.



**REF. NO. M4844**

**28 ST JOHNS ROAD, MARCH**

**HOW TO GET THERE**

From the Fountain near our March office proceed along Station Road, then take the second right into St Johns Road. The property is on the left hand side in due course.

**THE ACCOMMODATION**

(Dimensions given are approximate only).

**REAR ENTRANCE HALL**

**LOUNGE/DINER/KITCHEN**

24' 5" (max) x 12' 7" (max) with feature square arch, feature exposed open fireplace, built in gas oven with electric grill, electric hob hood, preparation surfaces with drawers and cupboards under, inset stainless steel single drainer 1½ bowl sink unit with mixer tap and cupboards under, range of wall cupboards, fitted dresser unit with illuminated display cupboard, central heating programmer, stairway off.

**GROUND FLOOR SHOWER ROOM/W.C.**

with under floor heating, tiled and screened shower cubicle with chrome shower valve and spray, integrated low level w.c., integrated hand washbasin with mixer tap and cupboards under, fitted store cupboards, part tiled walls, extractor fan, heated towel rail.

**FIRST FLOOR**

**LANDING**

with access to loft, built in airing cupboard housing hot water cylinder, central heating thermostat.

**BEDROOM NO. 1**

12' 6" (max) x 12' (max).

**BEDROOM NO. 2**

12' (max) x 6' 8" (max).

**BEDROOM NO. 3**

8' 7" (max) x 7' 7" (max) with Potterton gas fired wall mounted central heating boiler.

**OUTSIDE**

**TIMBER WORKSHOP** (with power and lighting).

**GARDENS**

to front down to a shingle potential possible off road parking space. Timber gate to side opens on to a pathway leading to the very long garden (in excess of 100 ft – subject to measured survey) with numerous trees, shrubs, beds, borders, etc.



REF. NO. M4844

28 ST JOHNS ROAD, MARCH





**Ground Floor**

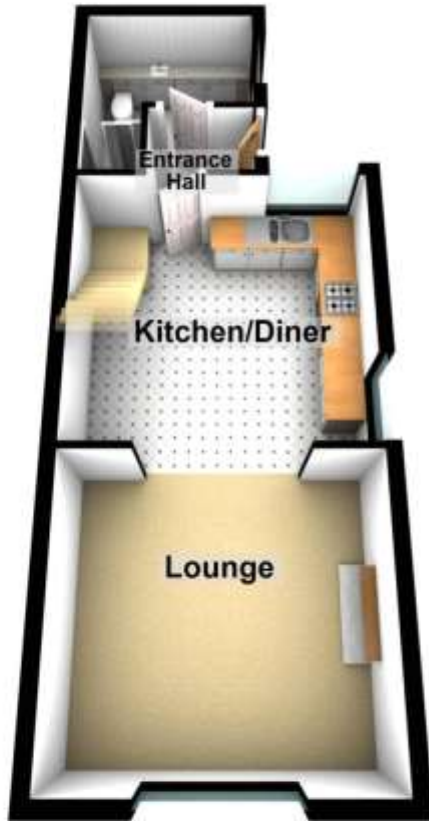

**First Floor**

