

**ROBERT  
HALE  
HOMES FOR  
SALE**

Falcon House, Falcon Road,  
Wisbech, Cambs. PE13 1AU  
**WISBECH**

**01945 465222**

E-mail:  
wisbech@robert-hale-homes.co.uk

Website:  
www.robert-hale-homes.co.uk

**7 DAYS**

**WISBECH 465222**

**MARCH 652785**

**NAEA NETWORK**

**OVER 1000 OFFICES**



**6, PALMERS PLACE  
WISBECH  
PE13 2AJ**

**THE PROPERTY:** THREE BEDROOMED DETACHED HOUSE SITUATED VERY CLOSE TO THE TOWN CENTRE \* FITTED KITCHEN WITH BUILT IN OVEN & HOB \* USEFUL GROUND FLOOR CLOAKROOM/W.C. \* COURTYARD GARDEN TO REAR \* PUBLIC PARKING NEARBY \* GAS FIRED CENTRAL HEATING \* DOUBLE GLAZING \* IDEAL FIRST TIME BUY OR INVESTMENT AS A BUY TO LET! \* VIEW QUICKLY!

**THE PRICE:**            **£215,000**            **FREEHOLD EPC BAND B**            **REF. 8823**

**SELLING? FREE, FREE, VALUATIONS!**

For your own peace of mind, always have an independent survey,  
and always test all systems and appliances!  
Items displayed in photographs may not necessarily be included.



**REF. 8823 6, PALMERS PLACE, WISBECH, PE13 2AJ**

**COUNCIL TAX: BAND B FENLAND DISTRICT COUNCIL**

**HOW TO GET THERE:** From the Wisbech office turn right onto the A1101 dual carriageway Downham Market Road. Follow the road to the next set of traffic lights and turn left into Norwich Road. Then first left into King Street. Proceed to the end of King Street and turn left. Then turn first left and proceed to the end of the road. The property is facing you.

**THE ACCOMMODATION:** (Dimensions given are approximate only)

**ENTRANCE HALL:** With stairway off, built in store cupboard.

**LOUNGE/DINER:** 16' (max) x 9' 4" (max) With double glazed french doors rear garden;-

**FITTED KITCHEN/DINER:** 15' 1" (max) x 9' 5" (max) With laminate floor, range of wall cupboards, inset 1 ½ bowl single drainer sink unit with mixer tap & cupboards under, preparation surfaces with drawers & cupboards under, built in electric oven, built in electric hob, electric hob hood, cupboard housing Baxi gas fired wall mounted combi boiler.

**GROUND FLOOR CLOAKROOM/W.C.:**  
With low level W.C., pedestal wash basin and mixer tap with tiled splash back.

**FIRST FLOOR:**

**LANDING:** With access to loft.

**SPACIOUS BATHROOM/SHOWER ROOM/W.C.:**  
With tiled floor, part tiled walls, heated towel rail, Quadrant shower cubicle with Thermostatic shower, pedestal wash basin with mixer tap, low level W.C., panelled bath with mixer tap, extractor fan.

**BEDROOM NO 1:** 10' (max) x 8' 10" (max).

**BEDROOM NO 2:** 9' 6" (max) x 7' 5" (max).

**BEDROOM NO 3:** 9' 5" (max) x 7' 7" (max).

**OUTSIDE:**

**GARDENS:** Courtyard garden to rear, down to slate chippings. Public parking nearby.



REF. 8823 6, PALMERS PLACE, WISBECH, PE13 2AJ



**Ground Floor**

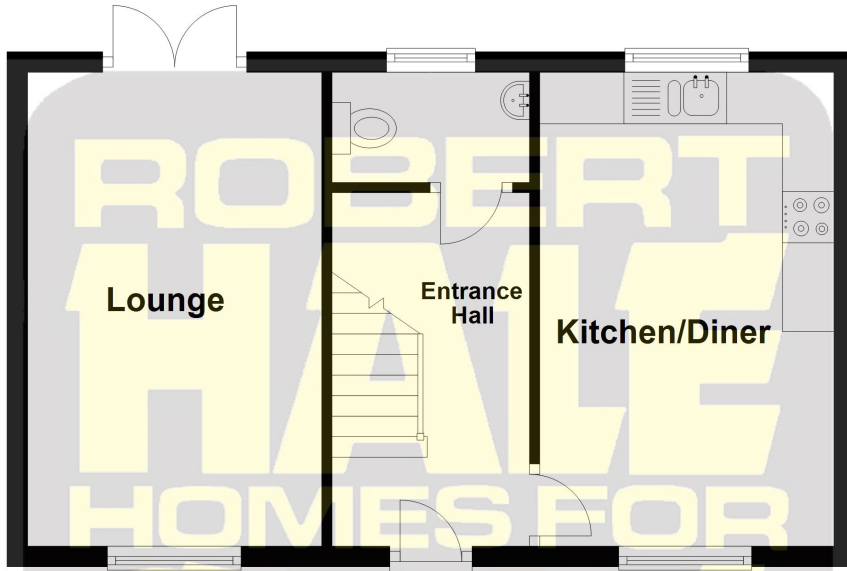

**First Floor**

