

19 Greenford Avenue, Hanwell, London, W7 1LD
020 8567 3219



Freehold / House - Semi-Detached

56, St. Marks Road

£799,950

An exceptionally spacious three bedroom Victorian semi-detached house with a large garden, off street parking, a large basement and potential for extensions in sought after Old Hanwell.

- Semi Detached
- Three Bedrooms
- Two Reception Rooms
- Double Glazed
- Central Heating
- Off Street Parking
- Large Basement
- Good Size Garden



Freehold / House - Semi-Detached

St. Marks Road, W7 2PW

£799,950

An opportunity to purchase this attractive semi-detached Victorian house, which offers bright and spacious accommodation with two reception rooms, a good size fitted kitchen and bathroom, plus from the entrance hall, stairs down to a good size basement

Upstairs there are three bedrooms and access to the large loft space providing scope to create a loft conversion. Features include gas central heating, double glazing and wooden shutters to the front. Outside is a large garden mainly laid to lawn with side access offering ample space for a garden office/studio to the rear and potential for a wrap around side return (subject to the usual planning consents). To the front is valuable off street parking.

Conveniently located on this wide residential road in ever popular Old Hanwell within a few minutes walk of Sandy Park, good local pubs and canal side walks. Both Boston Manor Piccadilly Line and Hanwell Elizabeth Line stations are within easy reach and the house is within catchment for well regarded primary and secondary schools.



19 Greenford Avenue, Hanwell, London, W7 1LD
020 8567 3219



56 St Marks Road W7 2PW

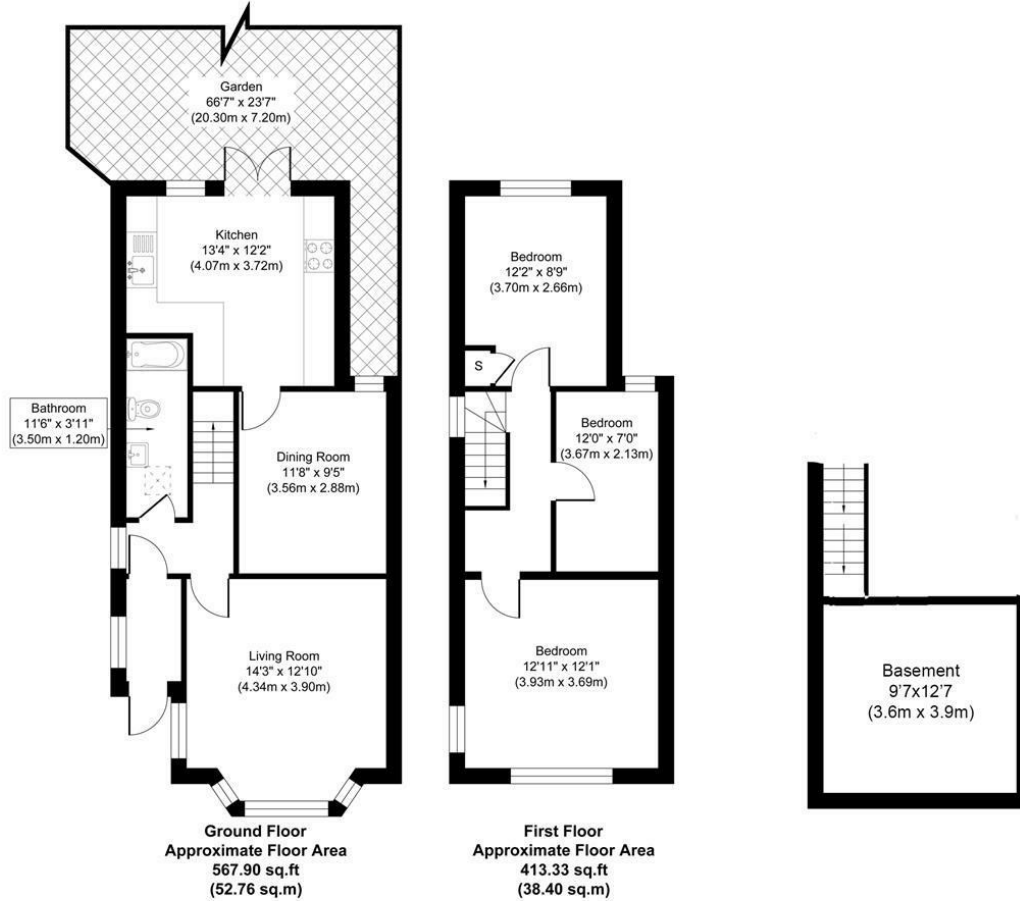
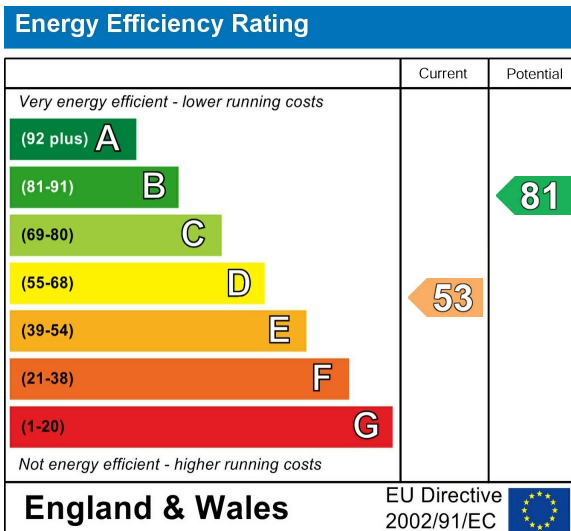

Illustration for identification purposes only, measurements are approximate, not to scale.
produced by jcphotographystudio.com

Council Tax Band

E

Energy Performance Graph



Call us on

020 8567 3219

hanwellsales@sintonandrews.co.uk

www.sintonandrews.co.uk

Agents Note: Whilst every care has been taken to prepare these particulars, they are for guidance purposes only. All measurements are approximate and are for general guidance purposes only and whilst every care has been taken to ensure their accuracy, they should not be relied upon and potential buyers are advised to recheck the measurements.