

19 Greenford Avenue, Hanwell, London, W7 1LD  
020 8567 3219



**Freehold / House - Terraced**

**71, Homefarm Road**  
**£520,000**

A 1930's built mid terrace house with two double bedrooms, which offers the potential for extensions, well located within walking distance of Hanwell Elizabeth Line station. Attractively offered chain free.

- Double Glazing
- Gas Central Heating
- Good Size Garden
- Two Double Bedrooms
- Potential For Extensions
- Potential Off Street Parking
- Close to Elizabeth Line
- Chain Free





**Freehold / House - Terraced**

## Homefarm Road, W7 1NL

£520,000

This solid 1930's red brick terrace house offers light and airy accommodation, including a bright living room, fitted eat in kitchen, two double bedrooms and a first floor bathroom. Features include gas central heating and double glazing, further improvements would be beneficial. Offering potential to extend to the rear and into the loft (subject to the usual permissions) plus with a good size rear garden, at the front the deep garden also offers space for off street parking. This property is offered with no onward chain.

Conveniently located on the ever popular 'Cuckoo Estate', close to local shops and eateries, with regular bus services and within a short walk of both Castlebar and Hanwell Stations. The green open spaces of Brent Lodge (Bunny Park) and Golf course are also close by.





### 71 Homefarm Road W7 1NL

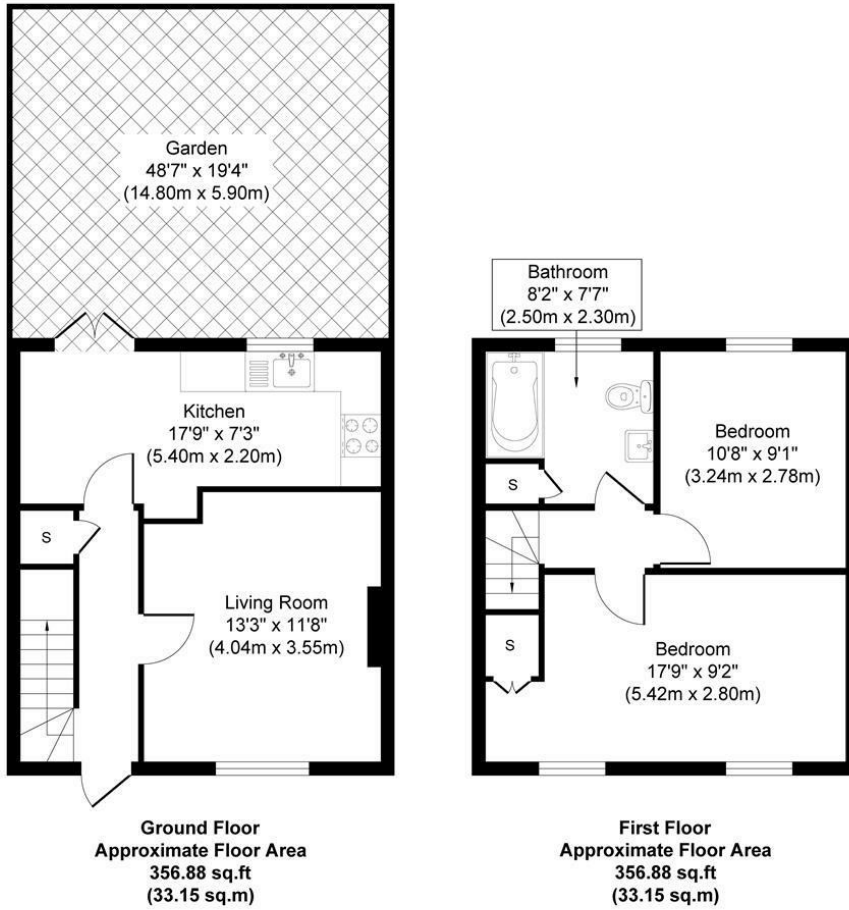

Approximate Gross Internal Floor Area 713.77 sq. ft / 66.31 sq. m  
Illustration for identification purposes only, measurements are approximate, not to scale.  
produced by jcphotographystudio.com

Council Tax Band

D

Energy Performance Graph

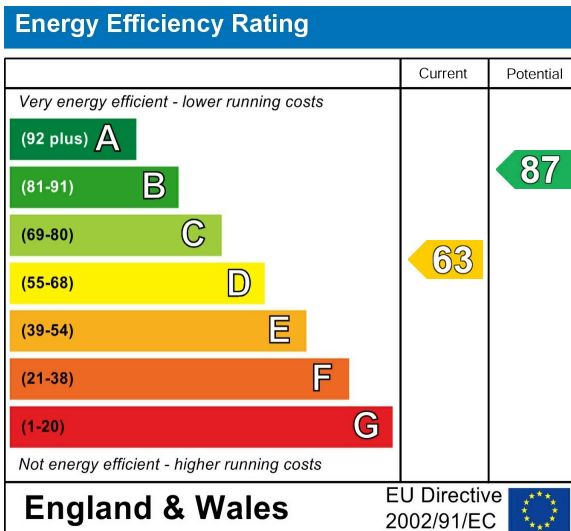

Call us on

**020 8567 3219**

[hanwellsales@sintonandrews.co.uk](mailto:hanwellsales@sintonandrews.co.uk)

[www.sintonandrews.co.uk](http://www.sintonandrews.co.uk)

Agents Note: Whilst every care has been taken to prepare these particulars, they are for guidance purposes only. All measurements are approximate and are for general guidance purposes only and whilst every care has been taken to ensure their accuracy, they should not be relied upon and potential buyers are advised to recheck the measurements.