

84 Northfield Avenue, London, W13 9RR

020 8840 5151



Freehold / House - Terraced

Regina Terrace

£965,000

Located on a quiet side street close to Crossrail and Northfield Avenue, this fully extended four-bedroom Edwardian mid-terrace house is presented in excellent condition throughout.

- Four bedrooms
- Downstairs WC
- Open-plan kitchen/diner
- Close to Elizabeth Line
- Edwardian house
- Fully extended



Freehold / House - Terraced

Regina Terrace, W13 9HY

£965,000

This period house is arranged over three floors and is located in an extremely convenient location close to Crossrail and Northfield Avenue.

The ground floor comprises a front reception room with a large bay window, a fabulous kitchen/family room equipped with the very best appliances/fittings and bi-folding doors opening onto a secluded and pretty rear garden. The very useful downstairs cloakroom completes the ground floor.

Up onto the first floor there are two double bedrooms with built in wardrobes and a modern family bathroom. The loft has been converted creating a two further bedrooms, a 'Jack & Jill' shower room and plenty of additional storage space.

Regina Terrace is ideally placed between Northfield Avenue and West Ealing Broadway, with their busy shops, café bars, restaurants, Northfields Piccadilly Line Station and West Ealing (Elizabeth Line) Mainline Station.



Regina Terrace

Approximate Gross Internal Area = 121.1 sq m / 1303 sq ft

Reduced Headroom = 5.8 sq m / 62 sq ft

Total = 126.9 sq m / 1365 sq ft

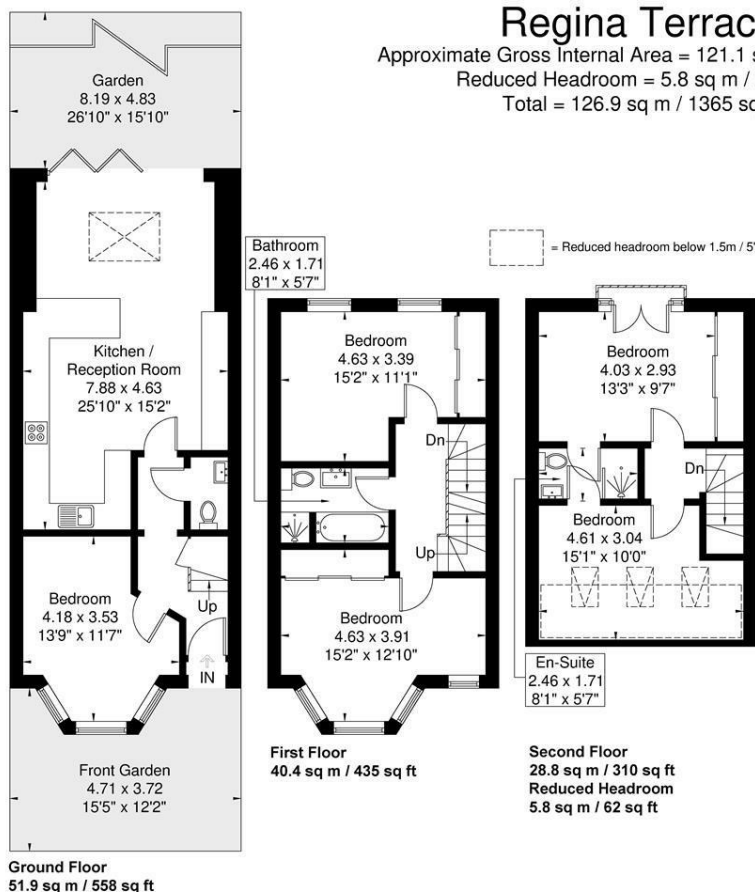

Although every attempt has been made to ensure accuracy, all measurements are approximate. The floorplan is for illustrative purposes only and not to scale.

© www.perspective.co.uk

Energy Performance Graph

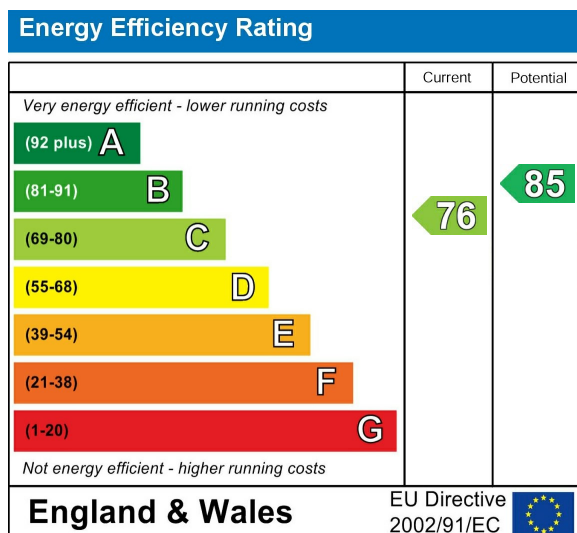

Call us on

020 8840 5151

northfieldsales@sintonandrews.co.uk

www.sintonandrews.co.uk

Agents Note: Whilst every care has been taken to prepare these particulars, they are for guidance purposes only. All measurements are approximate and are for general guidance purposes only and whilst every care has been taken to ensure their accuracy, they should not be relied upon and potential buyers are advised to recheck the measurements.