

84 Northfield Avenue, London, W13 9RR

020 8840 5151



Share of Freehold / Apartment

Darwin Road

£500,000

A smart two double bedroom ground floor apartment with a South facing garden, offered with a share of freehold and no onward chain.

- Two double bedrooms
- Period features
- South facing garden
- Chain free
- Good condition throughout
- Excellent schools and transport links



Share of Freehold / Apartment

Darwin Road, W5 4BD

£500,000

This characterful period conversion features two generous double bedrooms, a lounge with built in shelving and storage and a beautiful fireplace, a smart modern kitchen, bathroom with separate walk in shower and a South facing garden.

On this residential enclave known as 'Little Ealing' just a moments walk from Little Ealing, Mount Carmel and Ealing Fields schools and well placed for the local shops, café bars, restaurants and Piccadilly Line stations of South Ealing and Northfields.



84 Northfield Avenue, London, W13 9RR

020 8840 5151



10 Darwin Road, W5 4BD

Approximate Gross Internal Area
57.80 sq m / 622 sq ft

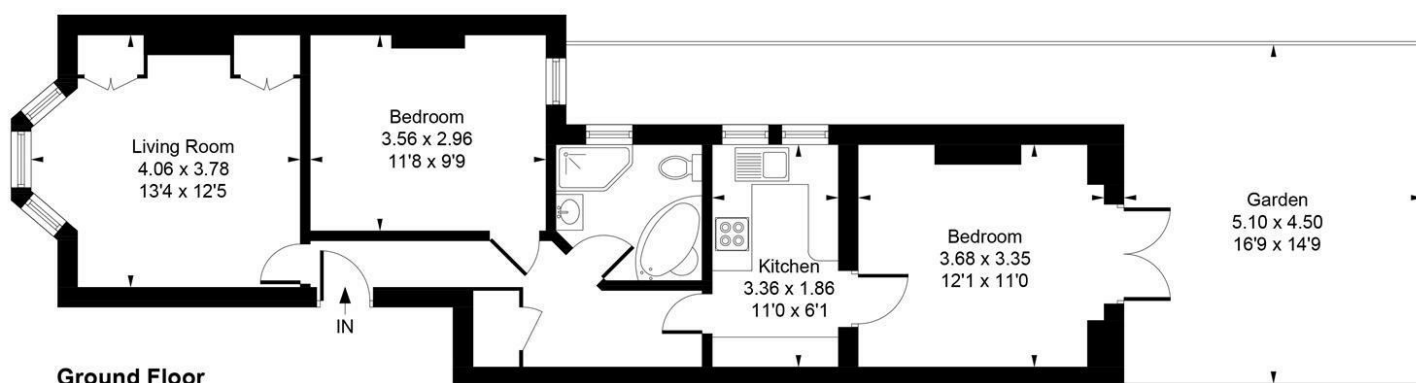

Whilst every attempt has been made to ensure the accuracy of the floor plan contained here, measurements of doors, windows, rooms and any other items are approximate and no responsibility is taken for any error, omission, or mis-statement. This plan is for illustrative purposes only and should be used as such by any prospective purchase.

Produced by jcphotographystudio.com

Energy Performance Graph

Energy Efficiency Rating

| | Current | Potential |
|---|-------------------------|-----------|
| Very energy efficient - lower running costs | | |
| (92 plus) A | | |
| (81-91) B | | |
| (69-80) C | 73 | 78 |
| (55-68) D | | |
| (39-54) E | | |
| (21-38) F | | |
| (1-20) G | | |
| Not energy efficient - higher running costs | | |
| England & Wales | EU Directive 2002/91/EC | |

Call us on

020 8840 5151

northfieldsales@sintonandrews.co.uk

www.sintonandrews.co.uk

Agents Note: Whilst every care has been taken to prepare these particulars, they are for guidance purposes only. All measurements are approximate and are for general guidance purposes only and whilst every care has been taken to ensure their accuracy, they should not be relied upon and potential buyers are advised to recheck the measurements.