

84 Northfield Avenue, London, W13 9RR

020 8840 5151



Leasehold / Apartment

133 Northcroft Road

£210,000

A one bedroom top floor apartment in excellent condition in this sought after purpose built retirement block exclusively for the over 55's

- Retirement apartment for over 55's
- Close to local shops and transport links
- Lift service
- Residents parking
- Communal gardens
- Laundry room



Leasehold / Apartment

133 Northcroft Road, W13 9TA

£210,000

This bright and spacious top floor apartment offers a good size living room, a double bedroom, modern fitted kitchen and bathroom. The property also includes gas central heating and double glazing. The complex benefits from a communal lounge and laundry room, lift service, warden service, communal gardens and off-street parking. Offered chain free.

Northcroft Road is a short walk to the local shops, café bars and restaurants on Northfield Avenue along with the Piccadilly Line tube station and excellent bus services. Walpole, Lammas and Blondin Parks are also close by.



Mayo Court, Northcroft Road

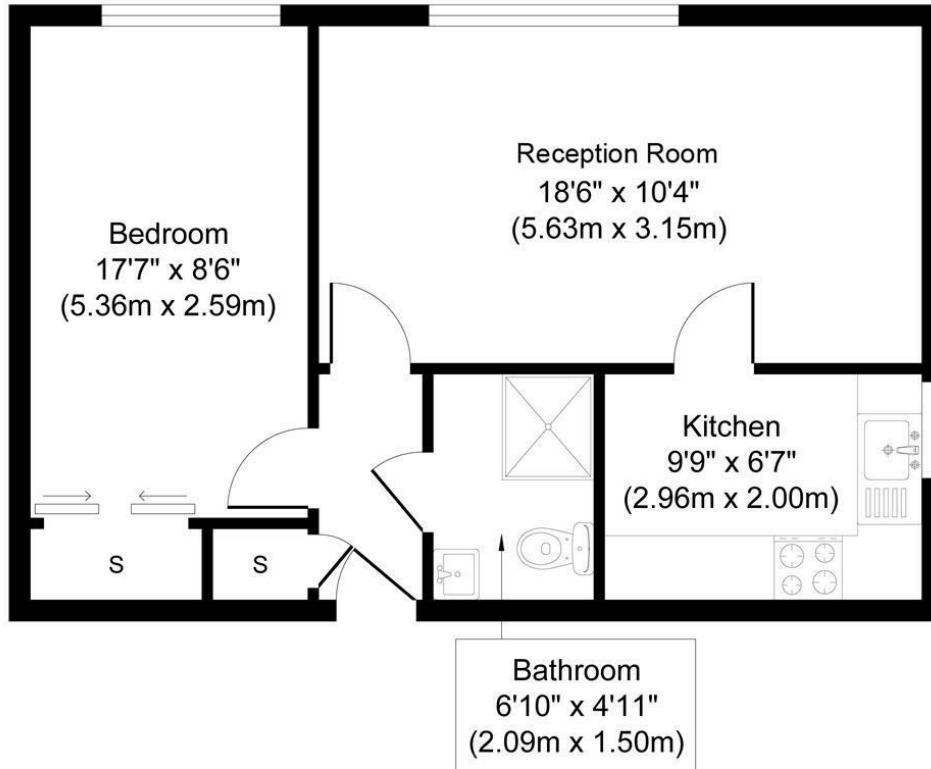

Approximate Gross Internal Floor Area 480.01 sq. ft / 44.59 sq. m

Illustration for identification purposes only, measurements are approximate, not to scale.
produced by jcphotographystudio.com

Energy Performance Graph

Energy Efficiency Rating		Current	Potential
Very energy efficient - lower running costs			
(92 plus) A			
(81-91) B			
(69-80) C		75	76
(55-68) D			
(39-54) E			
(21-38) F			
(1-20) G			
Not energy efficient - higher running costs			
England & Wales	EU Directive 2002/91/EC		

Call us on

020 8840 5151

northfieldsales@sintonandrews.co.uk

www.sintonandrews.co.uk

Agents Note: Whilst every care has been taken to prepare these particulars, they are for guidance purposes only. All measurements are approximate and are for general guidance purposes only and whilst every care has been taken to ensure their accuracy, they should not be relied upon and potential buyers are advised to recheck the measurements.