

84 Northfield Avenue, London, W13 9RR

020 8840 5151



**Freehold / House - Terraced**

**Windermere Road**

**£995,000**

A fully extended Edwardian house with a South facing garden, brimming with character and moments from Lammas and Walpole Parks.

- Fully extended
- Pretty South facing garden
- Excellent local schools
- Close to Lammas and Walpole parks
- Good transport links







**Freehold / House - Terraced**

## Windermere Road, W5 4TJ

£995,000

Arranged over three floors this three bedroom Edwardian house has been sympathetically refurbished and extended creating a wonderful family home. On the ground floor the property features a front reception room, a very useful cloakroom and the entire rear of the house has been opened up creating a wonderful kitchen/diner/family room with French doors opening onto a well stocked South facing sun-trap garden.

Up on the first floor there are two good size bedrooms and a family bathroom and the loft has been crafted to offer a master suite comprising bedroom with en-suite shower room and plenty of storage.

Windermere Road is situated in a sought-after family friendly neighbourhood close to shops, transport links, parks and excellent local schools. Northfields and South Ealing Piccadilly Line Stations are just a few hundred metres away, with quick access to both Heathrow and Central London. There is also easy access for motorists to the nearby A4/M4.



Windermere Road, W5

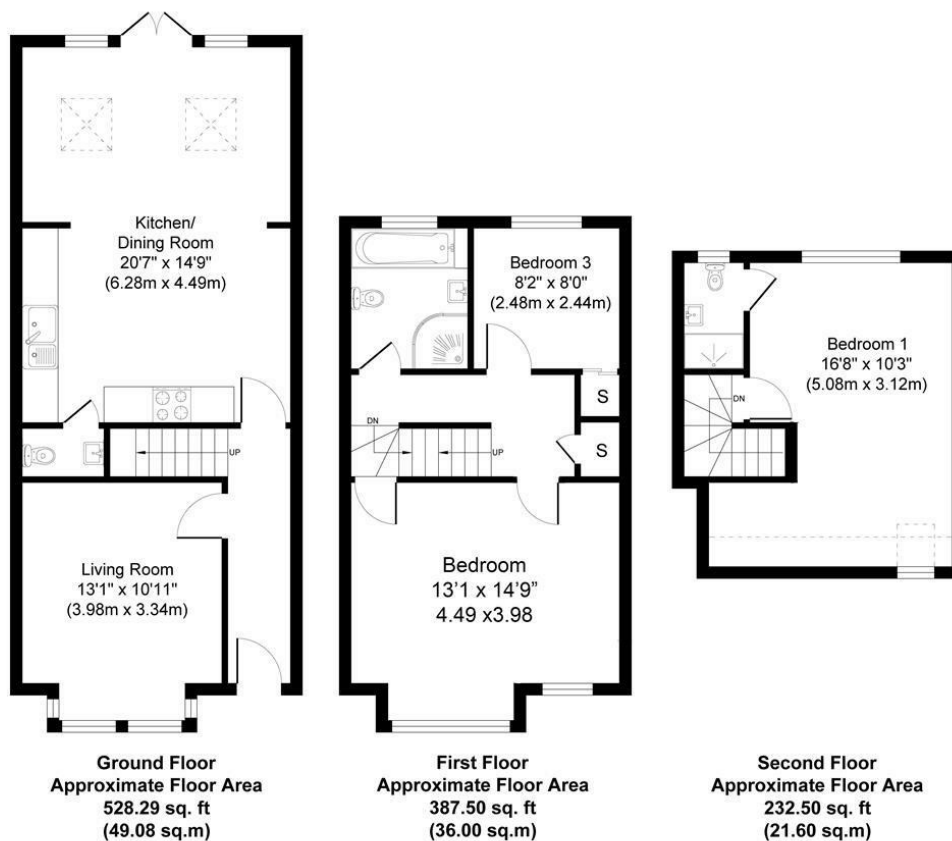

Approximate Gross Internal Floor Area 1148.29 sq. ft /106.68 sq. m

Illustration for identification purposes only, measurements are approximate, not to scale.  
 produced by jcphotographystudio.com

Energy Performance Graph

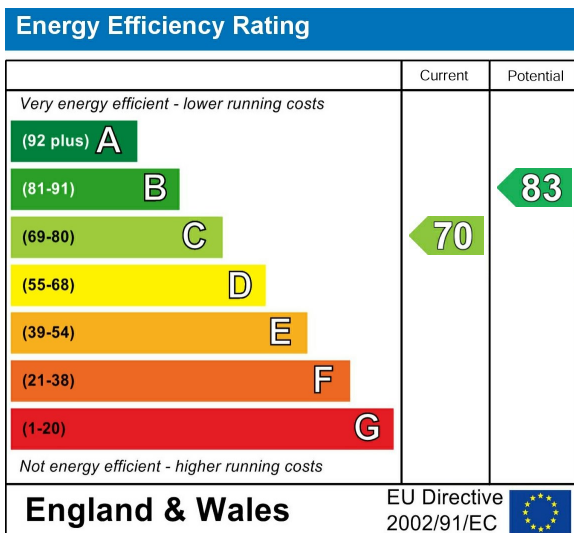

Call us on

020 8840 5151

northfieldsales@sintonandrews.co.uk

www.sintonandrews.co.uk

Agents Note: Whilst every care has been taken to prepare these particulars, they are for guidance purposes only. All measurements are approximate and are for general guidance purposes only and whilst every care has been taken to ensure their accuracy, they should not be relied upon and potential buyers are advised to recheck the measurements.