



1 Onyx Close, Poulton-le-Fylde,  
Lancashire, FY6 7YF

**£365,000**

**\*\*\* STUNNING 'NEW BUILD' HOME with many UNIQUE FEATURES \*\*\***

This stunning property, built circa 2024, combines modern elegance with unique touches that set it apart. Boasting four generously sized double bedrooms, two of which have been thoughtfully converted into a dressing room and a versatile second office, this home offers unparalleled versatility. In addition to the family bathroom, the master bedroom benefits from a private en-suite, while a convenient ground-floor WC caters to the rest of the family.

The ground floor is a masterpiece of contemporary open-plan living, featuring a spacious and stylish dining kitchen. This area seamlessly integrates dining and secondary living spaces, enhancing the sense of openness and flow, and complementing the main lounge and dedicated study.

Externally, the property is equally impressive. Situated on a desirable corner plot, it enjoys panoramic views over grassland, with a scenic outlook towards the rear of Little Poulton Lane. The property also includes a larger double garage and ample additional parking for convenience.

This exceptional home is a true credit to its current owners, who have made thoughtful improvements since their purchase. It's a must-see for anyone seeking a high-quality, modern living space with a touch of individuality.

Successfully selling property since 1948.



**McDonald**

Estate Agents

**Fylde Coast Property Hub**

81-83 Red Bank Road, Bispham, FY2 9HZ



01253 398 498



sales@mcdonaldproperty.co.uk



www.mcdonaldproperty.co.uk



- **FOUR bedrooms**
- **Main lounge**
- **Open Plan Kitchen, Dining and Secondary Living areas**
- **Utility Room**
- **Family Bathroom**
- **En-Suite**
- **Additional WC**
- **Double garage**
- **Additional Parking**
- **Many improvement.**

**Hall:** Staircase, Tiled floor, Double glazed composite front door.

**Lounge:** 12'11" x 10'4" (3.94 m x 3.15 m) Wood effect laminate flooring, UPVC double glazed window with beautiful shutters, Double radiator.

**Study:** 7'8" x 5'9" (2.34 m x 1.75 m) Stylish fitted desk and storage furniture, Wood effect laminate flooring, UPVC double glazed window, Double radiator.

**Dining Kitchen/Second Lounge:** 18'9" x 17'10" (5.71 m x 5.44 m) Beautiful, contemporary open plan design

**Dining Kitchen Area:** Modern range of white high gloss fitted wall and base cupboard units, Complementary worktops with integrated sink 'drainer', Undermount one and a half bowl sink, Built in oven and hob with extractor hood, Dishwasher, Separate breakfast bar and island, Tiled floor, Understairs storage, UPVC double glazed window, Double radiator. Directly open to:-

**Second Lounge Area:** UPVC double glazed patio doors to rear garden, Double radiator.

**Utility Room:** 6'5" x 5'2" (1.96 m x 1.57 m) Fitted wall and base cupboard units, Complementary worktop, Concealed combi gas central heating boiler, Plumbed for washing machine, Double glazed composite rear door.

**Ground Floor WC:** Comprising; Low flush WC, Pedestal wash basin, Half tiled walls, Tiled floor, UPVC double glazed window, Heated towel rail/radiator.





## First Floor:

**Landing:** Built in storage cupboard, Loft access, Radiator.

**Master Bedroom:** 13'4" x 11'8" (4.06 m x 3.56 m) Built in wardrobes, UPVC double glazed window with beautiful fitted shutters, Radiator.

**En-Suite:** Stylish shower room comprising; Large shower cubicle, Pedestal wash basin, Low flush WC, Tiled walls, Heated towel rail/radiator.

**Bedroom 2:** 13'10" x 10'6" (4.22 m x 3.20 m) Fitted wardrobes, Built in storage cupboard, UPVC double glazed window, Radiator.

**Bedroom 3:** 10'3" x 9'1" (3.12 m x 2.77 m) Fitted wardrobes, UPVC double glazed window, Radiator.

**Bedroom 4:** 9'9" x 9'0" (2.97 m x 2.74 m) Built in wardrobe plus additional fitted wardrobes, UPVC double glazed window with beautiful fitted shutters, Radiator.

**Bathroom:** Modern three piece suite comprising; Panelled bath with overhead shower and screen, Pedestal wash basin, Low flush WC, Part tiled walls, Heated towel rail/radiator.

## Outside:

**Front:** Lawned with flower bed

**Rear:** Lawned, Paved path, Patio, Stone gravel and 'barked' flower beds.

**Double Garage:** 21'5" x 19'10" (6.53 m x 6.05 m) Larger style detached brick double garage, Separate up and over doors, Double glazed composite side door to rear garden, Light and power. Additional parking in front of the garage.

**Heating:** Gas central heating (NOT TESTED).

**Tenure:** We have been informed that the property is freehold. Prospective purchasers should seek clarification of this from their Solicitors.

**Council Tax:** Band - E £2,855.11 (2025/26)



**Directions:** Take Garstang Road East heading away from Poulton, turn third left into Moonstone Crescent, first left into Sapphire Drive, second left into Topaz Avenue and finally first left into Onyx Close.

**General Disclaimer:** Whilst every care has been taken in the preparation of these details, interested parties should seek clarification from their solicitor and surveyor as their complete accuracy cannot be guaranteed. These particulars do not constitute a contract or part of a contract. **Measurements:** Room dimensions are approximate, with maximum dimensions taken where rooms are not a simple rectangle. Measured into bays and recesses where appropriate. Floorplans are for general guidance and are not to scale.

**Photography:** Images are for representation only and items shown do not infer their inclusion. **Fixtures, Fittings & Appliances:** Unless stated otherwise, these items have not been tested and therefore no guarantee can be given that they are in good working order.

Energy Efficiency Rating		
	Current	Potential
Very energy efficient - lower running costs		
(92 plus) <b>A</b>		94
(81-91) <b>B</b>	85	
(69-80) <b>C</b>		
(55-68) <b>D</b>		
(39-54) <b>E</b>		
(21-38) <b>F</b>		
(1-20) <b>G</b>		
Not energy efficient - higher running costs		

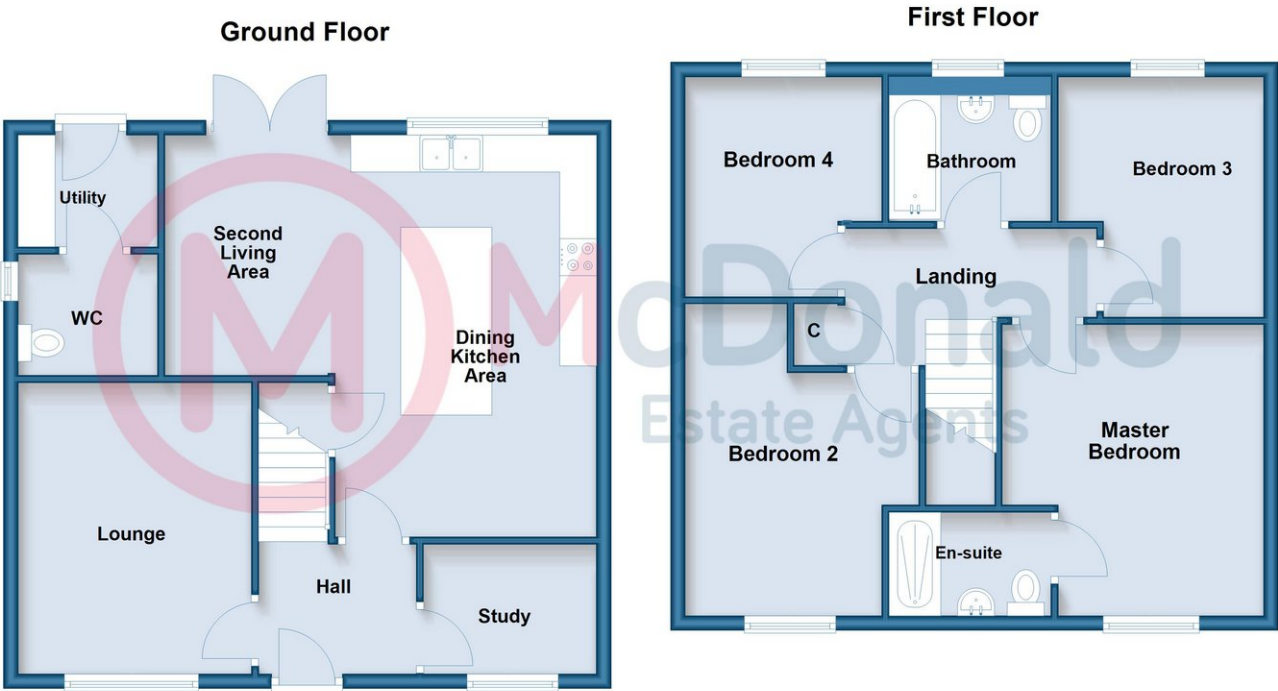

Whilst every care has been taken in the preparation of these details, accuracy cannot be guaranteed. These particulars do not constitute a contract or part of a contract. Room dimensions (where shown) are approximate. Floorplans are for general guidance and are not to scale. Plan produced using PlanUp.

Onyx Close

Are YOU thinking of selling?  
 Call McDonald Estate Agents NOW, for  
 your FREE market appraisal.