



5 Shaftesbury Avenue, Staining,
Blackpool, FY3 8QS

GUIDE PRICE £81,000

***** ATTENTION INVESTORS / DEVELOPERS - AUCTION *****

This end garden terraced house requires further modernisation throughout. However, the property already benefits from the addition of a CONSERVATORY, UPVC double glazing and gas central heating and is located in a very POPULAR LOCATION of STAINING and just 0.8 miles to Victoria HOSPITAL.
No onward chain.

This property is for sale by Modern Method of Auction allowing the buyer and seller to complete within a 56 Day Reservation Period. Interested parties' personal data will be shared with the Auctioneer (iamsold Ltd).

If considering a mortgage, inspect and consider the property carefully with your lender before bidding. A Buyer Information

Pack is provided, which you must view before bidding. The buyer will pay £300 inc VAT for this pack.

The buyer signs a Reservation Agreement and makes payment of a Non-Refundable Reservation Fee of 4.5% of the purchase

price inc VAT, subject to a minimum of £6,600 inc VAT. This Fee is paid to reserve the property to the buyer during the Reservation Period and is paid in addition to the purchase

Successfully selling property since
1948.



McDonald
Estate Agents

Fylde Coast Property Hub

81-83 Red Bank Road, Bispham, FY2 9HZ
01253 398 498



sales@mcdonaldproperty.co.uk
www.mcdonaldproperty.co.uk



- **TWO bedrooms**
- **Lounge**
- **FITTED dining kitchen**
- **UPVC conservatory**
- **Bathroom**
- **Gas central heating**
- **UPVC double glazing**
- **Gardens**
- **Cul De Sac location**
- **No chain.**



Hall: Staircase, Meter cupboard, UPVC double glazed front door.

Lounge: 14'0" x 11'8" (4.27 m x 3.56 m) Feature fireplace, UPVC double glazed bay window.

Dining Kitchen: 14'9" x 8'11" (4.50 m x 2.72 m) Fitted wall and base cupboard units, Complementary roll edge worktops, Understairs storage housing combi gas central heating boiler, Wood effect laminate flooring, UPVC double glazed windows a rear door, Radiator.

Conservatory: 13'4" x 6'2" (4.06 m x 1.88 m) Tiled floor, UPVC double glazed windows and patio doors to the rear garden, Radiator.

First Floor:

Landing:

Bedroom 1: 14'10" x 14'3" (4.52 m x 4.34 m) Built in wardrobe to alcove, UPVC double glazed bay window, Radiator.

Bedroom 2: 8'11" x 8'6" (2.72 m x 2.59 m) Wood effect laminate flooring, UPVC double glazed window, Radiator.

Bathroom: Comprising; Panelled bath with overhead shower and screen, Pedestal wash basin, Low flush WC, Part tiled walls, Tiled floor, UPVC double glazed window, Radiator.

Outside:

Front: With flowered beds

Rear: Grassed, Timber deck, Timber shed, Excellent level of privacy.

Heating: Gas central heating (NOT TESTED).

Tenure: We have been informed that the property is freehold. Prospective purchasers should seek clarification of this from their Solicitors.

Council Tax: () Band - B £1771.04 (2024/25)



Directions: From Whitegate Drive proceed to Devonshire Square and turn right onto Newton Drive, at the roundabout take the second exit onto Newton Drive East, take the fifth right turning into Staining Road and finally second right into Shaftesbury Avenue.

General Disclaimer: Whilst every care has been taken in the preparation of these details, interested parties should seek clarification from their solicitor and surveyor as their complete accuracy cannot be guaranteed. These particulars do not constitute a contract or part of a contract. **Measurements:** Room dimensions are approximate, with maximum dimensions taken where rooms are not a simple rectangle. Measured into bays and recesses where appropriate. Floorplans are for general guidance and are not to scale.

Photography: Images are for representation only and items shown do not infer their inclusion. **Fixtures, Fittings & Appliances:** Unless stated otherwise, these items have not been tested and therefore no guarantee can be given that they are in good working order.

Energy Efficiency Rating		Current	Potential
Very energy efficient - lower running costs			
(92 plus)	A		
(81-91)	B		
(69-80)	C		79
(55-68)	D	62	
(39-54)	E		
(21-38)	F		
(1-20)	G		
Not energy efficient - higher running costs			

Ground Floor

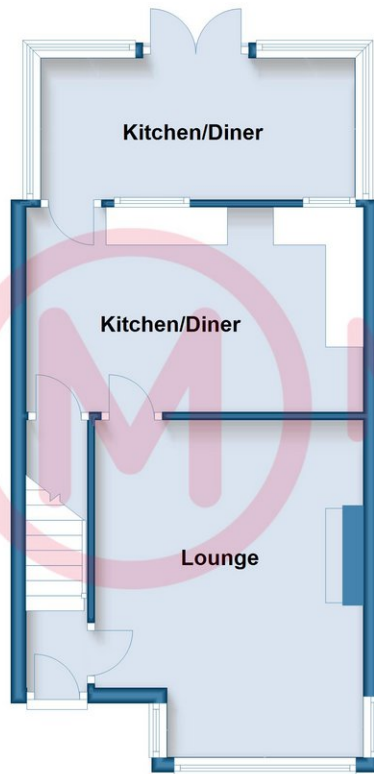

First Floor



Whilst every care has been taken in the preparation of these details, accuracy cannot be guaranteed. These particulars do not constitute a contract or part of a contract. Room dimensions (where shown) are approximate. Floorplans are for general guidance and are not to scale.

Plan produced using PlanUp.

Shaftesbury Avenue

Are YOU thinking of selling?
 Call McDonald Estate Agents NOW, for
 your FREE market appraisal.

Award winning property sales since 1948.

