



Pictures are for illustrative purposes only and do not represent any particular plots.



Plot 22 - North Street, Winterton, North Lincolnshire

£369,950



lovelle

ROMAN MEADOWS



WINTERTON



KEY FEATURES

- 10 Year LABC Guarantee
- Choice of Ceramic Tiles
- Choice of High Quality Kitchens
- High Quality Finish
- Many Security Features as Standard
- LABC Award Winner 2025
- Master Builder Awards – 2023
- Integral Garage
- EPC rating B

DESCRIPTION

The Duchess is a spacious family home designed for modern living, perfectly combining style, comfort, and practicality.

This impressive five-bedroom detached property boasts an integral garage for convenient storage and parking. At its heart is a contemporary open-plan kitchen and dining area, finished to a high standard and ideal for family gatherings or entertaining.

A dedicated study or playroom adds versatility, while generously sized bedrooms and a luxurious en-suite master bedroom make The Duchess a perfect choice for a thriving modern family.

PARTICULARS OF SALE

ENTRANCE HALL

LOUNGE

5.05m x 3.84m (16'7" x 12'7")

KITCHEN DINING AREA:

7.1m x 3.02m (23'4" x 9'11")

FAMILY AREA

4.25m x 3.39m (13'11" x 11'1")

UTILITY ROOM

WC

FIRST FLOOR ACCOMMODATION:

BEDROOM ONE

5.1m x 3.84m (16'8" x 12'7")

EN-SUITE

BEDROOM TWO

4.07m x 2.96m (13'5" x 9'8")

BEDROOM THREE

3.12m x 3.02m (10'2" x 9'11")

BEDROOM FOUR

3.05m x 2.96m (10'0" x 9'8")

FAMILY BATHROOM

SECOND FLOOR ACCOMMODATION:

BEDROOM FIVE

4.37m x 4.06m (14'4" x 13'4")

EN-SUITE

PLAYROOM / STUDY

4.37m x 3.89m (14'4" x 12'10")



From our family, for yours

When brothers Keith and Garry established Keigar Homes in 1994 the philosophy was simple: to build quality homes which feel special for the people who live in them, and to build a successful and sustainable business for the future. In both of these aspects they have succeeded, and today Keigar Homes thrives under the stewardship of Garry and his family.

Family values run right through the core of what we do, and many of our employees, partners and customers have been with us for many years.

In 2021 Keigar Homes was recognised for its longstanding commitment to quality by being awarded National 'Housebuilder of the Year' at the biennial Master Builder Awards.

Garry Whall
Managing Director

Nathan Whall
Director

Bradley Whall
Director

When you're ready for something special...

OUTSIDE THE PROPERTY:

INTEGRAL GARAGE

REAR ELEVATION

The rear garden provides the perfect space for children or pets, being fully enclosed.

SECURITY

All Keigar homes include an electronically fitted alarm system, high specification door and window locks. Smoke alarms to each floor.

ENVIRONMENTAL CREDENTIALS

All Keigar homes have high levels of insulation as standard and are built with the most recent building regulations with, wherever possible natural materials and timber from sustainable sources.

WARRANTY

10 year LABC warranty

TENURE

The tenure of this property is Freehold.

LOCAL AUTHORITY

Council tax band: X

This property falls within the geographical area of North Lincolnshire Council - 01724 276444.

<https://www.northlincs.gov.uk/>

VIEWING

By appointment with the Sole Agent Lovelle Estate Agency, telephone 01652 636587.

We recommend prior to making an appointment to view, prospective purchasers discuss any particular points likely to affect their interest in the property with one of our property consultants who have seen the property in order that you do not make a wasted journey.

HOW TO MAKE AN OFFER

If you are interested in this property then it is important that you contact us at your earliest convenience. We will require certain pieces of personal information from you in order to provide a professional service to you and our client. The personal information you have provided to us may be shared with our client, the seller, but it will not be shared with any other third parties without your consent other than stated reasons detailed within our privacy policy. More information on how we hold and process your data is available on our website <http://www.lovelleestateagency.co.uk/privacy-policy.php> and you can opt out at any time by simply contacting us.

For any offer you wish to make we will need to establish certain details before negotiation can take place. This is so that our vendor can make an informed choice when negotiating and accepting your offer. You will be asked to provide formal I.D. and address verification, as required under new Money Laundering Legislation. You might also have one or two questions for us, such as which solicitor to choose, or which mortgage lender has the best offers available for me. We have a one stop shop to satisfy all of these needs so please ask.

MORTGAGE ADVICE

Budgeting correctly and choosing the right mortgage for a move is vital. For independent mortgage and insurance advice call our mortgage advisor on 01652 636587 to arrange an appointment.

ENERGY PERFORMANCE INFORMATION

A copy of the full Energy Performance Certificate for this property is available upon request. **Advisory Notes** - Please be advised if you are considering purchasing a property for Buy To Let purposes, from 1st April 2018 without an EPC rated E or above it will not be possible to issue a new tenancy, or renew an existing tenancy agreement.

AGENTS NOTE

These particulars are for guidance only. Lovelle Estate Agency, their clients and any joint agents give notice that:-

They have no authority to give or make representation/warranties regarding the property, or comment on the SERVICES, TENURE and RIGHT OF WAY of any property.

These particulars do not form part of any contract and must not be relied upon as statements or representation of fact.

All measurements/areas are approximate. The particulars including photographs and plans are for guidance only and are not necessarily comprehensive.

SKB Estates Limited T/A Lovelle Estate Agency



**Yorkshire and Trent
2023 Winner**

Score	Energy rating	Potential
92+	A	
81-91	B	
69-80	C	
55-68	D	
39-54	E	
21-38	F	
1-20	G	

FLOOR PLANS

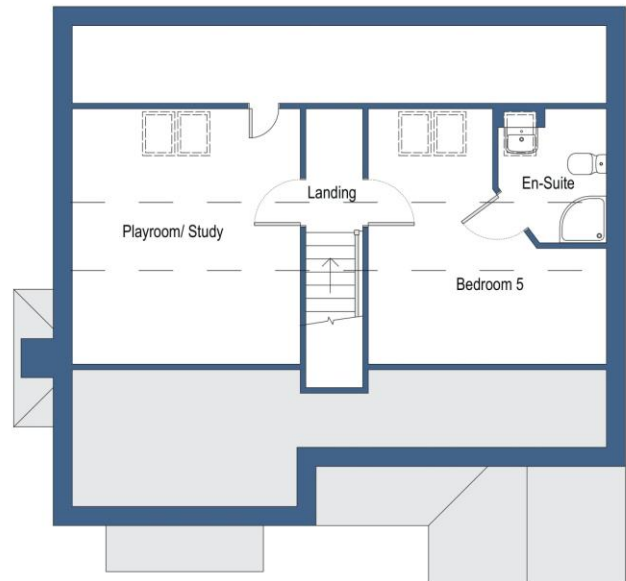

Follow us on:

 [lovellebarton](#)

 [lovellebarton](#)



