



5 The Willows Court Lane, Staple Hill, Bristol, BS16

£1,250 PCM

****FULLY BOOKED****

****PLEASE DO NOT CALL TO BOOK AN APPOINTMENT, PLEASE EMAIL INFO@BRUNTANDFUSSELL.CO.UK WITH THE NAMES AND DETAILS OF EACH TENANT, INCLUDING EMPLOYMENT INFORMATION AND SALARIES TO HELP US ENSURE REFERENCING REQUIREMENTS ARE MET BEFORE VIEWINGS TAKE PLACE.****

Situated a stone's throw from both Page Park and the Bristol to Bath cycle track is this unique penthouse apartment which is sure to appeal to a professional couple or ideal for two sharers. The accommodation comprises stairs rising to landing with open plan living to the front with views towards Lansdown, two double bedrooms, shower room and w/c room. Some of the many benefits include all appliances, double glazing, electric central heating and allocated parking space. Viewing is highly recommended. ****VIRTUAL VIEWING NOT AVAILABLE****

Council Tax Band A. Energy Rating D.

- Penthouse Flat
- Culdesac Location
- Two Double Bedrooms
- Open Plan Living
- All Appliances
- Parking Space

Viewing

Please contact our Brunt & Fussell Ltd Office on 01179566004 if you wish to arrange a viewing appointment for this property or require further information.



2



1



1



Floor Plan

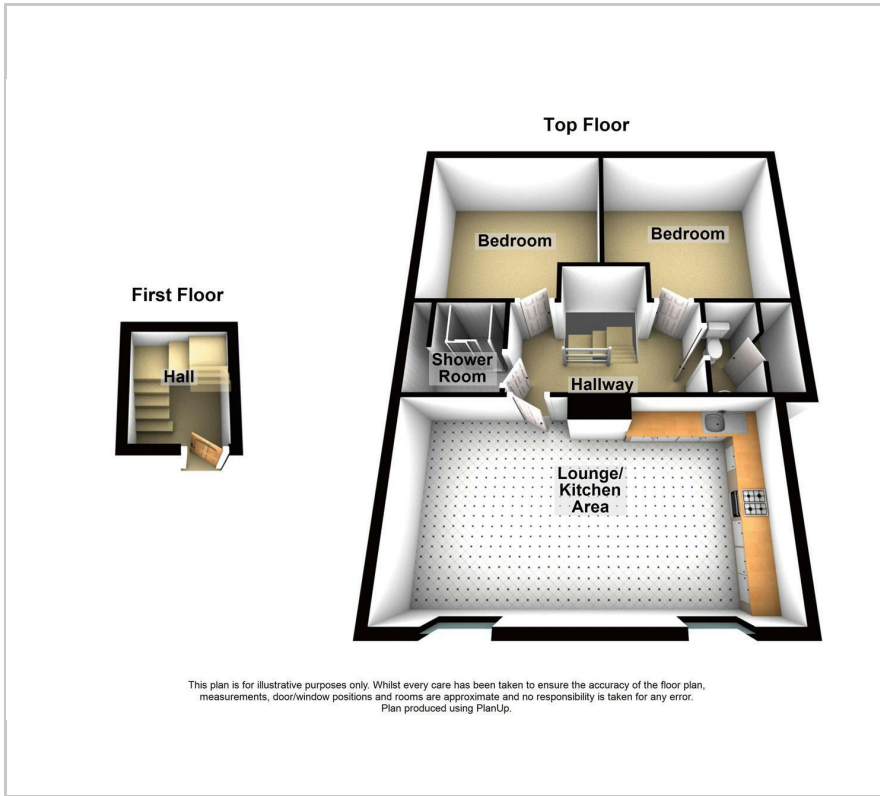

Area Map

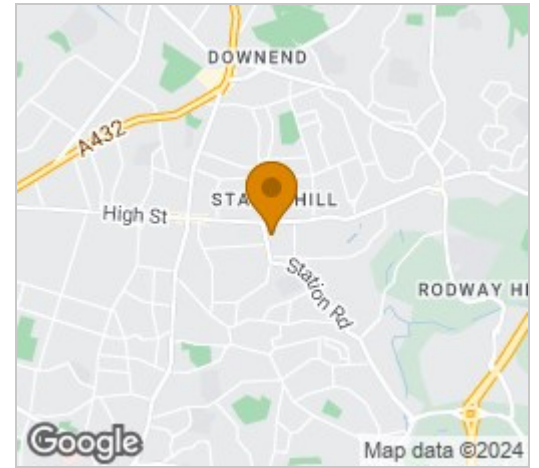

Energy Efficiency Graph

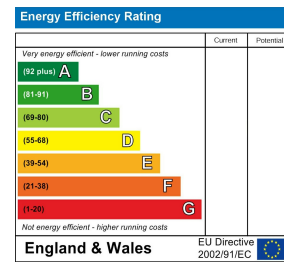

These particulars, whilst believed to be accurate are set out as a general outline only for guidance and do not constitute any part of an offer or contract. Intending purchasers should not rely on them as statements of representation of fact, but must satisfy themselves by inspection or otherwise as to their accuracy. No person in this firm's employment has the authority to make or give any representation or warranty in respect of the property.