



Leap Valley Crescent Downend, BS16 6TQ

£525,000

We are delighted to offer for sale this stunning three bedroom extended semi-detached house with conservatory, generous mature garden, garage and off-street parking. The property is in very good order and has been very well maintained. The accommodation briefly comprises storm porch, hallway, lounge, sitting room, dining room, conservatory, fitted kitchen, three bedrooms and family bathroom. Other benefits include gas central heating and double glazing. Situated on this sought after road close to lovely walks, local amenities, schools, bus routes, and the Bristol to Bath Cycle track. The ring road and motorway network are only a short commute away. Properties of this size and quality rarely come to the market. We therefore recommend an early inspection to avoid disappointment. Council Tax C. Energy Rating C.

- Splendid Extended House
- Three Bedrooms
- Mature Garden
- Sought After Road
- No Chain
- Gas Ch & D/g

Viewing

Please contact our Brunt & Fussell Ltd Office on 01179566004 if you wish to arrange a viewing appointment for this property or require further information.



Floor Plan

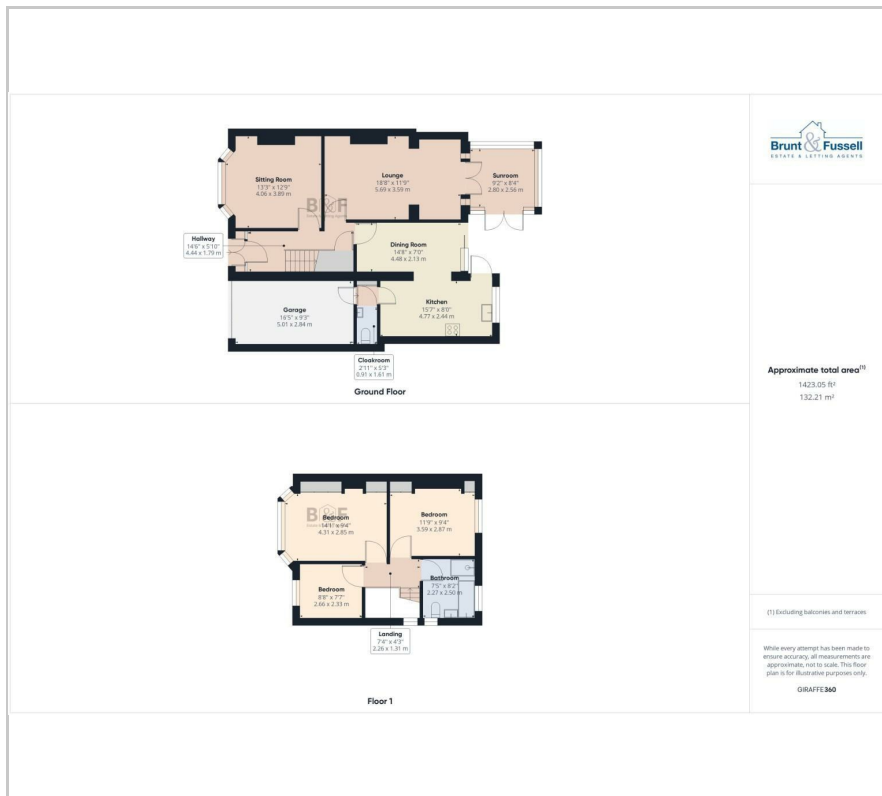

Area Map

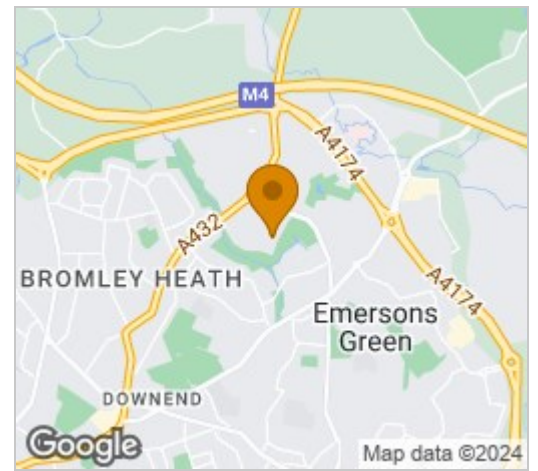

Energy Efficiency Graph

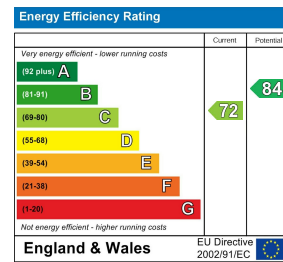

These particulars, whilst believed to be accurate are set out as a general outline only for guidance and do not constitute any part of an offer or contract. Intending purchasers should not rely on them as statements of representation of fact, but must satisfy themselves by inspection or otherwise as to their accuracy. No person in this firm's employment has the authority to make or give any representation or warranty in respect of the property.