



Mitre Court, Horsham, RH12 1SW



A fully furnished luxury apartment with its own private entrance, forming part of an exclusive development, situated in the heart of Horsham town centre.

This spacious property comprises, entrance hall with storage cupboard, bright living room, fitted kitchen/breakfast room with integrated appliances and modern family bathroom with a power shower over the bath. Both bedrooms are doubles the main bedroom benefitting from a large ensuite shower room and fitted mirrored wardrobes.

Other benefits to the property include gas central heating and double glazing. The property is available on a short term basis (9-12 months) from 22nd August 2024.

To the outside of the property are well kept communal gardens and allocated secure parking for one vehicle.

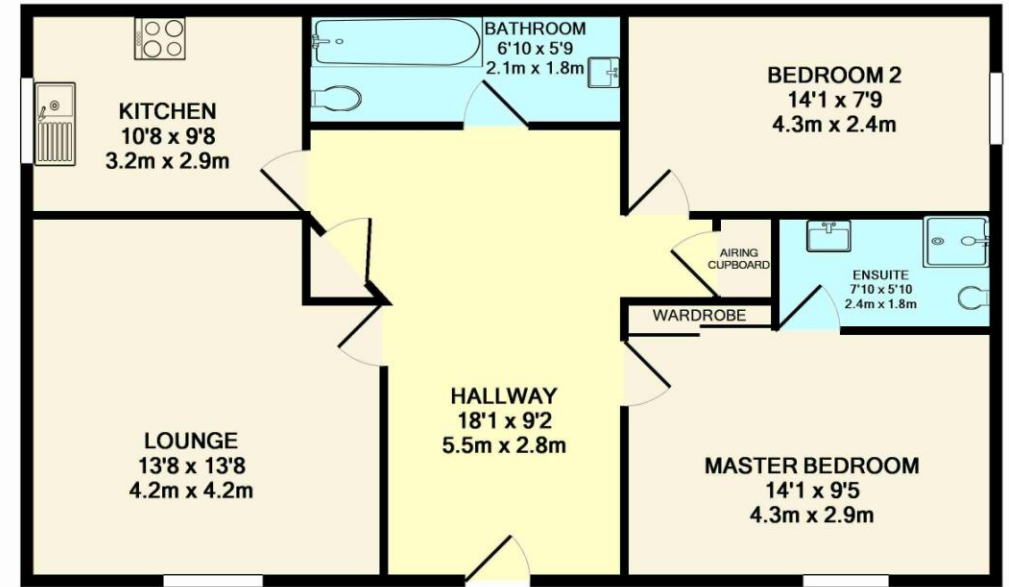

Map Location



EPC Rating

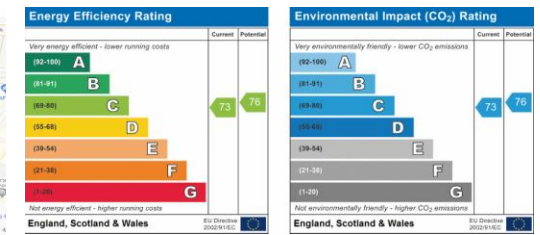

Total Approximate Floor Area

802 sq ft / 75 sq m

Viewing arrangements by appointment through :

Brock Taylor
01403 272002
horshamlettings@brocktaylor.co.uk



Brock Taylor Disclaimer: we would like to inform prospective purchasers that these sales particulars have been prepared as a general guide only. A detailed survey has not been carried out, nor the services, appliances and fittings tested. Room sizes should not be relied upon for furnishing purposes and are approximate. If floor plans are included they are for guidance only and illustration purposes only and may not be to scale. If there are any important matters likely to affect your decision to buy, please contact us before viewing this property.

Residential sales, lettings,
land and new homes.

01403 272002
brocktaylor.co.uk

2-4 East Street, Horsham, West Sussex, RH12 1HL



Buses
1 minute walk



Shops
West Street
3 minute walk



Trains
Horsham
0.8 miles



Sport & Leisure
Pavilions in the Park
0.6 miles



Airport
Gatwick
12.2 miles



Schools
St Mary's Primary
Tanbridge House



Broadband
Up to 67 Mbps



Roads
M23
7.8 miles



Council Tax
Band E