

16, Penn Way,  
Welwyn Garden City,  
AL7 3EF

 2 Bedrooms

 1 Bathroom

 1 Reception Rooms

 Allocated Underground  
Parking Space

 Communal

 EPC Band C

Council Tax  
Band: C £2,037.07 (25/26)

Deposit £1,615.00  
Holding Deposit £323.07

£1,400 PCM

 **ashtons**  
for life's great moves



A recently constructed two double bedroom top floor apartment benefiting from secure allocated parking, heating and hot water are included with the rent.

### Description

This beautifully presented top floor apartment comprises a lounge/dining area with an open plan, well equipped fitted kitchen with integral appliances, There are two double bedrooms and a modern bathroom with a shower over the bath. The property benefits from a security entry phone system and an allocated parking space in a secure underground garage.

### Location

Penn Way is within walking distance to the town centre and its extensive amenities which include John Lewis, Waitrose, Sainsbury and a mainline rail station (London Kings Cross 28 minutes).

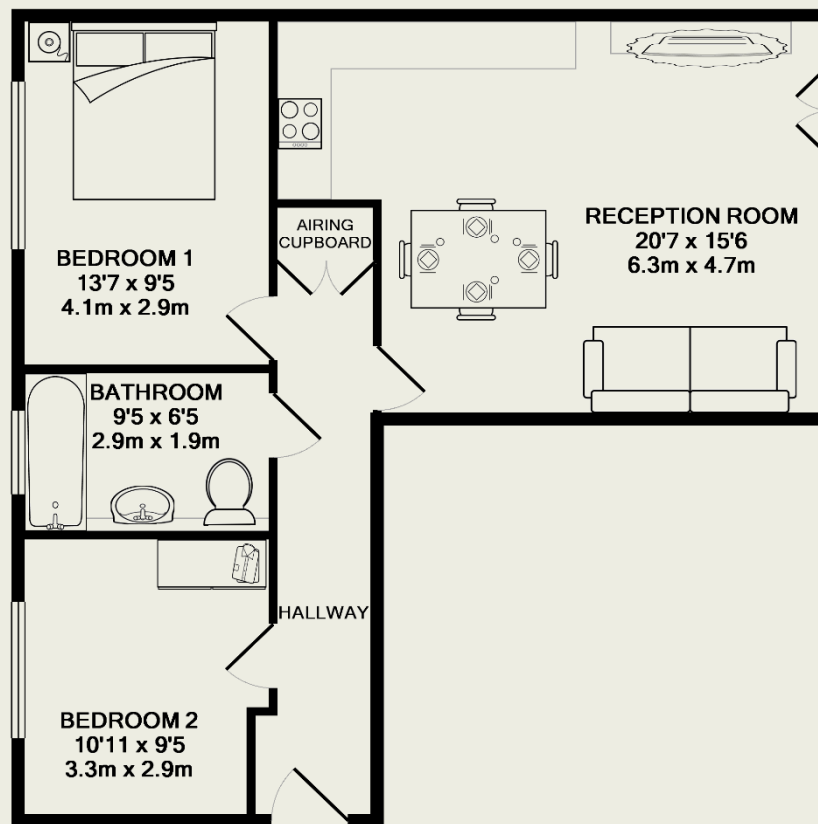

TOTAL APPROX. FLOOR AREA 670 SQ.FT. (62.3 SQ.M.)

This floor plan is for illustrative purposes only.  
The measurement and position of each element is approximate and must be viewed as such.

These particulars do not constitute an offer or contract in whole or part. The statements contained herein are made without responsibility on the part of Ashtons or the vendors and they cannot be relied upon as representatives of fact. In respect of floor plans, these are for illustrative purposes only. The measurement and position of each element is approximate and must be viewed as such. Intending purchasers should therefore satisfy themselves by inspection or otherwise as to their correctness. The vendors do not make or give, and neither Ashtons nor any person in their employment has any authority to make or give, any representation or warranty whatsoever in relation to this property.