



5 Bedrooms



4 Bath/Shower Rooms
1 Cloakroom



3 Reception Rooms



Double Garage + Driveway



Private Rear Garden



EPC Band C

Council Tax

Band G
- £3,959.33 2025-2026

Local Authority
Welwyn/Hatfield



The Runway, Hatfield, Hertfordshire, AL10 9GL
Offers in Excess of £700,000 Freehold

The Runway, Hatfield, Hertfordshire, AL10 9GL

An exceptionally spacious, well-presented 5 bedroom detached family home, with four shower/bath rooms and a double garage.

- Spacious Family Home
- 5 Bedrooms
- 4 Shower/Bathrooms
- Spacious Kitchen/Breakfast Room and Downstairs Cloakroom
- Good Size Living Room and Bright Conservatory
- Short Drive to Mainline Station
- Close to Galleria Shopping Centre

Description

A welcoming entrance hall presents doors to the property's large living room with adjoining dining room, to the generous kitchen/breakfast room and to a conveniently located ground floor cloakroom. A large, bright conservatory stretches across the rear of the property with sliding doors onto the rear patio and lawn beyond.

One especially large bedroom on the first floor benefits from an en-suite shower room and fitted wardrobes. Happily, a second bedroom on this floor also has an en-suite shower room. A large family bathroom with separate shower and a third sizeable bedroom complete the accommodation on this floor.

Two further large bedrooms, one with an en-suite shower room and fitted wardrobes, are located on the second floor.

There is the added benefit of a double garage that has parking for 2-3 cars immediately in front of it.

Location

The Runway is a cul-de-sac turning close to the popular eco-friendly primary school "Howe Dell". Other facilities nearby include the "Next Generation Gym", Galleria Shopping Centre and countryside walks. A short drive away are all major road links - A1(M) motorway - and mainline rail stations - Hatfield to Kings Cross and St Albans - Thames Link service.



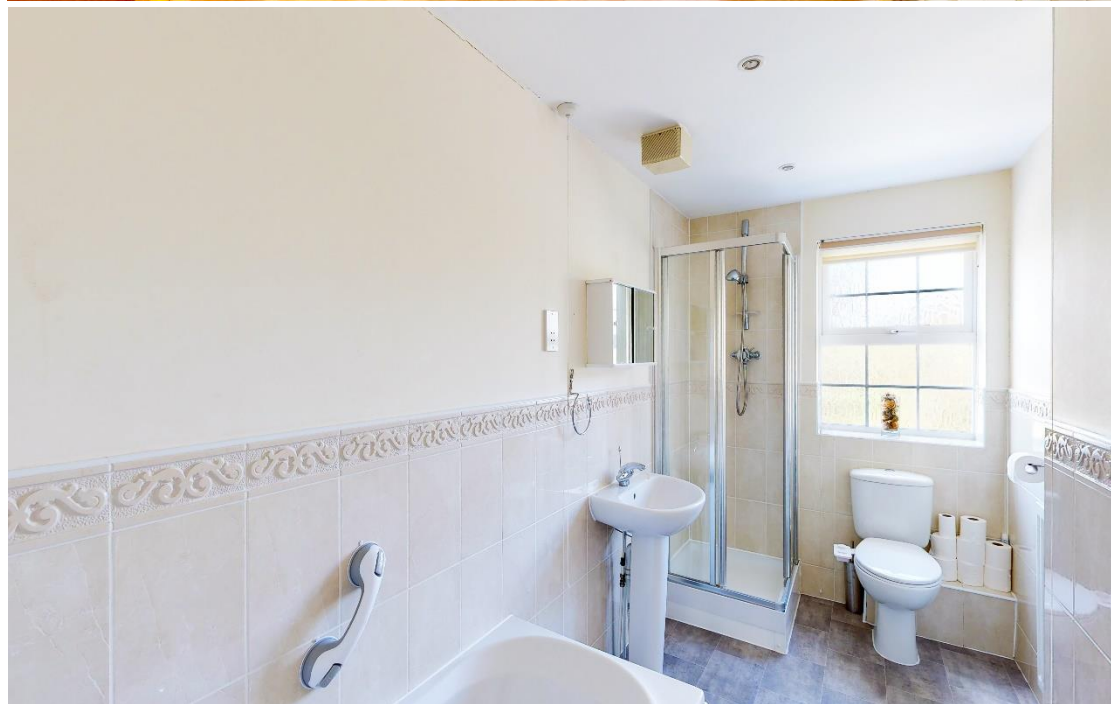

Important Information

These particulars do not constitute an offer or contract in whole or part. The statements contained herein are made without responsibility on the part of Ashtons or the vendors and they cannot be relied upon as representatives of fact. In respect of floor plans, these are for illustrative purposes only. The measurement and position of each element is approximate and must be viewed as such. Intending purchasers should therefore satisfy themselves by inspection or otherwise as to their correctness. The vendors do not make or give, and neither Ashtons nor any person in their employment has any authority to make or give, any representation or warranty whatsoever in relation to this property. We offer a wide range of services through third party providers including solicitors, surveyors, removal firms, mortgage providers and EPC suppliers. We receive additional payments for administering suppliers quoting software and making referrals. You are not under any obligations to use these services and it is your discretion whether you choose to deal with these parties or your own preferred supplier. You should be aware the average payment we received in 2021 equated to £48.36 per referral.

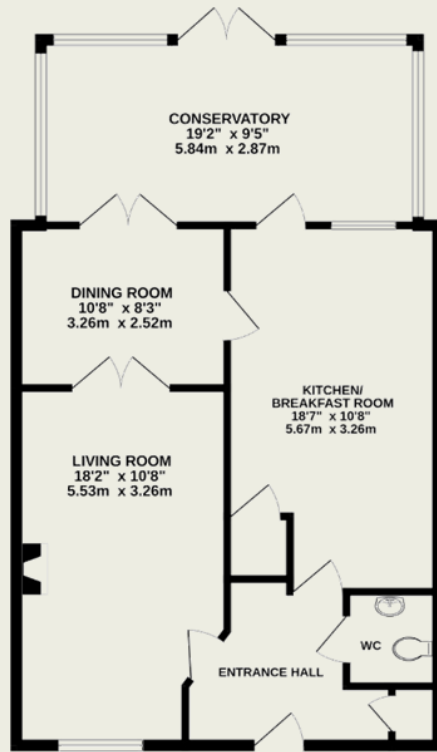

GROUND FLOOR
1027 sq.ft. (95.4 sq.m.) approx.

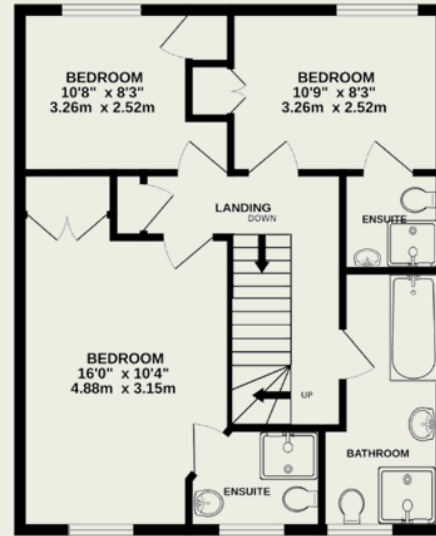

1ST FLOOR
565 sq.ft. (52.5 sq.m.) approx.



2ND FLOOR
447 sq.ft. (41.5 sq.m.) approx.

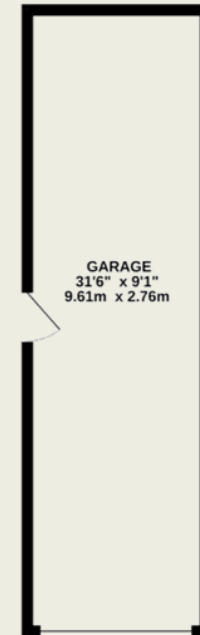

TOTAL FLOOR AREA : 2038 sq.ft. (189.4 sq.m.) approx.

This floorplan is for illustrative purposes only. The measurement and position of each element is approximate and must be viewed as such.