

Mimram Road,
Welwyn, AL6

 2 Double Bedrooms

 1 Shower Room

 1 Reception Room

 On Street Parking

 Private Courtyard Style
Garden

 EPC Band C

Council Tax
Band: D – £2,371.27 (2025-2026)

Guide Price
£475,000 Freehold

 **ashtons**
for life's great moves



A beautifully renovated, immaculately presented, characterful home located in the centre of the very desirable village of Welwyn.

Description

An exciting opportunity to acquire a characterful home which has been lovingly restored by the current owners to a very high standard, including high-end double-glazed sash windows, in keeping with the home's traditional charm and style. A cosy living room boasts a characterful feature wall with an attractive, traditional gas fireplace, flanked by fitted cupboards and deep shelving. The spacious, stylish kitchen/dining room lies beyond and benefits from beautiful Quartz worktops, high-end fitted appliances and smart, deep storage beneath the staircase. A charming, private courtyard garden, with outside tap and power sockets, is accessed via a door at the foot of the staircase. Upstairs, the largest double bedroom at the front of the house boasts deep, fitted wardrobes along the entire length of one wall. A second, especially bright double bedroom at the rear also benefits from stylish fitted wardrobes and a deep cupboard over the staircase provides further storage too. Uniquely, a large, remote-controlled skylight provides ventilation for the stylish, fully-tiled, spacious shower room with underfloor heating, as well as flooding the room with natural light.

Location

Mimram Road is located off of the high street in the very centre of Welwyn Village. The village amenities, including Tesco Express, doctors surgery, dentist, a range of independent shops, pubs and eateries are all just a short stroll away. More extensive facilities, including secondary schooling and mainline rail services can be found in Welwyn Garden City,

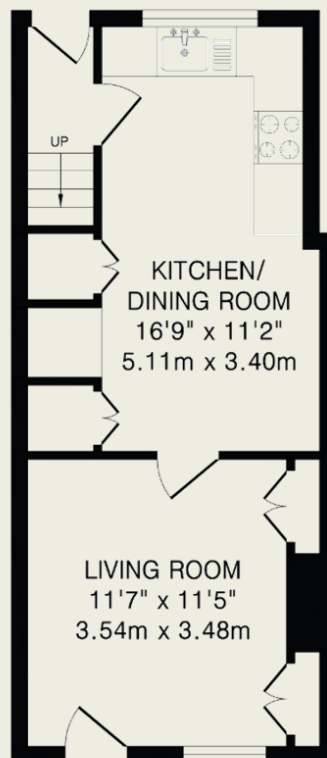

Ground Floor
327 sq.ft.(30.3 sq.m)approx.

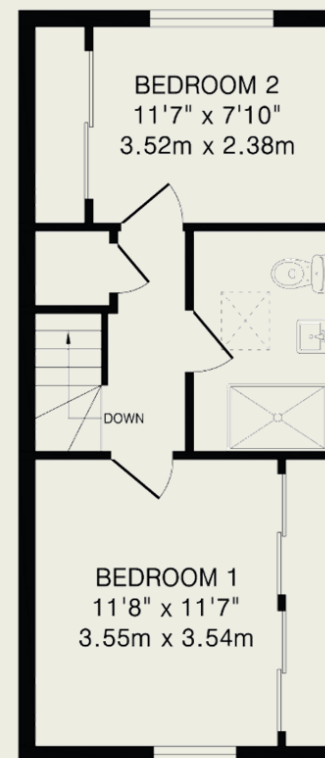

First Floor
333 sq.ft.(30.9 sq.m)approx.

TOTAL FLOOR AREA: 660 sq.ft.(61.2 sq.m)approx.

This floorplan is for illustration purposes only. The measurements and position of each element are approximate and must be viewed as such.

Important Information

These particulars do not constitute an offer or contract in whole or part. The statements contained herein are made without responsibility on the part of Ashtons or the vendors and they cannot be relied upon as representatives of fact. In respect of floor plans, these are for illustrative purposes only. The measurement and position of each element is approximate and must be viewed as such. Intending purchasers should therefore satisfy themselves by inspection or otherwise as to their correctness. The vendors do not make or give, and neither Ashtons nor any person in their employment has any authority to make or give, any representation or warranty whatsoever in relation to this property.

We offer a wide range of services through third-party providers including solicitors, surveyors, removal firms, mortgage providers and EPC suppliers. We receive additional payments for administering suppliers quoting software and making referrals. You are not under any obligation to use these services and it is your discretion whether you choose to deal with these parties or your own preferred supplier. You should be aware the average payment we received in 2021 equated to £48.36 per referral.