



3 Bedrooms



3 Bath/Shower Room + WC



4 Reception Rooms



Garage + Off-Street
Parking



0.5 Acre approx.



EPC Band E

Council Tax

Band: G £3,952.12 (2025-2026)

Local Authority
Welwyn Hatfield Borough
Council



The Avenue, Welwyn, AL6 0PP
Guide Price £1,100,000 Freehold

The Avenue, Welwyn, AL6 0PP

Accessed via a private gated driveway and set within beautifully landscaped gardens, this exceptional detached bungalow offers spacious, thoughtfully designed accommodation finished to an impressive and exacting standard throughout.

Description

Combining timeless elegance with modern comfort and complete privacy, this outstanding detached bungalow is a true gem for those seeking luxurious single-level living. Tucked behind electronically operated gates, the property is introduced by an impressive sweeping block-paved driveway, setting the tone for the quality found throughout. Inside, an inviting reception hallway flows through to a spacious dining room and a formal sitting room, complete with two sets of French doors onto the garden and a striking brick-built fireplace and wood-burning stove - perfect for relaxed evenings. An open-plan sunroom with a dedicated study area benefits from underfloor heating and air conditioning, creating a versatile, light-filled space to enjoy year-round. A sleek, modern cloakroom adds further convenience. At the heart of the home and with French doors opening onto the garden lies a beautifully fitted 'Moben' kitchen/breakfast room, featuring Quartz worktops and a premium Rangemaster cooker - ideal for entertaining and everyday living. This leads into a well-equipped utility room. The bungalow offers three generously proportioned double bedrooms, each with its own en-suite facilities. The principal suite is a true retreat, featuring air conditioning and a spacious, luxuriously appointed en-suite bathroom fitted with a four-piece suite including a roll-top bath. Externally, the home continues to impress with a double garage, formal lawns, and meticulously landscaped gardens that wrap around the property. Offering exceptional seclusion, the grounds are immaculately maintained and perfectly frame this magnificent home.

Location

The property is located on a private road in the highly regarded Oaklands area of Welwyn. Oaklands itself benefits from a renowned local primary school, parade of shops for day to day needs, public house and a regular bus service to both Stevenage and Welwyn Garden City town centres. Mainline rail services can be found at either Knebworth, Welwyn North (Digswell) or Welwyn Garden City centres and more extensive leisure, schooling and shopping facilities can be found a short bus/car ride away in Welwyn Garden City and Stevenage.





Important Information

These particulars do not constitute an offer or contract in whole or part. The statements contained herein are made without responsibility on the part of Ashtons or the vendors and they cannot be relied upon as representatives of fact. In respect of floor plans, these are for illustrative purposes only. The measurement and position of each element is approximate and must be viewed as such. Intending purchasers should therefore satisfy themselves by inspection or otherwise as to their correctness. The vendors do not make or give, and neither Ashtons nor any person in their employment has any authority to make or give, any representation or warranty whatsoever in relation to this property. We offer a wide range of services through third party providers including solicitors, surveyors, removal firms, mortgage providers and EPC suppliers. We receive additional payments for administering suppliers quoting software and making referrals. You are not under any obligations to use these services and it is your discretion whether you choose to deal with these parties or your own preferred supplier. You should be aware the average payment we received in 2021 equated to £48.36 per referral.

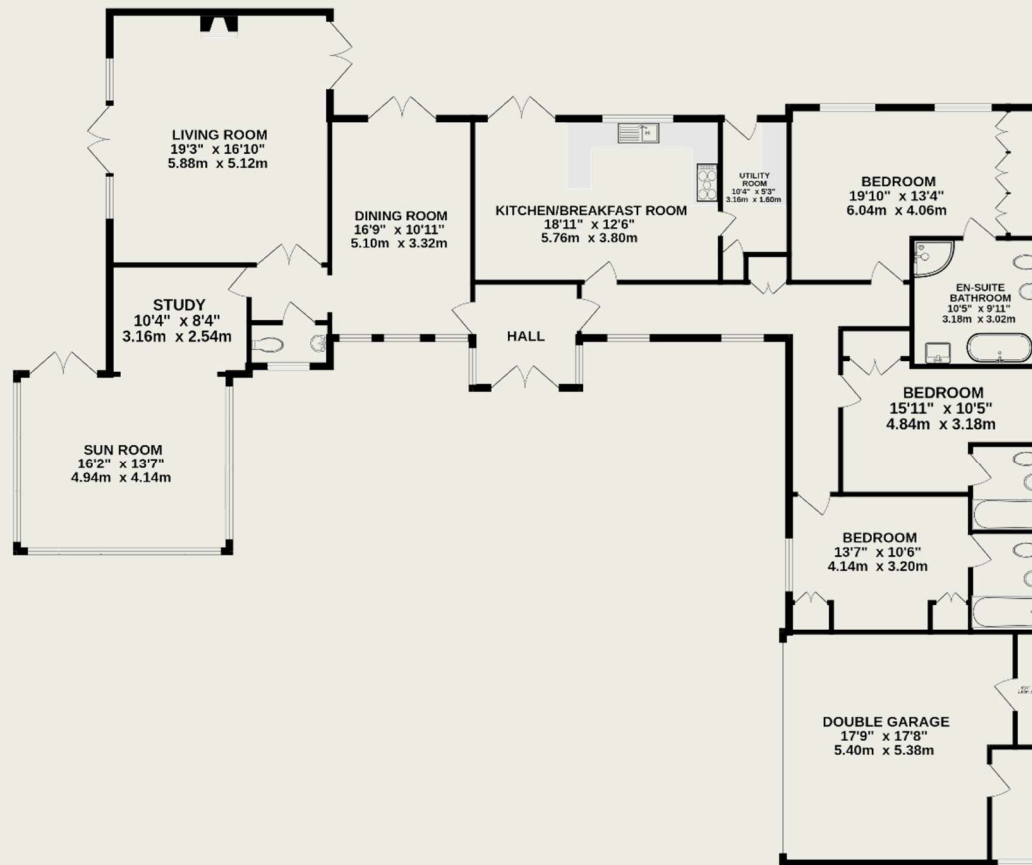

TOTAL FLOOR AREA: 2445 sq.ft (227.2 sq.m.) approx.

*This is a guide only and does not constitute an offer. The dimensions are approximate and may vary slightly from the actual measurements. The floor plan is for information only and is not to be used as a basis for any legal proceedings.