



4 Bedrooms



1 Bath/Shower Room  
1 Cloakroom



1 Reception Rooms



Garage and Drive



South Facing Rear Garden



EPC Band E

Council Tax

Band F  
- £3,621.23 2025-2026

Local Authority  
East Hertfordshire District  
Council



**King Edwards Road, Ware, Hertfordshire, SG12**  
**Guide Price £700,000.00 Freehold**



# King Edwards Road, Ware, Hertfordshire, SG12

Rarely available detached family home conveniently situated within a short walk of the town centre and station. Offered chain free.

🏡	Detached Chalet Style Family Home
🏡	Large Living/Dining Room
🏡	Fitted Kitchen Overlooking Rear Garden
🏡	Downstairs Cloakroom
🏡	Modern Bathroom with Separate Shower Cubicle
🏡	No Onward Chain
🏡	Short Walk to Town Centre & Station

## Description

This detached chalet style home offers well proportioned accommodation that has been the subject of refurbishment in certain areas with some rooms still requiring some cosmetic updating, as highlighted.

On the ground floor the entrance porch has a cloakroom off which requires replacement and there is a large, dual aspect, open plan lounge diner which is flooded with light. The fitted kitchen benefits from a double oven and hob, dishwasher and fridge/freezer overlooking the rear garden.

Upstairs there are 4 bedrooms (one having been redecorated) and they are served by a newly fitted bathroom with a separate shower cubicle.

Gas heating serves radiators and double glazing is fitted.

Externally there is a driveway and a single garage, along with a south facing rear garden.

## Location

The property is perfectly placed in this quiet turning within a short walk of the town centres amenities including independant shops, Tesco supermarket and numerous bars and restaurants.

For the commuter, Ware railway station offers fast and frequent services to Liverpool Street.





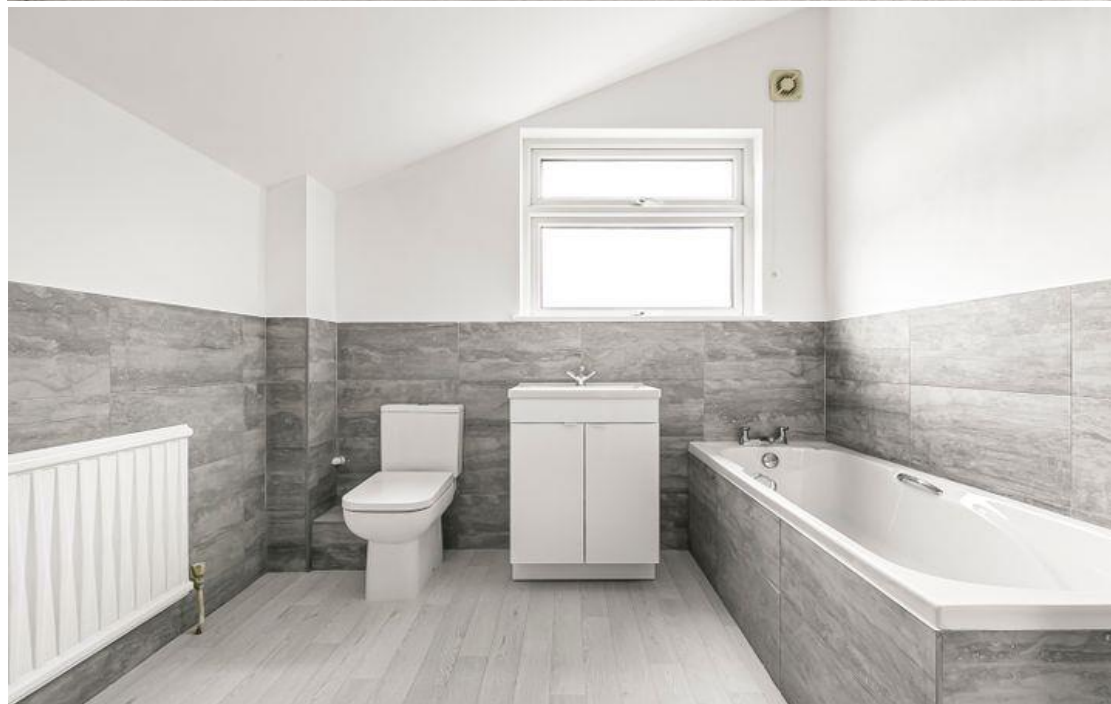

**Important Information**

These particulars do not constitute an offer or contract in whole or part. The statements contained herein are made without responsibility on the part of Ashtons or the vendors and they cannot be relied upon as representatives of fact. In respect of floor plans, these are for illustrative purposes only. The measurement and position of each element is approximate and must be viewed as such. Intending purchasers should therefore satisfy themselves by inspection or otherwise as to their correctness. The vendors do not make or give, and neither Ashtons nor any person in their employment has any authority to make or give, any representation or warranty whatsoever in relation to this property. We offer a wide range of services through third party providers including solicitors, surveyors, removal firms, mortgage providers and EPC suppliers. We receive additional payments for administering suppliers quoting software and making referrals. You are not under any obligations to use these services and it is your discretion whether you choose to deal with these parties or your own preferred supplier. You should be aware the average payment we received in 2021 equated to £48.36 per referral.

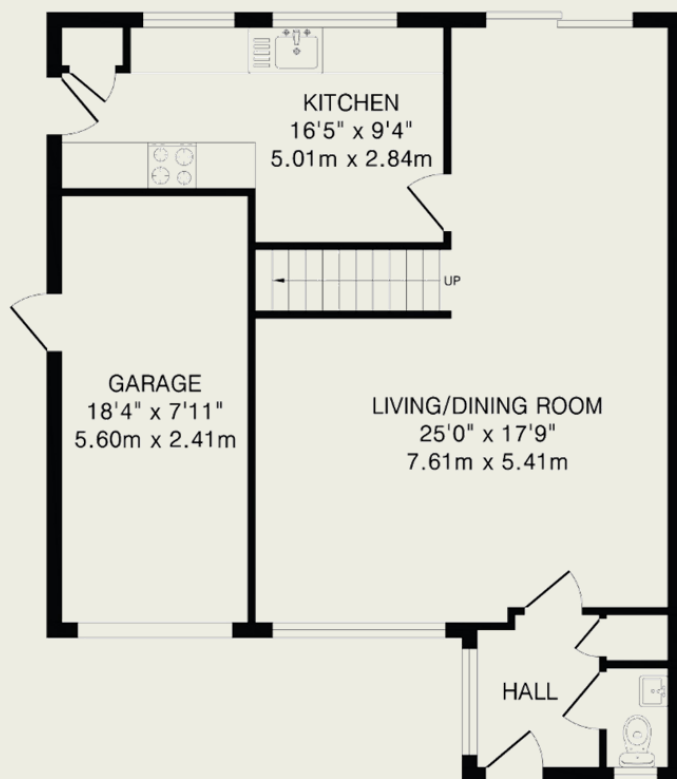

Ground Floor  
719 sq.ft.(66.8 sq.m)approx.

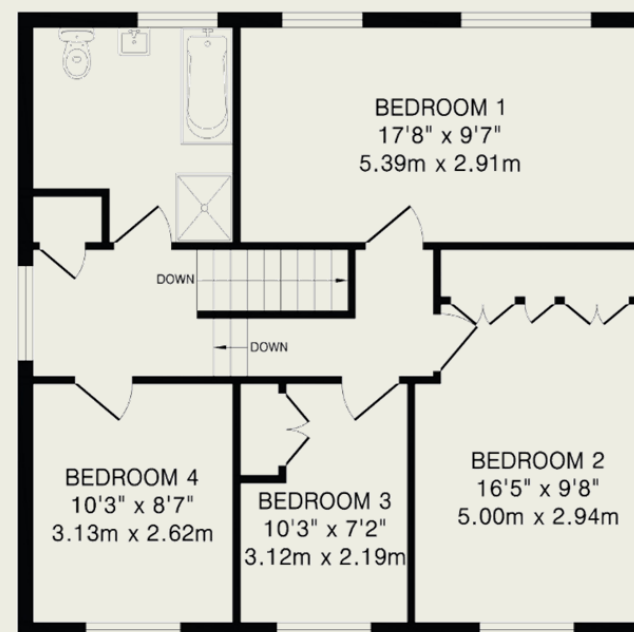

First Floor  
668 sq.ft.(62.0 sq.m)approx.

TOTAL FLOOR AREA: 1387 sq.ft.(128.8 sq.m)approx.  
This floorplan is for illustration purposes only. The measurements and position of each element are approximate and must be viewed as such.