



3 Bedrooms



1 Bathroom



1 Reception Rooms



Garage en Bloc



Rear Garden



EPC Band D

Council Tax

Band D: £2,340.09 2025/26

Local Authority
Dacorum Council



The Close, Markyate, St Albans, AL5 8NG
Guide Price £400,000

The Close, Markyate, St Albans, AL3

Excellent three bedroom semi-detached village home with garage and private garden offered chain free, well located just a short stroll from the High Street and amenities in this popular village.

🏡	Three bedroom village home
🏡	Popular Location close to amenities
🏡	Large living room
🏡	Modern kitchen and upstairs bathroom
🏡	Potential to extend to the side (subject to planning permission)
🏡	Garage en bloc and private rear garden
🏡	Offered chain free with vacant possession

Description

This three bedroom home offers spacious accommodation and is in need of some updating but is located close to village amenities and within easy reach of excellent transport links. The property has potential to extend to the side (Subject to the necessary consents).

To the front of the property is a large kitchen which has a good range of units and breakfast bar. A large living room sits to the rear with sliding patio doors leading out to the garden. Upstairs there are three bedrooms (two doubles and a single), served by a family bathroom with three-piece suite.

Outside the rear garden is a good size and is fully enclosed with patio seating area and steps up to a lawn. The property also has the benefit of a garage en bloc.

Location

The close is a convenient location situated close to Markyate High Street which provides for everyday needs including local pubs and a range of shops and restaurants. The highly regarded village Infant and junior school is also just a short walk away. Peggy's Field play ground is also nearby. The larger towns of Harpenden and St Albans offer fast and efficient rail links into London. M1 Junction 9 and London Luton airport are also within easy reach.





Important Information

These particulars do not constitute an offer or contract in whole or part. The statements contained herein are made without responsibility on the part of Ashtons or the vendors and they cannot be relied upon as representatives of fact. In respect of floor plans, these are for illustrative purposes only. The measurement and position of each element is approximate and must be viewed as such. Intending purchasers should therefore satisfy themselves by inspection or otherwise as to their correctness. The vendors do not make or give, and neither Ashtons nor any person in their employment has any authority to make or give, any representation or warranty whatsoever in relation to this property. We offer a wide range of services through third party providers including solicitors, surveyors, removal firms, mortgage providers and EPC suppliers. We receive additional payments for administering suppliers quoting software and making referrals. You are not under any obligations to use these services and it is your discretion whether you choose to deal with these parties or your own preferred supplier. You should be aware the average payment we received in 2021 equated to £48.36 per referral.

GROUND FLOOR
40.4 sq.m. (435 sq.ft.) approx.

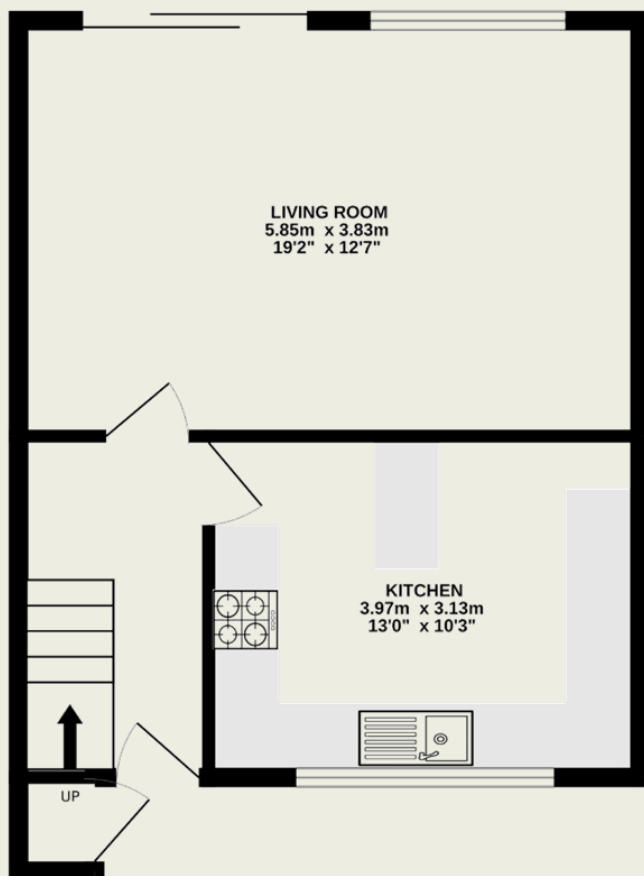

1ST FLOOR
39.7 sq.m. (427 sq.ft.) approx.

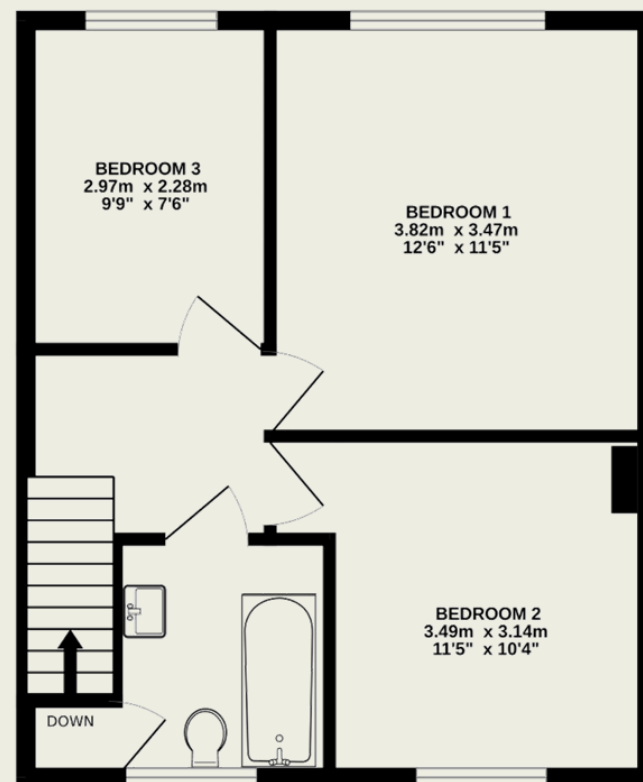

TOTAL FLOOR AREA : 80.1 sq.m. (862 sq.ft.) approx.

This floorplan is for illustrative purposes only. The measurement and position of each element is approximate and must be viewed as such.