



Graham Mansions, Lansbury Avenue, Barking, Essex
£250,000

 **YOUR MOVE**
Glenwood



IMPORTANT NOTE TO PURCHASERS: We endeavour to make our sales particulars accurate and reliable, however, they do not constitute or form part of an offer or any contract and none is to be relied upon as statements of representation or fact. The services, systems and appliances listed in this specification have not been tested by us and no guarantee as to their operating ability or efficiency is given. All measurements have been taken as guide to prospective buyers only, and are not precise. Floor plans where included are not to scale and accuracy is not guaranteed. If you require clarification or further information on any points, please contact us, especially if you are travelling some distance to view. Fixtures and fittings other than those mentioned are to be agreed with the seller.



Description

Your Move Glenwood estate agents are pleased to offer for sale this two bedroom second floor flat in Barking. The property comprises: 13ft reception room, 11ft kitchen, 13ft bedroom, 10ft bedroom, 7ft bathroom, and a separate WC. The property also benefits from an approximately 104 year lease, a 9ft balcony, and an outside storage shed. EPC Rating- C. The property is located within approximately 0.3 miles to Upney Station (District Line).

Council Tax

The Council Tax Band is B.

EPC

Second Floor Flat

For full EPC please contact the branch.

Approximate Area = 64.8 sq m / 697 sq ft

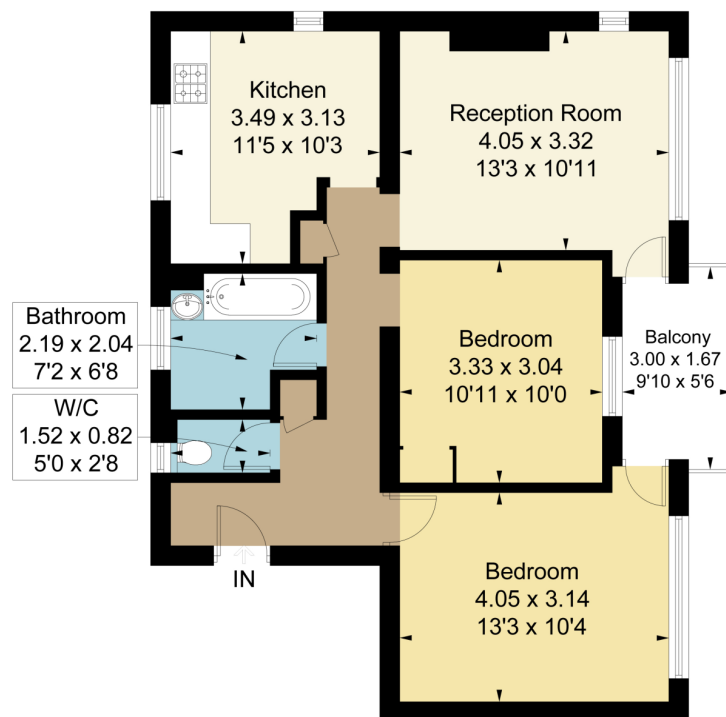

Second Floor

35 High Road, Romford, RM6 6QJ

0208 983 8449 * chadwellheath@your-move.co.uk



YOUR MOVE
Glenwood

your-move.co.uk