



Goldsborough, Wilnecote, Tamworth

Asking Price £185,000

- No Upward Chain
- Easy Access To Tamworth
- Ideal First Home Or Buy To Let
- Council Tax Band B
- Potential To Add Value
- Quiet Road
- Freehold
- Off Street Parking
- Good Access To Parks
- EPC Rating D

18 Goldsborough, Tamworth B77 4DE

Calders Residential are delighted to offer this two bedroom semi-detached home in Tamworth that is sold with no upward chain. This property offers a buyer a fantastic opportunity to add value to something and put their own stamp onto it and is situated towards the end of a private road with fantastic access onto local parkland.

In brief the property comprises an entrance hall, kitchen and a living room. To the first floor there are two bedrooms and a three piece bathroom. At the front of the property there is off street parking for two vehicles and to the rear there is a generous lawned garden with fenced boundaries.



Council Tax Band: B





Ground Floor

Approx. 23.8 sq. metres (256.1 sq. feet)

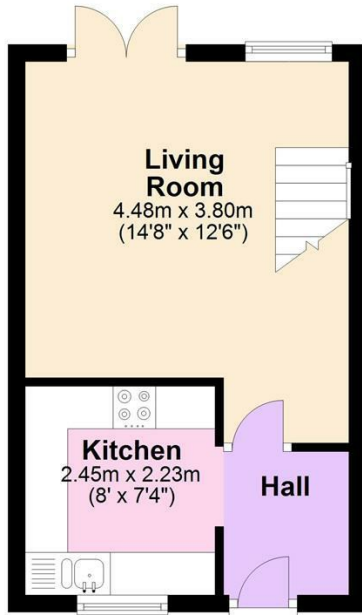

First Floor

Approx. 23.8 sq. metres (256.1 sq. feet)



Total area: approx. 47.6 sq. metres (512.2 sq. feet)

Where every attempt has been made to ensure the accuracy of the floor plan contained here, measurements of doors, windows, rooms and any other items are approximate and no responsibility is taken of any error, omission or mis-statement. This plan is for illustrative purposes only and should be used as such by any prospective purchaser.

Plan produced using PlanUp.

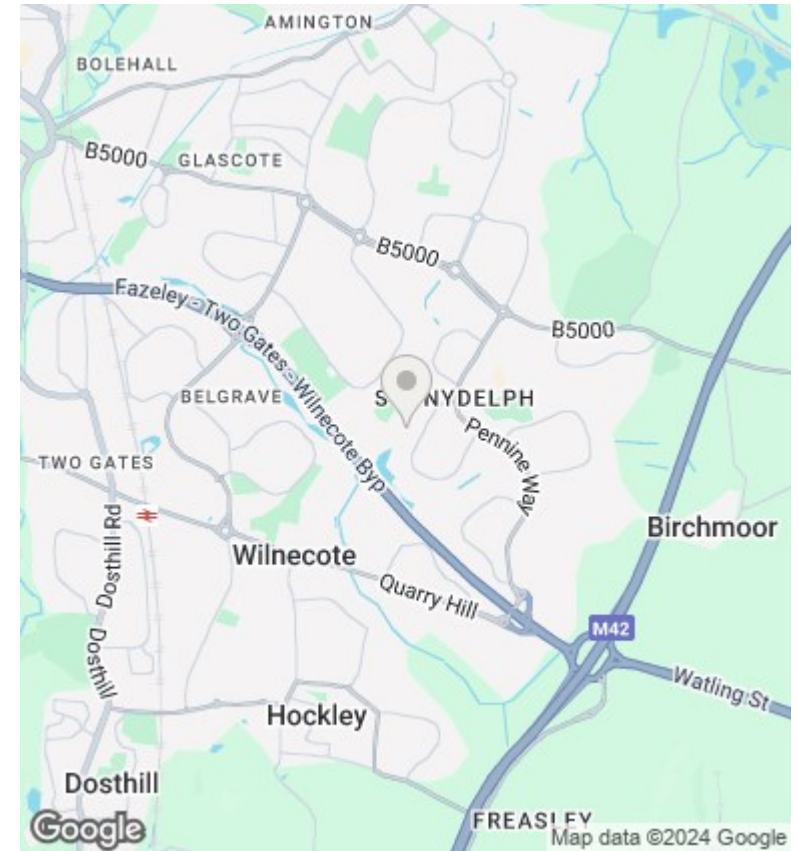

Viewings

Viewings by arrangement only. Call 01827 66686 to make an appointment.

Council Tax Band

B

Energy Efficiency Rating		
	Current	Potential
Very energy efficient - lower running costs		
(92 plus) A		
(81-91) B		
(69-80) C		
(55-68) D		
(39-54) E		
(21-38) F		
(1-20) G		
Not energy efficient - higher running costs		
	65	72
England & Wales	EU Directive 2002/91/EC	