



Withersfield Road, Haverhill, CB9 9HF

Rent - £1,150 PCM Deposit - £1,326

Balmforth Haverhill are delighted to offer to let this charming two bedrooms character property located within a stones throw of the Town Centre. The property has accommodation to include lounge, open plan kitchen/diner and downstairs wc. On the first floor is two bedrooms with family bathroom. Off street parking and low maintenance rear garden. Available NOW.

- TWO BEDROOMS
- OPEN PLAN KITCHEN/DINER
- FAMILY BATHROOM
- OFF STREET PARKING
- AVAILABLE EARLY 2026
- CHARACTER PROPERTY
- LOUNGE + DOWNSTAIRS WC
- GARDEN
- GAS HEATING/EPC B
- CALL IN TO BOOK A VIEWING



Council Tax Band: B - EPC Rating: null

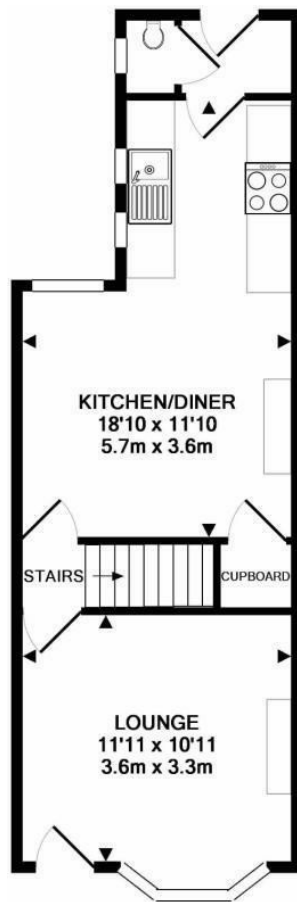

GROUND FLOOR
APPROX. FLOOR
AREA 383 SQ.FT.
(35.6 SQ.M.)



1ST FLOOR
APPROX. FLOOR
AREA 348 SQ.FT.
(32.3 SQ.M.)

TOTAL APPROX. FLOOR AREA 731 SQ.FT. (67.9 SQ.M.)

Whilst every attempt has been made to ensure the accuracy of the floor plan contained here, measurements of doors, windows, rooms and any other items are approximate and no responsibility is taken for any error, omission, or mis-statement. This plan is for illustrative purposes only and should be used as such by any prospective purchaser. The services, systems and appliances shown have not been tested and no guarantee as to their operability or efficiency can be given

Made with Metropix ©2019

