



## Rutherford Place, Haverhill, CB9 7SY

**Rent - £1,400 PCM      Deposit - £1,615**

Located on the popular Arboretum development, this well presented three bedroom end of terrace home, offers accommodation comprising of entrance hall, cloakroom, lounge, kitchen/diner, family bathroom and en-suite to the main bedroom. There is off-road parking for two vehicles in addition to a pleasant front, side and rear gardens. Available early 2026.

- CAMBRIDGE SIDE OF TOWN
- ENTRANCE HALL/CLOCKROOM/KITCHEN-DINER
- ENCLOSED REAR GARDEN
- GAS CENTRAL HEATING
- COUNCIL TAX BAND C/EPC B
- MODERN 3 BED END OF TERRACE
- LIVING ROOM/3 BEDROOMS/ FAMILY BATHROOM/EN-SUITE
- PARKING FOR 2 CARS
- AVAILABLE EARLY 2026
- CALL IN TO BOOK A VIEWING!



Council Tax Band: C - EPC Rating: B 83



## Ground Floor

Approx. 42.0 sq. metres (452.5 sq. feet)

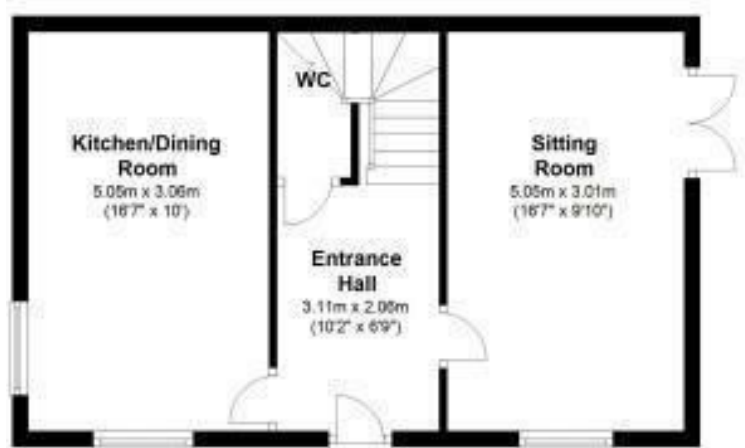

## First Floor

Approx. 42.0 sq. metres (452.1 sq. feet)

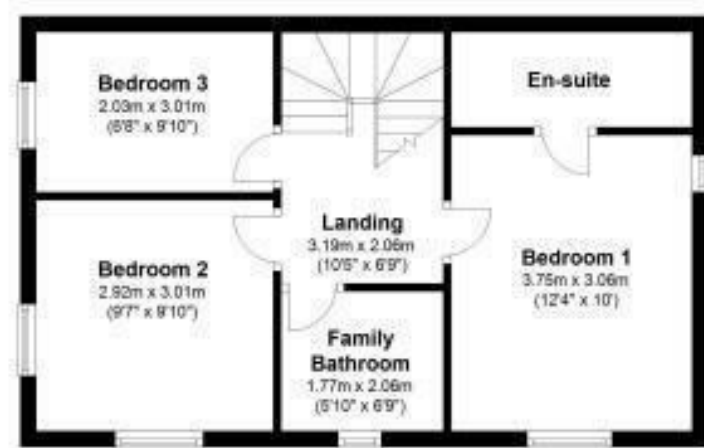

Total area: approx. 84.0 sq. metres (904.6 sq. feet)

